

# PIONEER --- CONNECT

JULY 22, 2017

**I WONDER  
WHAT  
THE BIBLE  
SAYS  
ABOUT  
\_\_\_\_\_?**



# WELCOME

*to Pioneer*

Whether the rain pulled you away from the outdoors, a curiosity about what happens inside these church doors pulled you in, or you are part of our church family, welcome to Pioneer Memorial Church. Summer—we've been in this season for a month already. Before you know it, leaves will dance off the trees and snow will cover these beautifully manicured lawns. But let's not say adieu just yet!

In a similar way, life also has its seasons. As you engage in this community today, just know that whatever weather is outside, inside, the season of the heart can vary from person to person. Say hello, it may be the sun sneaking through someone's cloud. If you are new here, you may hear people greet each other with "Happy Sabbath" (the name given this day in the Bible). It's one of the ways we try to encourage each other; feel free to use it yourself!

—José Bourget



## PIONEER MEMORIAL CHURCH

8655 UNIVERSITY BOULEVARD, BERRIEN SPRINGS, MI 49103

### OFFICE HOURS

Monday – Thursday (8 to 5) • Friday (8 to 12)

**PHONE** – 269.471.3133

**FAX** – 269.471.6152

### LIVE STREAMING

[www.pmchurch.org](http://www.pmchurch.org)  
Sabbath 11:45 AM

### ONLINE

[www.pmchurch.org](http://www.pmchurch.org)  
[www.newperceptions.tv](http://www.newperceptions.tv)

### RADIO

WAUS – 90.7 FM  
Sabbath 11:30 AM



### NOMINATING REPORT

Scan this code to view the most recent Nominating Committee Report.



### FIND A SABBATH SCHOOL

# FIND IT HERE

CONNECT • GROW • SERVE • GO



**4**

## PIONEER LIFE

How We Work Together  
for Student Success

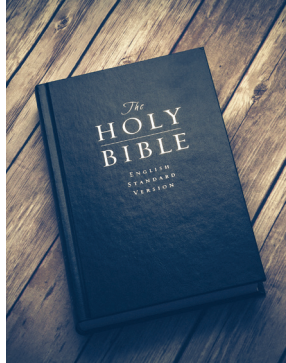

**8**

## SABBATH SCHOOL-

Justification by Faith Alone

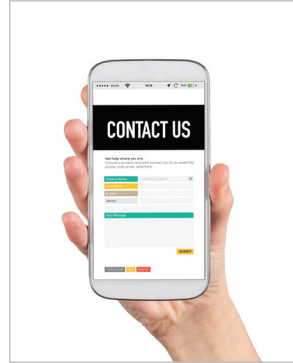

**12**

## MEMBERSHIP TRANSFERS

**6**

## WE WORSHIP

9:00 AM Service

**9**

## WE WORSHIP 2

11:45 AM Service

**13**

## CONTACTS

**10**

## ANNOUNCEMENTS

**14**

## SABBATH SCHOOL DIRECTORY

# HOW WE WORK TOGETHER FOR STUDENT SUCCESS

BY STEVEN ATKINS

**D**uring the spring and summer months many families are making plans for Seventh-day Adventist education at Andrews Academy (AA). Families value this education but also have to confront the realities of financial constraints. Many step out in faith as they choose Andrews Academy and pray for God's blessing on their financial dilemma. Your gifts make these decisions to attend AA a reality.

We thank the Pioneer Memorial Church family for their prayers and financial support of Christian education at Andrews Academy. Numerous students who could not afford AA can attend and be blessed by what it has to offer because of your generosity. Being at AA for 25 years, I have had the opportunity to see the end product of Adventist education when alumni return to visit. Many are teachers, pastors, medical professionals, financial professionals, etc., with numerous alumni working for the church. Working for the church or in public employment many tell of the ways God has led in their lives and how God can use their profession to lead others to Jesus. A lot retell the stories of how AA has impacted

their lives to help them become the individuals they are today.

I read more of these life-changing stories while grading senior portfolios. During their four years at AA, students create a portfolio to illustrate their strengths as an individual, documenting the four major components of Adventist education: spiritual, physical, social, and academic. Working on their portfolio helps them to see if they are properly developing in each component.

One page of this portfolio is their autobiographical sketch, in which they describe the factors that influence how they became the individual they are today. It's so

interesting to read these sketches and learn of the impact that AA has had on their lives. The following are portions from different senior portfolios:

---

**I HAVE HAD THE OPPORTUNITY TO SEE THE END PRODUCT OF ADVENTIST EDUCATION . . .**

---

"Before I came to America, I did not even know about Seventh-day Adventists . . . nor have a

knowledge about God. . . I started out in Ruth Murdoch Elementary that first taught me the foundation of God. . . Andrews Academy was a great place to get me involved. Activities such as vespers, weeks of prayer, Bible camp, SA campout and many



more things inspired me to get closer with God and know more about Him."

"At Andrews Academy I not only grew scholastically but also spiritually. I love how the teachers not only care about getting their lesson taught but they personally care about every student. That one aspect of the love at AA built my character. The genuine love and kindness made me realize that I want to spend my life helping people and showing kindness."

"Andrews Academy has taught me so much, not only scholastically, but also about life and the challenges that come with it. The teachers there have helped me grow into the man I am today. They have brought me much closer in my spiritual journey. The knowledge and wisdom I have gained from these teachers is something I could never have gotten anywhere else."

Please continue to keep Andrews Academy in your prayers, especially during the summer months as families make decisions for AA and as we plan for this upcoming school year. If you know a high-school-aged student in the area please reach out to them and encourage them to attend AA. Have them go to [www.andrews.edu/aa/](http://www.andrews.edu/aa/) for more information about AA and click on "apply now" for the online application. ■

*Steven Atkins is the Biology & Earth Science teacher at Andrews Academy.*

### **SUPPORT THIS MINISTRY**

Please indicate  
"Christian Education"  
on your tithe envelope.



# WE WORSHIP

CONNECT • GROW • SERVE • GO

## Opening Voluntary

*Festive Trumpet Tune • David German*

## Introit

*Amazing Grace, How Sweet the Sound • Anonymous Melody*

## Call to Worship

José Bourget

If we come near to God, he will come near to us.

**If we humble ourselves before the Lord, he will lift us up.**

For the Lord is full of compassion, slow to anger, and rich in love. He does not treat us as our sins deserve or repay us according to our iniquities.

**For all our sins, O Lord, forgive us.**

## Doxology

*Praise God, From Whom All Blessings Flow • 2*

## Invocation

Sabine Vatel

## Hymn of Praise

*Praise, My Soul, the King of Heaven • 4*

## Congregational Prayer

José Bourget  
*Lord, Speak to Me • st. 1 of 541*

## Worship in Music

*Absalom • Traditional Melody*

## Tithes & Offerings

Michigan Advance Partners  
*City Called Heaven • Calvin Taylor*

## Children's Story

Sabine Vatel

## Scripture

Psalm 103:11-14 NIV • Celesta Burt & Zackery Babb

For as high as the heavens are above the earth, so great is his love for those who fear him;

**as far as the east is from the west, so far has he removed our transgressions from us.**

As a father has compassion on his children, so the Lord has compassion on those who fear him;

**for he knows how we are formed, he remembers that we are dust.**

**Hymn of Preparation**

*Jesus! What a Friend for Sinners • st. 1 & 2 of 187*

**Sermon**

"I Wonder What the Bible Says About \_\_\_\_\_?" • Sabine Vatel

**Hymn of Commitment**

*Forgive Our Sins, As We Forgive • 299, melody of 108*

**Benediction**

**Closing Voluntary**

*Toccata • Eugène Gigout*

PRESIDING PASTOR: José Bourget; ORGANIST: Joshua Goines  
WORSHIP IN MUSIC: Girls of Mercy; Josephine Katenga, director

---

# MUSIC ALIVE

## MOVING HYMN, STRIDING MELODY

"Praise, My Soul, the King of Heaven," has a melody by John Goss, organist at a majestic cathedral from 1838 to 1872. Goss emblazoned many of his compositions with initials "I. N. D. A.", signifying Latin for "In God's Name. Amen." The hymn's moving text is a fitting complement to the striding melody. It is Henry Lyte's stirring

poetical interpretation of Psalm 103, strong words from a poet said to have been "never of robust health" and who suffered from asthma and tuberculosis in late life. Curiously, Lyte wrote many of his hymn texts in a house given to him by King William IV, apparently in gratitude for the reception accorded the King on a visit to Lyte's church! ■

# WE STUDY

CONNECT • GROW • SERVE • GO

**Song Service** Christina Carroll

**Opening Song** *What a Wonderful Savior* • 335

**Scripture & Prayer** Estrellita Shimray

**Welcome** Melchizedek Ponniah

**Mission Feature**

**Offertory** *I Heard the Voice of Jesus Say* • arr. Gabriel Palacios

**Bible Study** "Justification by Faith Alone" • Classes

**Theme Song** *Make Me a Blessing*

Make me a blessing; make me a blessing.  
Out of my life may Jesus shine.  
Make me a blessing; O Savior, I pray.  
Make me a blessing; to someone today.

"Make Me a Blessing," Ira Bishop Wilson  
©1924, Renewed 1952 Word Music, LLC; Used by Permission. CCLI License #392652

**Benediction** Christina Carroll

ORGANIST: Joshua Goines  
OFFERTORY: Gabriel Palacios, piano



# WE WORSHIP 2

CONNECT • GROW • SERVE • GO

## **As We Begin**

*Festive Trumpet Tune • David German*

## **Praise**

*How Great Is Our God • How He Loves • Oceans (Where Feet May Fail)*

## **Prayer**

José Bourget

## **Tithes & Offerings**

*City Called Heaven • Calvin Taylor*

## **Children's Story**

## **Worship in Music**

*Absalom • Traditional Melody*

## **Sermon**

"I Wonder What the Bible Says About \_\_\_\_\_?"

Sabine Vatel

## **Connect Card**

*Forgive Our Sins, As We Forgive • 299, melody of 108*

## **As We Depart**

*Toccata • Eugène Gigout*

WORSHIP COORDINATOR: José Bourget; ORGAN: Joshua Goines

ACOUSTIC GUITAR: Mariesa Tinkham; PIANO: Joshua Goines

VOCALS: Jamila Sylvester, Mariesa Tinkham, Medgine Picard, Sinégugu Katenga

WORSHIP IN MUSIC: Girls of Mercy; Josephine Katenga, director

**SUBMIT** announcements by emailing [bulletin@pmchurch.org](mailto:bulletin@pmchurch.org) or by going to [www.pmchurch.org/announcements/submit](http://www.pmchurch.org/announcements/submit). Requests must be received **Monday by 5:00 PM** for consideration.

**NEXT WEEK'S OFFERING**  
Good News Farm

**SUNSET TODAY • 9:15**  
**SUNSET NEXT FRIDAY • 9:09**

## PIONEER PULPIT

| 07 • 29 |

**BEN MARTIN**

"I Wonder What the Bible Says About  
\_\_\_\_\_?"

| 08 • 05 |

**JOHN WESLEY TAYLOR V**

AU Baccalaureate

## FINANCIAL FEATURE

### MICHIGAN ADVANCE PARTNERS

Do you remember attending summer camp when you were a kid? Do you remember meeting new friends and making fun memories? Many kids are making similar memories this summer at camps in Michigan. They are having fun riding horses, singing camp songs, wakeboarding, tubing, playing on the blob, rock climbing and most importantly learning about Jesus. Support the Michigan Advanced Partners with today's offering and ensure that many more kids are able to learn about Jesus and make lifelong memories at summer camps in Michigan.

### Fellowship After Church

The Family Life and Safety Committees invite you to join us today, following the 11:45 AM service, outside on the lawn for a brief time of fellowship. Cookies and juice will be provided.

### Family Vespers

TODAY • 8:00 PM  
YOUTH CHAPEL

Come and receive a blessing as we praise God at the close of this Sabbath.

### Hymn Sing

TODAY • 6:00 TO 7:00 PM  
THE OLD RUGGED CROSS CHURCH  
(61041 VERMONT ST., POKAGON, MI)

You are invited to join us for a hymn sing. We'll be singing your favorites from the *Christ in Song* hymnal. If you have one or more copies of the *Christ in Song* hymnal, please bring them along to share with others. A tour of the historic site and a short film on the story behind the hymn "The Old Rugged Cross" will follow immediately after the hymn sing. For more information, contact Melchizedek Ponniah (269.876.7476 or [melponniah@gmail.com](mailto:melponniah@gmail.com)).

## Summer Exercise Classes

NOW THROUGH JULY 27

### H2OFit

*Tuesdays & Thursdays • 7:30-8:15 AM  
Beaty Pool at Johnson Gym*

### ToBoFit

*Tuesdays & Thursdays • 5:00-5:50 PM  
Lamson Hall Health Club*

These FREE classes are part PMC's Health Ministry and are open to anyone 18 years and older. If you have questions please contact Kathy Koudele ([kathy.koudele@pmchurch.org](mailto:kathy.koudele@pmchurch.org)).

## Stuff-a-Bus with School Supplies

JULY 28 • 4:00 TO 7:00 PM  
APPLE VALLEY PARKING LOT

For the third year, Backpacks for Berrien, a community volunteer group, is collecting backpacks and school supplies for students who are in need of them and attend Berrien Springs public schools or parochial schools: Andrews Academy, Ruth Murdoch Elementary, Village SDA School, and Trinity Lutheran School. Some school supplies, including backpacks, are already on sale now. Even if you are unable to shop, please come to Stuff-a-Bus and give a donation. Monetary donations can be made that day from noon until 2 PM in the Apple Valley entrance. For more information contact Jane Thayer at [thayerja@andrews.edu](mailto:thayerja@andrews.edu) or 269.473.2516.

## RMES Work Bee

JULY 30 • 8:00 AM TO 3:00 PM  
RUTH MURDOCH ELEMENTARY  
SCHOOL

Parents, volunteers, and supporters are invited to join us as we beautify our building and grounds for the new school year.

## Health Tent at Berrien County Youth Fair

Every year the local Adventist churches host the Health Tent at the Berrien County Youth Fair. Thousands of people visit during Fair Week (August 14-19 this year) to learn about healthful living. You can be part of it! Sign up for a time slot (or more) at [www.HealthTent.org](http://www.HealthTent.org). Learn more about the new format for the Health Tent on that site, and also how you can support it with your donations.

## District 9 Family Camp

SEPTEMBER 1-4  
CAMP AU SABLE

The annual District 9 Family Camp is just around the corner! Applications are available online at <http://districtnine.wix.com/> or at the PMC receptionist's desk for those who are unable to obtain them online. Completed applications may be submitted to Claudia Sowler beginning at noon on July 23. Reservations must be made by noon on Sunday, August 13. For questions, please contact Ric Streelman at 269.208.7172. Make your reservations as soon as possible. We look forward to seeing you there where you will be physically and spiritually blessed!

## FLAG Camp

NOW THROUGH AUGUST 3  
PATHFINDER BUILDING

FLAG Camp is a Christian day camp where children grades K-8 enjoy quality programs. Whether you plan to send your child every day, or just a day here and there throughout the summer, FLAG Camp is a great choice when it comes to affordable childcare. For registration or more info visit [www.pmchurch.org/flagcamp](http://www.pmchurch.org/flagcamp).

### Keeping Us Safe

Pioneer cares about your safety! Through your support, we recently were able to bring our fire alarm system up to code, featuring a building-wide paging system. Coming soon: better safety signage, more training, and a fire drill exercise before the fall semester begins.

### PMC Greeters Needed!

The PMC Greeter Team needs you with your warm smile and friendly "Welcome" to serve as a greeter. You are the first introduction to our worship on Sabbath. We have many openings. Contact Bonnie Perry by phone, text or e-mail (269.473.1005; 312.953.5871; [bperry@sbcsc.k12.in.us](mailto:bperry@sbcsc.k12.in.us)).

### Family Prayer Needs

If you have a prayer request or change to the Family Prayer Needs list, please contact the church clerk, Janna Quetz ([clerk@pmchurch.org](mailto:clerk@pmchurch.org), or call 471.3133).

### Get Our E-Letter!

Receive PMC's e-Letter, Pioneer Mid-week, for weekly updates about church life, events, and more! Subscribe today at [www.pmchurch.org/newsletter](http://www.pmchurch.org/newsletter).

### More Announcements

For more PMC and community announcements, please visit our website at [www.pmchurch.org/announcements](http://www.pmchurch.org/announcements).

## MEMBERSHIP TRANSFERS • FIRST READING

### | TRANSFERS IN |

OKIOMA, Ezra  
ZELAYA MARTINEZ, Gaddiel

### | FROM |

Nairobi Central SDA Church  
Asociación Paracentral Salvadoreña

### | TRANSFERS OUT |

ALGANDAR, AmadaSusana  
BENITEZ-CAMPOS, Grecia  
GOMEZ, Jamie  
OBINCHU, Fenades  
ROMAN, Raluca  
RUSK, Steven  
WHITE, Reuel

### | TO |

Spanish • Berrien Springs, MI  
Central Spanish • LA,CA  
Spanish • Berrien Springs, MI  
Dallas New Life • Richardson, TX  
Fuerth, Germany  
Marietta, GA  
Farmville, VA

## | PASTORS | | STAFF |

**Chaplain / Pioneer**

José Bourget • 471.6254  
bourget@pmchurch.org

**Admin. Assistant**

Lailane Legoh • 471.3543  
legoh@pmchurch.org

**Discipleship / GROW Groups**

Sabine Vatel • 471.6153  
vatel@pmchurch.org

**Admin. Assistant / Facilities / Clerk**

Janna Quetz • 471.3133  
quetz@pmchurch.org

**Harbor of Hope**

Taurus Montgomery • 269.210.6155  
montgomery@pmchurch.org

**Assistant Media Director**

Gaddiel Zelaya Martínez • 471.3678  
zelaya@pmchurch.org

**Lead Chaplain**

June Price • 471.6282  
juneprice@andrews.edu

**Assistant Treasurer**

JoAnn Siagian • 471.7656  
siagian@pmchurch.org

**Lead Pastor**

Dwight K. Nelson • 471.3134  
nelson@pmchurch.org

**Bible Work Coordinator**

Tabitha Umali • 471.3550  
umali@pmchurch.org

**Pastoral Care**

Don Dronen • 471.3133  
dronen@pmchurch.org

**Executive Assistant**

Claudia Sowler • 471.3134  
sowler@pmchurch.org

**Stewardship**

Sharon Terrell • 471.6151  
terrell@pmchurch.org

**Graphic Designer**

Rachelle Offenback • 471.3647  
bulletin@pmchurch.org

**This Generation Evangelism**

Rodlie Ortiz • 471.6154  
ortiz@pmchurch.org

**Maintenance**

Larry White • 471.3649  
white@pmchurch.org

**Youth Ministries**

Ben Martin • 471.6176  
martin@pmchurch.org

**Media Ministries**

Richard Parke • 471.3246  
parke@pmchurch.org

**Music**

Kenneth Logan • 471.3231  
logan@pmchurch.org

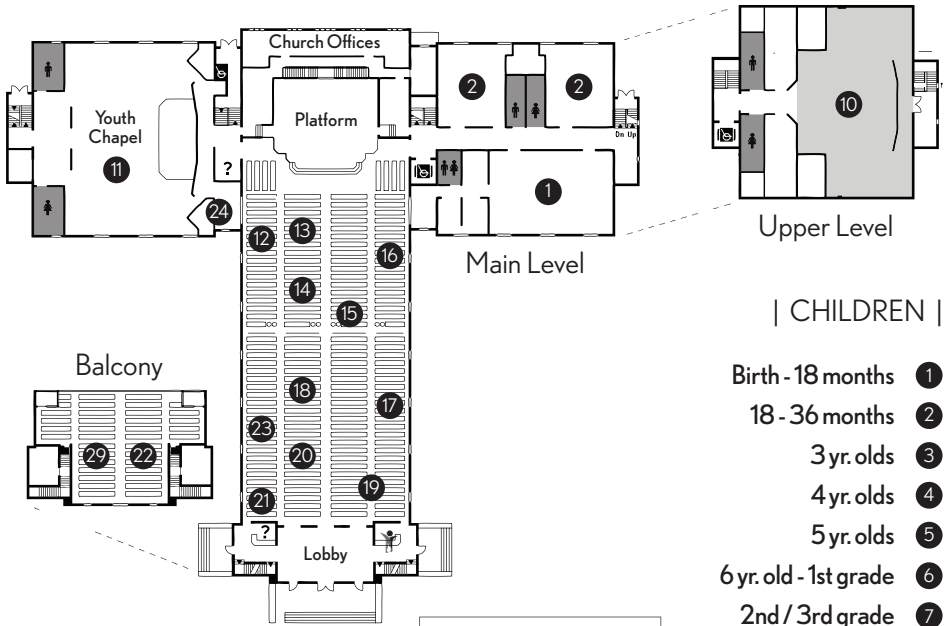

| CHILDREN |

- Birth - 18 months ①
- 18 - 36 months ②
- 3 yr. olds ③
- 4 yr. olds ④
- 5 yr. olds ⑤
- 6 yr. old - 1st grade ⑥
- 2nd / 3rd grade ⑦
- 4th grade ⑧
- 5th / 6th grade ⑨
- Earliteen ⑩
- Youth ⑪

| ADULT |

- ⑫ Group 1
- ⑬ Group 2 (Portuguese/Brazilian)
- ⑭ Group 3
- ⑮ Group 4 (Yugoslavian)
- ⑯ Group 5
- ⑰ Group 6
- ⑱ Group 7
- ⑲ Group 8
- ⑳ Group 9 (Spanish)
- ㉑ Group 10
- ㉒ Group 11 (Balcony)
- ㉓ Group 12 (French)
- ㉔ Conference Room
- ㉕ Something In Common
- ㉖ Young Adults
- ㉗ SDA Beliefs

| KEY |

- ? Welcome Centers
- Elevators
- Restrooms
- Children's Activities & Lending Library

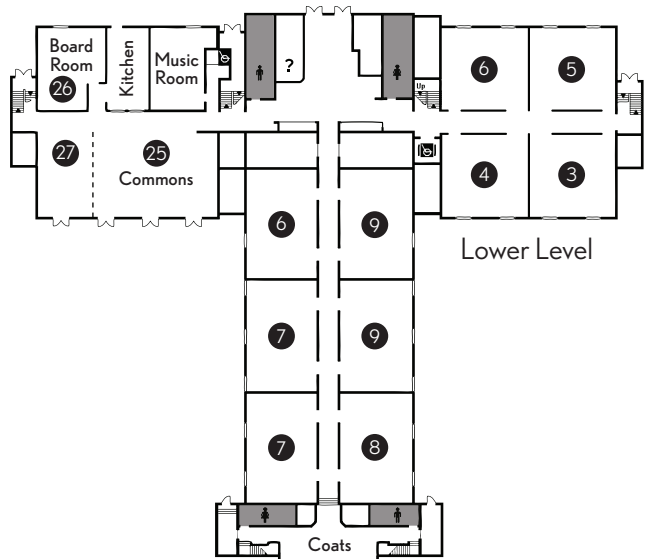

# Andrews University Campus Map

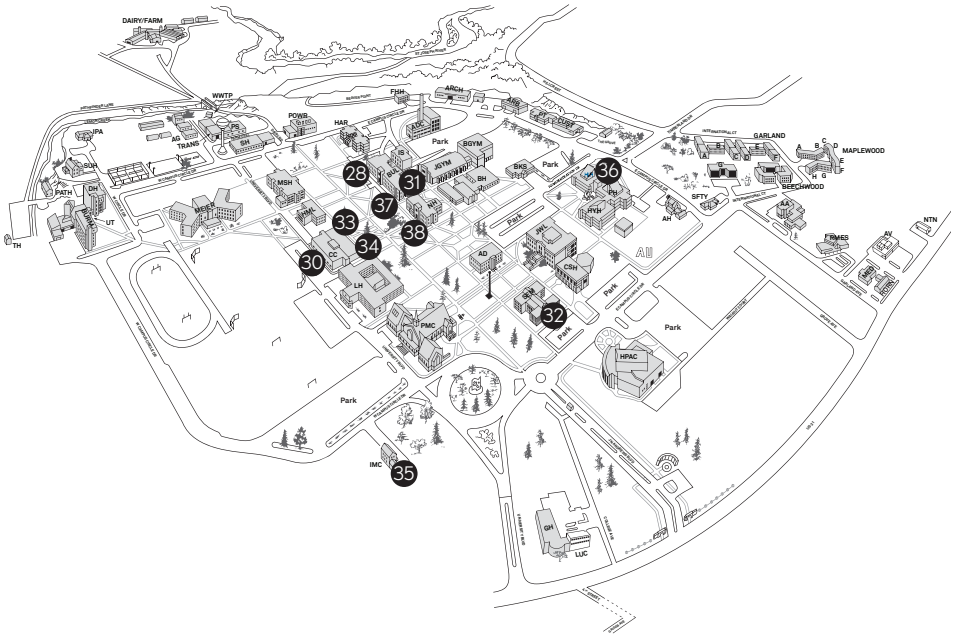

## | COLLEGIATE |

- 28 H&M (Hispanic - Religion Amphitheater)
- 29 People on the Move (PMC)
- 30 University Sabbath School (Dining Services)
- 31 Compass Sabbath School (Buller - Religion Dept.)

## | SEMINARY |

- 32 N108 (Collegiate)
- N110
- N120 (New Life Church Choir)
- N150
- N211 (Small Group)
- N235
- N310 (Digging Deep)
- N335 (Spanish)
- S340 (Upper Room)

## | ADULT @ AU |

- 33 Main Lounge
- 34 Faculty Lounge
- 35 Back to Basics
- 36 Living Word Fellowship
- 37 Current Events (Nethery - 134)
- 38 Bible Journey (Nethery - 143)





# ARE YOU READY?

- ✓ Backpack
  - ✓ Water Bottle
  - ✓ Markers
  - ✓ Calculator
  - ✓ Registration at RMES
- .....

If you haven't enrolled your student at RMES,  
would like to tour the campus, or just have questions,  
please feel free to contact us.



Ruth Murdoch Elementary School  
8885 Garland Ave., Berrien Springs, MI 49104  
269.471.3225 • [www.myRMES.org](http://www.myRMES.org)



**school begins  
AUGUST 21!**