

PIONEER CONNECT

AUGUST 11, 2018



I have a heart for

the Family of God



WELCOME

to Pioneer

On the cusp of a new school year, it is easy to think about all the things that need to be done before we are ready. Ready or not, here it comes. There are supplies needed and registration to be completed. There are bulletin boards to decorate and desks to be straightened. There are new names to learn and lessons to be written. There are backpacks to be filled and lunches to be packed.

This morning we welcome you to Pioneer to worship with us. We welcome you this Sabbath to step out of the commotion of preparation and enter into worship. Luke 2:52 reads, "And Jesus increased in wisdom and in stature and in favor with God and man." So, as the new school year begins, let us not only prepare for new classes and students, but let us prepare our hearts as we worship together.

—Ben Martin



PIONEER MEMORIAL CHURCH

8655 UNIVERSITY BOULEVARD, BERRIEN SPRINGS, MI 49103

OFFICE HOURS

Monday – Thursday (8 to 5) • Friday (8 to 12)

PHONE – 269.471.3133

FAX – 269.471.6152

LIVE STREAMING

www.pmchurch.org

Sabbath 11:45 AM

ONLINE

www.pmchurch.org

www.newperceptions.tv

RADIO

WAUS – 90.7 FM

Sabbath 11:30 AM



NOMINATING REPORT

Scan this code to read the
Nominating Committee Report.



FIND A SABBATH SCHOOL

FIND IT HERE

CONNECT • GROW • SERVE • GO



4

EDITORIAL

"What's Your Ministry?"

7

WE STUDY

"The Ministry of Peter"

9

ANNOUNCEMENTS

6

PIONEER

@ WORSHIP

9:00 & 11:45 AM

Services

13

CONTACTS

14

**SABBATH SCHOOL
DIRECTORY**



WHAT'S YOUR MINISTRY?

BY BRIANNA MARTIN

Maybe for you, there's an easy answer for that question. For many of us, it's a question we struggle with. The reality is, though, that we are ALL called to minister with our gifts and talents; not only preachers and religion teachers. Every one of us is a potential disciple-maker: no exceptions.

That means that whether you're an extrovert or an introvert, a teen or a retiree, a crafter or a gamer, an entrepreneur or a stay-at-home dad, a lawyer or an artist; the Holy Spirit can work through you to lead others to Christ.

One way that you can use your gifts is to lead a GROW Group here at PMC. We've taken a short break from GROW Groups this summer, but once the school year gets started the Fall groups will be

back, meeting from September 30 through December 9, 2018.

If you've been praying for a way to be a part of God Reaching Out Widely in this community, ask God if He's leading you to start a GROW Group. We're looking for all types of leaders to host small groups of people with similar interests to study, pray, and enjoy activities together.

God has in fact placed the parts in the body, every one of them, just as He wanted them to be. If they were all one part, where would the body be? As it is, there are many parts, but one body (1 Cor. 12:18-20).

There's room for groups of all kinds; whether you're gathering to work on puzzles, play a sport, make music, discuss a book, learn a language, champion a

cause, eat food, take a hike, play board games, or simply to pray together. If you're not sure an idea for a GROW Group will work, feel free to talk to me about it! Better yet, just take a leap of faith and see who God sends your way.

If you've been a leader before, we still need you! Whether you decide to lead the same type of group again or try something totally different, your leadership is valuable and appreciated.

When you've made your decision to lead, head to www.pmchurch.org/grow and fill out the form to let us know what sort of group you're forming, as well as the dates, times, and location you'll want to meet. You don't have to host the group in your home, and we'll help you find a meeting place if you need. If you have any questions before, during, or after filling out the form, please don't hesitate to contact me (Brianna Martin) or Gracie Gaytan at growgroups@pmchurch.org or 269.471.3133.

Of course, not everyone is called to lead a GROW Group, and that's okay! But you're not off the hook, because when the GROW Group catalog comes out, we need you to join a group. Even if you're not a joiner, take a step out of your comfort zone and give it a try. Invite a friend (or two or three) to try with you. The worst that could happen is that you have an opportunity for character growth. The best that could happen is that you make new friends, help someone feel loved and included, learn something new, and have a part in bringing someone to Christ as you, too, grow closer to Him.

Please, pray about this exciting opportunity to be a part of this vibrant and dynamic ministry. Now you are the body of Christ, and each one of you is a part of it (1 Cor. 12:27). ■

Brianna Martin is the Fall GROW Group Coordinator here at PMC.



WE WORSHIP

CONNECT • GROW • SERVE • GO

Opening Voluntary

Andante Moderato • Marcel Dupré

Introit

*The Church Has One Foundation • Kenneth Logan**

Call to Worship

Ben Martin

Let us hold unswervingly to the hope we profess, for He who promised is faithful.

And let us consider how we may spur one another on toward love and good deeds.

Let us not give up meeting together, as some are in the habit of doing.

But let us encourage one another—and all the more as you see the Day approaching.

Doxology

Praise God, From Whom All Blessings Flow • 2

Invocation

Sharon Terrell

Hymn of Praise

The Church Has One Foundation • words 348; melody 619

Congregational Prayer

Ben Martin
Spirit of the Living God • 672

Worship in Music

Andante • Édouard Lalo

Baptism

Jennifer Jean with Ben Martin*

Baby Dedication

Arlo Isaiah Martin presented by Ben & Brianna Martin
with Dwight K. Nelson**

Children's Story

It Is Well With My Soul • Bruce Ashton

Scripture

Ephesians 2:19-22 NIV • Marcos & Laia Burgos*
Debbie and Ante Jeronic**

Consequently, you are no foreigners and strangers, but fellow citizens with God's people and also members of His household.

Built on the foundation of the apostles and prophets, with Christ Jesus Himself as the chief cornerstone,

In whom the whole building is joined together and rises to become a holy temple in the Lord

And in Him, you too are being built together to become a dwelling in which God lives by His Spirit.

Hymn of Preparation

I Love Your Kingdom, Lord • 344

Sermon

"I Have a Heart for the Family of God" • Sharon Terrell

Connect Card

Tithes & Offerings

World Budget

Hymn of Response

The Family of God • Gloria and William Gaither

Benediction

Closing Voluntary

Fantasia • Johann Sebastian Bach

PRESIDING PASTOR: José Bourget; ORGANIST: Kenneth Logan

WORSHIP IN MUSIC: Lyndon Johnston Taylor, violin

CHILDREN'S OFFERTORY: Bruce Ashton, piano

MUSIC ALIVE

"OF FOUNDATIONS"

This exploration touches upon two very different uses of "foundation." First, for the hymn "The Church Has One Foundation" we mix-and-match the words of hymn 348 with the melody of 619. A hymnal resource, the metrical tune index (p. 819), yielded a potential match for these two through the fact that the melodies of both 348 and 619 have the meter "7.6.7.6.D." The numbers indicate successive syllables in poetic lines and

"D." indicates that that meter occurs twice while going through the melody once. What other 7.6.7.6.D. melodies (pp. 820-821) may be good matches for the words of 348? The other "foundations" include those used in today's Opening Voluntary. "Foundations" (French *fonds*) are a major portion of the organ's tonal palette. *Fonds* form all the tones for today's Opening Voluntary. ■

WE STUDY

CONNECT • GROW • SERVE • GO

Song Service Rachel Sauer

Opening Song Tell Me the Story of Jesus • 152

Welcome Mordekai Ongo

Scripture & Prayer Mordekai Ongo • Acts 10:34-35

Special Feature "Sowing Church Seeds / Mission "

Offertory

Lesson Study *Classes • "The Ministry of Peter"*

Theme Song *Make Me a Blessing*

Make me a blessing; make me a blessing.
Out of my life may Jesus shine.
Make me a blessing; O Savior, I pray.
Make me a blessing; to someone today.

"Make Me a Blessing," Ira Bishop Wilson
©1924, Renewed 1952 Word Music, LLC; Used by Permission. CCLI License #392652

Benediction Rachel Sauer

ORGANIST: Kenneth Logan
OFFERTORY: Ricardo Reyna

SUBMIT bulletin announcements by visiting our form online at www.pmchurch.org/announcements/submit. Requests must be received Monday by 5:00 PM for consideration.

NEXT WEEK'S OFFERING
PMC Operating Expense

SUNSET TODAY • 8:54
SUNSET NEXT FRIDAY • 8:44

PIONEER PULPIT

| 08 • 18 |

DWIGHT K. NELSON

"Renovate! (Putting Last Things First)"
Faculty/Staff Dedication Sabbath

| 08 • 25 |

DWIGHT K. NELSON

"Etavoner! (Putting First things First)"
New Student Welcome Sabbath

FINANCIAL FEATURE

WORLD BUDGET

Today, as we feature three of our prominent universities, we stand in awe at "what God hath wrought." For a denomination of our size should not be able to have such a powerful influence in the world as we do through these very special entities. But we do, and it is a direct result of the faithfulness and dedication of our people. Let us then not only give to assist the educational work carried forward around us, but also strive to be shining lights wherever God has placed us, through consistency in tithes and offerings and in other forms of service to the cause of God.

Family Vespers

TODAY • 8:00 PM
YOUTH CHAPEL

You are welcome to close the Sabbath with a vespers of sacred music and Scripture.

Summer Exercise Classes

ToBoFit, Tuesdays and Thursdays, 5:00-5:50 PM. Lamson Hall Health Club will take a break from July 27–August 27. Will resume August 28.

PMC Member Pictorial Directories

The PMC Member Pictorial Directories are here! If you had your picture taken or submitted a photo, you are entitled to pick up a free directory. The directories will be available on Sabbaths through the month of August at the lower level welcome center or at the PMC office during normal business hours. One directory per family.

PMC's New Student Welcome Picnic

AUGUST 25

Save the date for our annual new student welcome picnic! We will need 65 host families to feed our new students and make them feel at home. Be a host by signing up at www.pmchurch.org/newstudentpicnic or call 269.471.3133 or 269.471.3134. Be sure to include your name, email and contact number. Thank you!

Pathfinder Club Registration

AUGUST 15, 2018 • 6:30-8:00 PM

Evergreens Pathfinder Club Registration will be at the Pathfinder Building. Meeting will begin on August 22 at 6:20-8:00 PM. You can begin the online registration at the Pathfinder page on the PMC Church website.

Adventurers Registration 2018-2019

AUGUST 26 • 10:00 AM-12:00 PM

The teachers and staff of our Forever Friends Adventurer Club are getting ready for another exciting year! We would love to have your child become part of our club. Please come to our registration event. We will be in the children's Sabbath school classrooms, by the welcome lobby, lower level. Please bring cash or check. For more information, email Adventurers@pmchurch.org.

Memorial Service

On Sunday, August 12, at 2:00 PM a memorial service for Lauren Matacio, who died on July 30 will take place in the Youth Chapel. With Jamie, her daughter, we long for Jesus triumphant return. "Even so, come Lord Jesus." Memorial contributions for Lauren may be directed to Fernwood Botanical Garden 13988 Range Line Rd. Niles, MI. 49120.

Thank You!

The family of Bob Wilkins would like to express their appreciation to the Pioneer Memorial Church family for the beautiful flower arrangement for Bob's memorial service, and for the delicious meal prepared by Pat Erhard and her team of volunteers. —Fran Watkinson-Wilkins, the Hilderbrandt and Bermingham Families

Adventist Retirees Monthly Meeting

AUGUST 12 • 1:00 PM

WOLF PRAIRIE PARK,
BERRIEN SPRINGS, MI

The monthly meeting of the Adventist Retirees of Michiana will be meeting. This is the annual pot-luck and corn roast. Bring a dish to share. The corn is furnished by the organization. All seniors 55 and older are welcome to join us for this annual late summer event.

Less than 2 Weeks Left to Volunteer for the Health Tent

AUGUST 13-18, 2018

We're less than 2 weeks away from the start of the Berrien County Youth Fair, and the Health Tent outreach ministry has been part of it for more than 40 years. So, help us share health information with some of the >125,000 people who visit the Fair. Get several of your friends and go to www.HealthTent.org, click on Volunteer Registration, and follow in the instructions. You will have fun and be blessed at the same time!

Hymn Sing at the Old Rugged Cross Church

AUGUST 18 • 5:00-6:00 PM

6104 VERMONT STREET, POKAGON, MI

We'll be singing your favorites from the Gospel Melodies, an old Adventist hymnal. If you have one or more copies of the Gospel Melodies hymnal, please bring them along to share with others. A tour of the historic site will follow immediately after the hymn-sing. For more information, contact Melchizedek Ponniah (269.876.7476 or melponniah@gmail.com).

Teacher's Assistant Needed

The Eau Claire SDA Elementary School is seeking a part-time teacher's aide for the 2018-2019 school year. We are looking for an energetic person who enjoys inspiring kids and leading them to Christ. Applicants must be an SDA church member in good standing. Email your resume with references to tayloresa@gmail.com to schedule an interview.

Ladies Self-Defense GROW Group

Ladies, would you know what to do if your purse got snatched? Come find out from a professional, expert ways in how to protect yourself. Come for fitness, fun, and focused methods. No cost. Begins Monday, August 6, 2018, from 5:30-6:30 PM. The group meets at Pipestone Plaza (near Burlington Coat Factory and Unique Hair). 1968 Pipestone Road, Benton Harbor, MI 49022.

Military Service and Chaplaincy Contact

Is military service inviting to you? Good job, educational opportunity, world-wide travel? Can you be a faithful Adventist Christian and serve in the military? What do you need to know before enlisting? Are you already a service member and would like some support? If you have questions and want straight answers or know someone who does, contact James North, Jr., your PMC Servicemen's/Chaplaincy contact: 269.471.1590. Dr. North has served 20 years as an SDA Air Force Chaplain and 25 years as a staff member of the SDA Church's military liaison office-National Service Organization/Adventist Chaplaincy Ministries. At your service!

12 Weeks to Wellness & Optimal Health with Dr. Wes Youngberg

7:00 PM • SEPTEMBER 7, 2018

4731 GREENFIELD DRIVE,
BERRIEN SPRINGS, MI

Dr. Youngberg has helped thousands to prevent and reverse disease—heart disease, digestion issues, diabetes, and even Alzheimer's and cognitive decline. This video series will begin on September 7, 2018. Topic 1 is "Optimizing Your Genetic Potential"; Topic 2 will be "Optimizing Your Metabolism;" and Topic 3 "Optimizing Circulation & Heart Health". Come and enjoy—You'll never be the same again!

Global Urban Mission and Ministry Congress

SEPTEMBER 6–8, 2018

"God's City, My City: Transforming Communities through Christ's Love" is the first global Urban Mission and Ministry Congress in the history of the Adventist church. It's planned by entities of the North American Division and General Conference. The nation's leading Christian voices will be speaking, leading workshops, and engaging in dialogue on such issues as violence, secular culture, race relations, moral reasoning, poverty, the Gospel in a culture of wealth, birthing urban congregations, health and wellness, community organizing, immigration, and contemporary sexuality. Go to www.urbanmissionandministry.com.

Stroke Support Group of Southwestern Michigan

For individuals of all ages who have survived a stroke or are caring for someone who has had a stroke. This support group provides a safe, educational, and interactive environment for stroke survivors to connect with others who have experienced the same challenges. They meet at Buchanan Area Senior Center every first Wednesday of the month at 6:30 PM.

SciFEST for High Schoolers

SEPT 20–22 • 5:00 PM

SCIENCE COMPLEX
ANDREWS UNIVERSITY

Andrews University invites high-school students to their annual STEM weekend, SciFEST, on September 20-22, 2018. Mark your calendars and plan to join us for hands-on labs, spiritual activities, academic challenges, and a memorable weekend this fall. For more details visit: andrews.edu/scifest. Contact Monica Nudd for information on SciFEST: stemconnect@andrews.edu or call 269.471.3872.

AMEN Conference

OCTOBER 25–28, 2018

INDIAN WELLS, CA

Physicians, dentists, healthcare professionals, and pastors are encouraged to attend. This conference will call each of us to a deeper level of service that goes beyond our comfort zone. Speakers include: Pastor John Bradshaw, Pastor Wes Peppers; Dentist Stephen Wright; Physician Brian Schwartz, and many others. This year a special symposium for young professionals (especially residents & fellows) will be held Friday and Sabbath afternoon. More info at www.amensda.org/conferences.

Lake Union Provider Well-being Conference

OCTOBER 5–6, 2018

Join us for this uplifting weekend to recharge personally and professionally. Target Audience: Physicians, Dentists and Optometrists and their families. Location: Hyatt Lodge, 2815 Jorie Blvd, Oak Brook, IL 60523. Speakers include: Dr. Ted Hamilton, Chief Mission Integration Officer and VP, Adventist Health System; Randy Griffin, DDS, Lake Union Health Director; Pastor Dwight Nelson; Chef Mark Anthony; For more information and to register, please visit: www.amp.lakeunion.org.

| PASTORS |

Chaplain / Pioneer

José Bourget • 471.6254
bourget@pmchurch.org

Discipleship / GROW Groups

471.6153
growgroups@pmchurch.org

Harbor of Hope

Taurus Montgomery • 269.210.6155
montgomery@pmchurch.org

Lead Chaplain

June Price • 471.6282
juneprice@andrews.edu

Lead Pastor

Dwight K. Nelson • 471.3134
nelson@pmchurch.org

Stewardship

Sharon Terrell • 471.6151
terrell@pmchurch.org

This Generation Evangelism

Rodlie Ortiz • 471.6154
ortiz@pmchurch.org

Youth Ministries

Ben Martin • 471.6176
martin@pmchurch.org

Media Ministries

Richard Parke • 471.3246
parke@pmchurch.org

Music

Kenneth Logan • 471.3231
logan@pmchurch.org

| STAFF |

Admin. Assistant

Lailane Legoh • 471.3543
legoh@pmchurch.org

Admin. Assistant / Clerk

Gracie Gaytan • 471.3133
clerk@pmchurch.org

Receptionist

Jackie Bikichky • 471.3133
bikichky@pmchurch.org

Assistant Media Director

Gaddiel Zelaya Martínez • 471.3678
zelaya@pmchurch.org

Assistant Treasurer

JoAnn Siagian • 471.7656
siagian@pmchurch.org

Executive Assistant

Claudia Sowler • 471.3134
sowler@pmchurch.org

Graphic Designer

Brittany Doyle • 471.3647
bulletin@pmchurch.org

Maintenance

Larry White • 471.3649
white@pmchurch.org

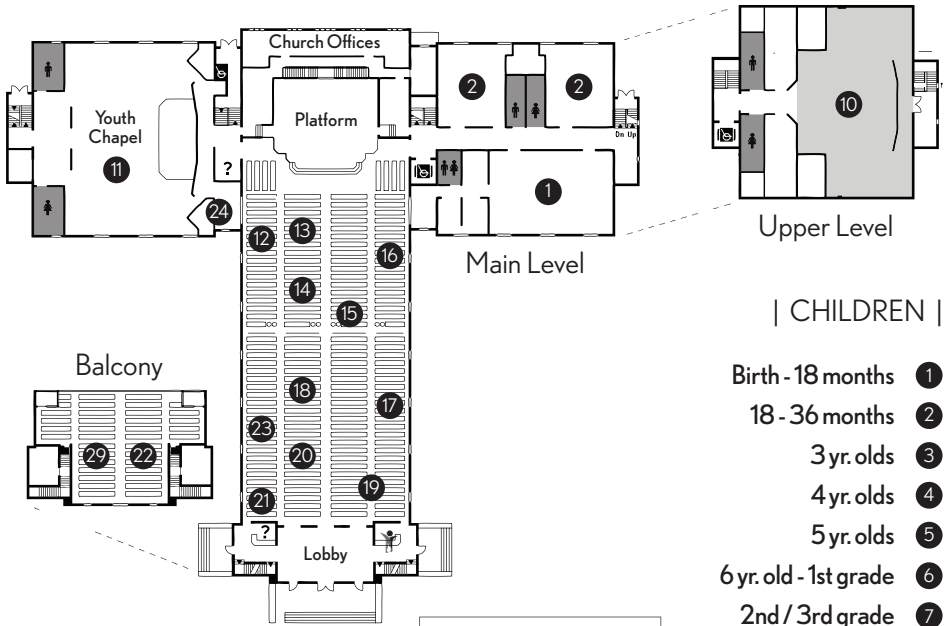

| CHILDREN |

- Birth - 18 months ①
- 18 - 36 months ②
- 3 yr. olds ③
- 4 yr. olds ④
- 5 yr. olds ⑤
- 6 yr. old - 1st grade ⑥
- 2nd / 3rd grade ⑦
- 4th grade ⑧
- 5th / 6th grade ⑨
- Earliteen ⑩
- Youth ⑪

| ADULT |

- ⑫ Group 1
- ⑬ Group 2 (Portuguese/Brazilian)
- ⑭ Group 3
- ⑮ Group 4 (Yugoslavian)
- ⑯ Group 5
- ⑰ Group 6
- ⑱ Group 7
- ⑲ Group 8
- ⑳ Group 9 (Spanish)
- ㉑ Group 10
- ㉒ Group 11 (Balcony)
- ㉓ Group 12 (French)
- ㉔ Conference Room
- ㉕ Something In Common
- ㉖ Young Adults
- ㉗ SDA Beliefs

| KEY |

- ? Welcome Centers
- ⬇ Elevators
- ♂ Restrooms
- 👤 Children's Activities & Lending Library

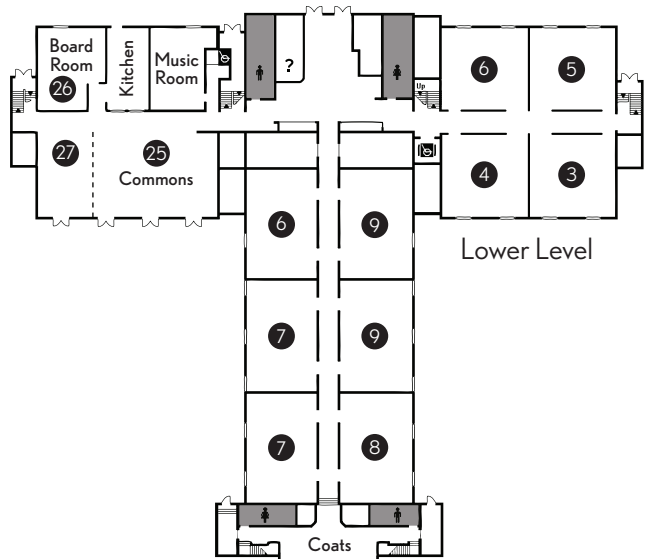

Andrews University Campus Map

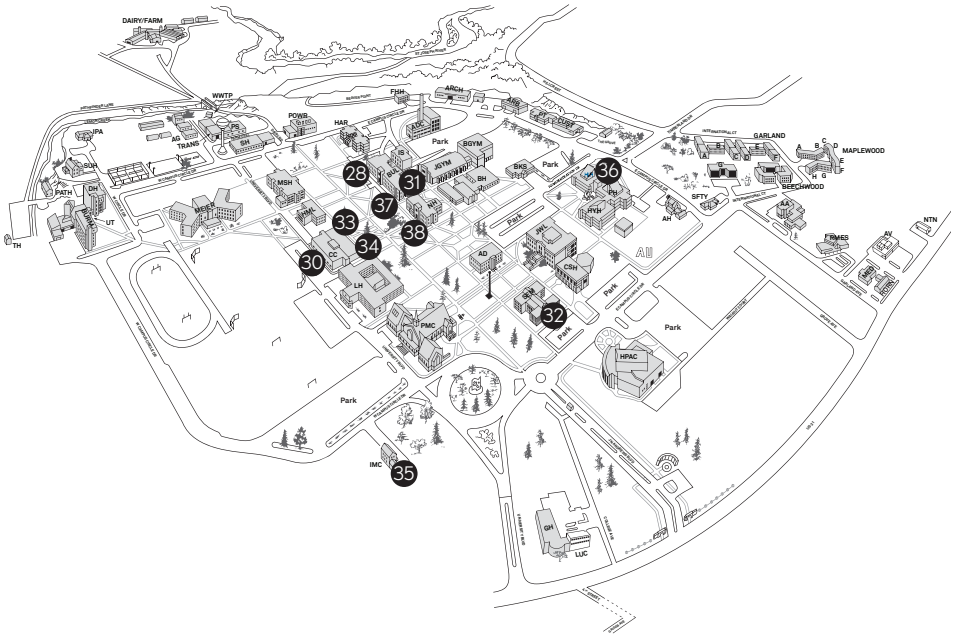

| COLLEGIATE |

- 28 H&M (Hispanic - Religion Amphitheater)
- 29 People on the Move (PMC)
- 30 University Sabbath School (Dining Services)
- 31 Compass Sabbath School (Buller - Religion Dept.)

| SEMINARY |

- 32 N108 (Collegiate)
- N110
- N120 (New Life Church Choir)
- N150
- N211 (Small Group)
- N235
- N310 (Russian)
- N335 (Spanish)
- S340 (Upper Room)

| ADULT @ AU |

- 33 Main Lounge
- 34 Faculty Lounge
- 35 Back to Basics
- 36 Living Word Fellowship
- 37 Current Events (Nethery Hall-134)
- 38 Bible Journey (Nethery - 143)



JOIN US FOR THE

New Student Picnic

08 | 25 | 2018



FOLLOWING SECOND SERVICE

IF YOU WOULD LIKE TO BE A HOST
GO TO WWW.PMCHURCH.ORG/NEWSTUDENTPICNIC