

PIONEER CONNECT

JUNE 13, 2015

ROAD TRIP:



*How Detours Can
Get Us There
Another Way*

DETOUR AHEAD

With the arrival of summer comes the onslaught of road construction. We know the reason is to better the roads, however it can make life difficult during the process.

If you are reading this inside our church walls today, you know very well the extra effort it takes for you to travel around Berrien Springs with the roads under construction. For those who travel southbound on Old 31 after church today, the construction zone is rather simple to navigate. However, those who need to use the northbound lane (which has been temporarily closed) now have to travel four miles instead of the original mile.

Sometimes in life, we face the same challenges. Our journey ends up taking longer than it perhaps could have. Just take a look at the Israelites in the desert. While they could have gone right into the promised land, their lack of faith required them to take a significant detour. However, God was able to use that extra time and distance for their benefit. The same goes for us today.

No matter what detours and life circumstances you are facing today, we are glad you found your way here to receive God's blessings.

-Brenton & Rachelle Offenback

A FAREWELL SABBATH

Members of the media team gather to say farewell to Nick Wolfer, PMC's director of Media Ministries, after second service last week.

(Photo credit: David Steen)



FIND IT HERE

CONNECT • GROW • SERVE • GO



4

EDITORIAL

Sharpen, Polish, Repeat

10

SABBATH SCHOOL

The Kingdom of God

15

FAMILY FINANCES

6

FEATURE ARTICLE

3 Ways to Get Involved
in Ministry

11

PIONEER TWO

11:45 AM Worship

16

CONTACTS

8

PIONEER ONE

9:00 AM Worship

12

ANNOUNCEMENTS

18

SABBATH SCHOOL DIRECTORY

14

CHRISTIAN EDUCATION

So How Does This
Bible Work?

SHARPEN, POLISH, REPEAT

BY GARRISON HAYES

In Matthew 18, Jesus tells the story of the Lost Sheep. He says that the sheep, the lost one, wanders off into the mountains—alone, independent, perhaps searching. Jesus continues His narrative, telling us that the good shepherd leaves the ninety-nine other sheep that he's tending to, just to go recover the one. Just to bring the one back.

Not too long ago, I had a conversation with a friend who has found themselves drifting from the church. They said they weren't really sure if "church" or being a part of church was really necessary anymore. My friend isn't alone: they weren't the first person to express that sentiment, and they definitely won't be the last.

So what does the Bible say about church, and is it really necessary? Considering the medium in which this piece is being shared, a church bulletin, I really hope so.

In Hebrews 10:25 the Bible says without a shadow of a doubt that we shouldn't neglect the assembling of ourselves together, especially as Jesus' second coming approaches.

But why?

Jesus and community are irreversibly linked. Jesus loves what church represents.

In Matthew He says, "Where two or three are gathered together in my name, I am there in the midst of them." Jesus wants to be where the people are. In John, Jesus reminded His disciples that He was leaving earth to go and prepare a place for us in heaven, so that where He is, there we may be also. Jesus wants to be with us!

Jesus loves spiritual community. He loves it so much that He welded community and our commission together—to go ye therefore and teach all *nations*.

In Galatians 6, we are commanded to bear the burdens of those who are struggling spiritually, and by doing so, we fulfill the law and the mission of Christ. You see, real church isn't just a one-day-out-of-the-week affair. When we are engaged in *real* and *true* church, as a spiritual community of faith, we bear each other's burdens, we support each other, we encourage each other, we celebrate with each other, we cry with each other, we pray for each other, and together with our Good Shepherd we tenaciously love those sheep who are lost, wandering, or perhaps searching.

Solomon wrote that "Iron sharpens iron"—uncomfortable imagery representing exactly what Christ desires church to be: Imperfect human beings aiding in the perfection of one another. Jesus is at the controls: *sharpen, polish, repeat. Sharpen, polish, repeat.* He works tirelessly, anticipating the day when His beautiful image is perfectly reflected in us, declaring, "It is finished."

So, is "church" really necessary?

Yes. Now more than ever. ■

Garrison Hayes is pursuing his Masters of Divinity here at Andrews University.



3 WAYS TO GET INVOLVED IN MINISTRY

BY KRYZIA ABACAN

With the weather outside getting warmer and the beginning of summer drawing closer, you may find yourself with a lot more free time than usual. As a parent, you no longer have to spend time baking a cake for that bake sale or attending a concert to hear your child play. As a student, you no longer have to spend energy working hard on homework or hours sitting around in class. At the beginning of each day, you may find yourself wondering, "What could I possibly do today?" because the time that used to escape you seems to linger longer than usual. If you ever draw a blank and you are looking for something meaningful to do with your time, why not practice our mission to connect, grow, serve, and go?

PMC is blessed with several ministries that offer different ways to help the community. There is a wide range of opportunities for us to serve and minister to others. So, are you ready to serve, but you are not quite sure where to begin? Here are a few suggestions that will hopefully get you started:

1 For a one-day activity or short-term commitment, you can check the bulletin announcements. There are numerous ministries that submit announcements to Pioneer Connect requesting volunteers for a specific event or donations for a particular cause. If you have the time or the goods that they are seeking, do not hes-

itate to lend a helping hand. Though your experience may be brief, your service will still go a long way.

2 To serve with a particular ministry, contact that ministry directly. If you feel that specific ministry can use your unique personality, skills, and talents, do not hesitate to get in touch with the leaders of that ministry. They are always looking for people with a passion for the work that they do.

3 If you find yourself torn between choosing an internship that will fulfill school-related requirements or a volunteer experience with a particular ministry, be aware that you may not have to choose one or the other! You can approach a ministry leader and let them know what kind of





experience you are looking for. There is a way for you to fulfill your immediate needs regarding school and your urge to help, serve, and volunteer.

THERE IS A WIDE RANGE OF OPPORTUNITIES FOR US TO SERVE AND MINISTER TO OTHERS.

So, why not spend your free time this summer lending a helping hand and sharing Christ's love with others? God is calling each one of us to give Him the little time, energy, and faith that we have so that He can multiply it, stretch it, and grow it. He wants us to take the opportunity to strengthen our

trust in Him, to grow our faith in Him, and to deepen our relationship with Him through service and ministry. Our time, energy, and faith may be small in our own hands, but it becomes great in God's hands.

There are so many opportunities for you to **CONNECT**, **GROW**, **SERVE**, and **GO**. Heed God's calling today and allow Him to use you in more ways than one. The experience will not only enrich your spiritual walk, but it may just enrich or begin someone else's journey. ■

Kryzia Abacan is the interim Pioneer Connect editor.

FAMILY WORSHIP

CONNECT • GROW • SERVE • GO

Opening Voluntary

Jesus, My Joy • Theophil Forchhammer

Introit

Come, Holy Spirit, Heavenly Dove • John Dykes

Call to Worship

Bryan von Dorpowski

Shall those in need take their refuge in God?

God remembers the faithful. Hope always in God.

Where is our God? Will earnest seekers find the Lord?

God comes to us. Listen for the word of God.

Doxology

Praise God, From Whom All Blessings Flow • 2

Invocation

José Bourget

Hymns of Praise and Meditation

Come, Thou Fount of Every Blessing • 334

Marvelous Grace • 109

Amazing Grace • st. 1-3 of 108

Congregational Prayer

Burn Family

Blest Be the Tie That Binds • st. 1 & 2 of 350

Baptism

Children's Story

Amazing Grace • Charles Callahan

Scripture

Jeremiah 29:11-14 MSG & NLT • Burn Family

I know what I'm doing. I have it all planned out—plans to take care of you,
not abandon you, plans to give you the future you hope for.

**In those days when you pray, I will listen. If you look for me
wholeheartedly, you will find me.**

Yes, when you get serious about finding me and want it more than anything else,
I'll make sure you won't be disappointed.

Worship in Music

Andante • Jean Sibelius

Sermon

"Road Trip: How Detours Can Get Us There Another Way"

José Bourget

Connect Cards, Tithes & Offerings

GC Session Offering for World Mission

Hymn of Commitment

Day by Day • 532

Benediction

Closing Voluntary

Heroic Postlude • Alec Rowley

PRESIDING ELDER: Bryan von Dorpowski; ORGANIST: Joshua Goines
WORSHIP IN MUSIC: Pablo Sánchez, violin; Emily Perkins, piano
WORSHIP LEADERS: Laurence, Lois, Ruth and Jonathan Burn

MUSIC ALIVE

ASKING FOR THE FOUNTAIN

The text of the hymn "Come, Thou Fount of Every Blessing" (see hymn 334) goes back more than 250 years, before the American Revolutionary War. Author Robert Robinson was English. His years from about age 14 to age 20 witnessed significant shifts, first in a "careless" life, then in a life with an awakened conscience at 17, then some three years later in the experience of being

"really converted," as one commentary has it. Although Robertson did not have a traditional course of training to be a pastor, still he served in that role. One commentary says, "He was an eloquent orator and often wrote hymns to conclude his sermons." "Come, Thou Fount" is sung often with the melody NETTLETON, named for an itinerant evangelist, Asahel Nettleton. ■

WE STUDY

CONNECT • GROW • SERVE • GO

Song Service	Chelsea Lake
Opening Hymn	<i>Holy, Holy, Holy</i> • 73
Welcome & Prayer	Judy Wright
Scripture	Isaiah 19:17
Special Feature	Lebanon Report • Tatiana Correa
Offertory	<i>There is a Fountain</i> • arr. Christy James
Bible Study	"The Kingdom of God" • Classes
Theme Song	<i>Make Me a Blessing</i>

Make me a blessing; make me a blessing.
Out of my life may Jesus shine.
Make me a blessing; O Savior, I pray.
Make me a blessing; to someone today.

"Make Me a Blessing," Ira Bishop Wilson
©1924, Renewed 1952 Word Music, LLC; Used by Permission. CCLI License #392652

Benediction	Chelsea Lake
--------------------	--------------

ORGANIST: Joshua Goines
OFFERTORY: Carlos Lozano, violin; Edgar Pérez, piano

See page 18/19 for Sabbath School directory & map

WE PRAISE

CONNECT • GROW • SERVE • GO

As We Begin

Jesus, My Joy • Theophil Forchhammer

Praise

Prayer

Bryan von Dorpowski

Children's Story

Amazing Grace • Charles Callahan

Worship in Music

Andante • Jean Sibelius

Sermon

"Road Trip: How Detours Can Get Us There Another Way"

José Bourget

Connect Card, Tithes & Offerings

Hymn

Day by Day • 532

As We Depart

Heroic Postlude • Alec Rowley

"I know what I'm doing.

I have it all planned out—plans to take care of you, not abandon you,

plans to give you the future you hope for.

In those days when you pray, I will listen.

If you look for me wholeheartedly, you will find me.

Yes, when you get serious about finding me and want it more than anything else,

I'll make sure you won't be disappointed."

Jeremiah 29:11-14 MSG & NLT

WORSHIP DIRECTOR: José Bourget; ORGANIST: Joshua Goines

WORSHIP IN MUSIC: Pablo Sánchez, violin; Emily Perkins, piano

PIONEER PEOPLE

SUNSET TODAY • 9:21
SUNSET NEXT FRIDAY • 9:23

SUBMIT announcements by emailing bulletin@pmchurch.tv or by going to www.pmchurch.org and click on "submit a bulletin announcement." Requests must be received **Monday by 5:00 PM** for consideration.

WEEK AT A GLANCE

| SATURDAY |

FAMILY VESPERS
8:00 PM • YOUTH CHAPEL

| SUNDAY |

NATURE EXPLORATION
11:00 AM • AU DAIRY FARM

PIONEER PULPIT

| 06 • 20 |

DWIGHT K. NELSON
"Think Local, Act Global: That They May Be More Than One?"

| 06 • 27 |

DWIGHT K. NELSON
"Think Local, Act Global: When Diversity Is Not Division, and Division Is Not Divided"

Family Vespers
TODAY • 8:00 PM
YOUTH CHAPEL

Pastor Balorda will share, "Two Squares, The Sanctuary Message" for vespers this evening. This is a special vespers which you do not want to miss!

Sanctuary Flowers

The Sanctuary flowers are given in celebration and thankfulness to God for the 21st birthday of Givan Hinds. We love you! -*Mom and Dad*

Thank You

Thank you all so much for the flowers, cards, and notes. The phone calls and visits were very nice too. This has been an interesting last 3 months for me staying at home. I am improving every day, God is good and bones do heal. -*Lois Nicholas*

Summer Health Series
JUNE 14 • 11:00 AM
AU DAIRY FARM

Join us as we explore nature trails on the Andrews University Campus. There will be different distance and pace groups available. Families are welcome! We will meet at the Dairy Farm. For more information contact Ryan and Christine Wallace: ryanandchristine@gmail.com.

Sanctuary Choir

Sanctuary Choir will be singing for church on June 27. There are two rehearsals for this appointment: June 17 and June 24, 7:00 to 8:30 PM in the Teen Loft. If you would like to lift your voice with singing, contact director, Jeannie Pedersen-Smith. jean.pedersen.smith@gmail.com
269-277-0488, voice or text

Adventist Retirees of Michiana

JUNE 14 • 1:00 PM

VILLAGE CHURCH FAMILY CENTER

The speakers at the next meeting of the Adventist Retirees will be Bob and Madeline Johnston. They will be sharing pictures from their 2014 trip to Keukenhoff Gardens, Amsterdam, and Normandy World War II sites. Come and join us for a potluck as we learn more. Call Mike or Shirley Gammon at 989.427.5669 if you have questions.

Take a Walk with Jean

JUNE 20 • 2:00 TO 4:00 PM
PMC COMMONS

Come join us for an open house birthday celebration for Jean Snow Patterson. We will be celebrating her 80th birthday, 60 of those years were here in Berrien Springs. Come say Happy Birthday (and have some cake). At 4 PM we will take a walk with Jean on campus.

Thank you

I would like to thank everyone for the flowers, visitors, cards and prayers and for the lovely plant from PMC. I am at Carotel Inns and would appreciate a visit.
-Eleanor Stanhiser

Day of Special Prayer

WEDNESDAY, JUNE 20

This month the United States Supreme Court will render decisions that potentially may impact religious liberty in this nation, including a decision regarding the constitutionality of same-sex marriage. The religious liberty committee of the Village SDA Church is inviting all to join in prayer this Wednesday in seeking for the will of God to be done on earth as it is in heaven. See their "Prayers for Liberty" Facebook page for more details.

Grow Michigan Evangelism Offering

Many of you are taking part in Grow Michigan by:

- Preparing hearts through relationships
- Planting seeds with the Glow Challenge
- Cultivating spiritual interests by being part of the Bible Study Reformation
- Harvesting souls through evangelistic outreach and the coming Unlocking Revelation
- Mentoring new members with the new Discipleship Handbook

Michigan Conference Churches, along with other Conferences in the Lake Union, are planning approximately 300 sites for Unlocking Revelation in 2016! This is fantastic and we are anticipating the outpouring of God's Spirit! To accomplish this we need to raise an additional \$200,000 beyond what we normally spend for evangelism in a year. Ask the Lord what you could do to support Grow Michigan and Unlocking Revelation. Mark your tithe envelope Grow Michigan Evangelism and may the Lord give you great results as you personally participate in Grow Michigan!



SO HOW DOES THIS BIBLE WORK?

BY STEVE ATKINS

After a full day of learning, some Andrews Academy students stay after school to work on homework and ask questions about the lessons. My daily science labs include a spiritual lesson based on the science topic of the day. It was during an after school session when a student who was working on a lab asked, "So how does this Bible work?"

The majority of students at Andrews Academy come from Adventist homes. Many begin hearing the stories of the Bible from an early age and throughout their lives. I've been helping with PMC Cradle Roll for 19 years. Many of those children are now in my classes. So when I was first asked, "So how does this Bible work"? I was surprised. I've since heard this question several times, mostly from international students who have come to learn in an American school. Most have no background in Christianity. After a brief explanation of how the Bible works, they soon figure out how to find things in the Bible on their own.

The Academy encourages students to get involved in the church, as well as helping others in need. Some of my students choose to help in the Cradle Roll of PMC where I teach. Those who were raised in the church often remember

various things in Cradle Roll from when they were two years old. While other students have to read for the first time, for example, the story of Daniel and the lions den, before teaching.

It's a blessing to see the home, school, and church working together, all with the same purpose of introducing children of all ages to Jesus. Each school year we are blessed to have numerous students choose to follow Jesus. Nearly forty students decided to be baptized or recommit their lives to Jesus during week of prayer this past fall. Throughout the school year, various students were baptized in their home churches as well as three seniors who were baptized at PMC during this recent graduation weekend.

God is blessing Andrews Academy. Students from all different backgrounds are being baptized. Please continue to pray for Andrews Academy's students, graduates, and even its future students as they learn of Jesus and that each will decide to follow Him.

FOR MORE INFORMATION:
Jeannie Leiterman • 471.3140
leiterma@andrews.edu

pioneer memorial church FAMILY FINANCES

As of May 31, 2015

Includes May online giving

MASTER PLAN OF EVANGELISM



LINE 5 IN YOUR TITHE ENVELOPE

GOAL TO-DATE	59,136
RECEIVED TO-DATE	37,723
RECEIVED TO-DATE 2014	43,624

OPERATING FUND

LINE 2 IN YOUR TITHE ENVELOPE

GOAL TO-DATE	258,082
RECEIVED TO-DATE	239,407
RECEIVED TO-DATE 2014	228,119



CHRISTIAN EDUCATION



LINE 3 IN YOUR TITHE ENVELOPE

GOAL TO-DATE	89,562
RECEIVED TO-DATE	78,264
RECEIVED TO-DATE 2014	73,065

| PASTORS | | STAFF |

Chaplain / Pioneer

José Bourget • 471.6254
bourget@pmchurch.org

Admin. Assistant

Lailane Legoh • 471.3543
legoh@pmchurch.org

Discipleship / GROW Groups

Sabine Vatel • 471.6153
vatel@pmchurch.org

Assistant Media Director

Jonathan LaPointe • 471.3678
lapointe@pmchurch.org

Harbor of Hope

Taurus Montgomery • 269.923.9274
montgomery@pmchurch.org

Assistant Treasurer

JoAnn Siagian • 471.7656
siagian@pmchurch.org

Lead Chaplain

June Price • 471.6282
madrigal@andrews.edu

Bible Work Coordinator

Tabitha Umali • 269.340.2031
tabitha.umali@pmchurch.org

Lead Pastor

Dwight K. Nelson • 471.3134
nelson@pmchurch.org

Clerk

Jackie Bikichky • 471.3972
bikichky@pmchurch.org

Pastoral Care

Don Dronen • 471.3133
dronen@pmchurch.org

Communications

Rebecca Coleman
rebecca.coleman@pmchurch.org

Stewardship

Sharon Terrell • 471.6151
terrell@pmchurch.org

Executive Assistant

Sherrie Davis • 471.3134
davis@pmchurch.org

This Generation Evangelism

Rodlie Ortiz • 471.6154
ortiz@pmchurch.org

Graphic Designer

Rachelle Offenback • 471.3647
bulletin@pmchurch.org

Youth Ministries

Ben Martin • 471.6176
martin@pmchurch.org

Maintenance

Larry White • 471.3649
white@pmchurch.org

Media Ministries

471.3246

Music

Kenneth Logan • 471.3231
logan@pmchurch.org

| MINISTRIES | | SABBATH SCHOOL |

Adventurers

Daniel González • 423.432.0780
adventurers@pmchurch.org

Adult

Judy Aitken • 240.7997
adultss@pmchurch.org

Deacons

Milan Vajdic • 471.0328
deacons@pmchurch.org

Birth - Grade 1

Claudia Davisson • 269.208.7081
bg1@pmchurch.org

Deaconesses

Vida Giddings • 473.2175
deconesses@pmchurch.org

Grade 2 - Earliteen

Robert Barnhurst • 473.1613
g2teen@pmchurch.org

Elders

Russell & Cynthia Burrill • 473.3738
elders@pmchurch.org

GROW Groups

growgroups@pmchurch.org

Health

Evelyn Kissinger • 930.0505
health@pmchurch.org

Pathfinders

Matthew Johnson • 240.755.2661
evergreenpathfinders@gmail.com

Public Address

Joel Kitchen
audio@pmchurch.org

| OUR SCHOOLS |

Andrews Academy

Jeannie Leiterman • 471.3140
leiterma@andrews.edu

Andrews University

471.7771 or 800.253.2874
enroll@andrews.edu

Ruth Murdoch / K-8

David Waller • 471.3225
waller@andrews.edu



PIONEER MEMORIAL CHURCH

8655 UNIVERSITY BOULEVARD, BERRIEN SPRINGS, MI 49103

OFFICE HOURS

Monday – Thursday (8 to 5) • Friday (8 to 12)

PHONE – 269.471.3133

FAX – 269.471.6152

LIVE STREAMING

www.pmchurch.tv
Sabbath 11:45 AM

ONLINE

www.pmchurch.org
www.pmchurch.tv

RADIO

WAUS – 90.7 FM
Sabbath 11:30 AM

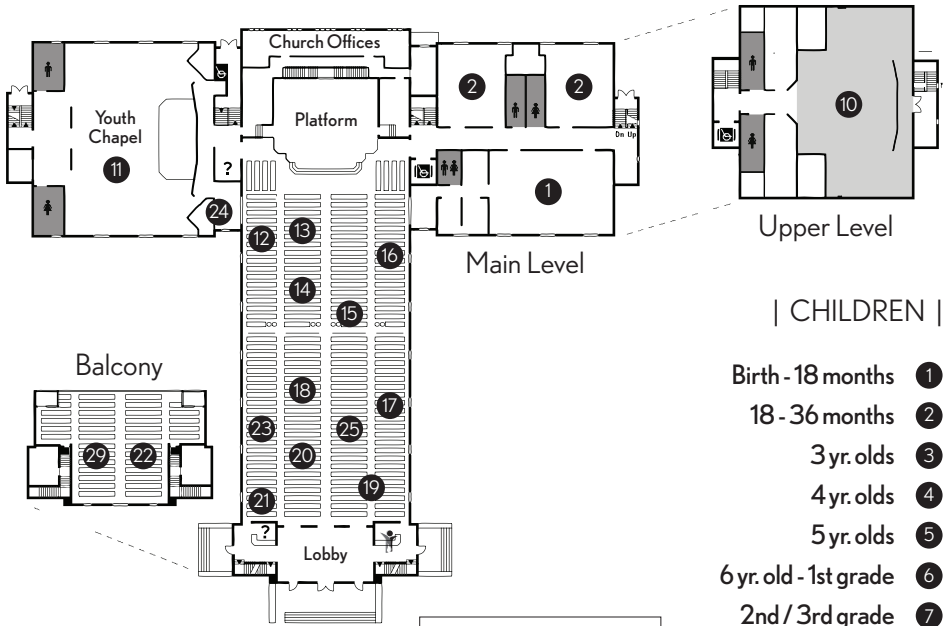

- | CHILDREN |
- Birth - 18 months ①
 - 18 - 36 months ②
 - 3 yr. olds ③
 - 4 yr. olds ④
 - 5 yr. olds ⑤
 - 6 yr. old - 1st grade ⑥
 - 2nd / 3rd grade ⑦
 - 4th grade ⑧
 - 5th / 6th grade ⑨
 - Earliteen ⑩
 - Youth ⑪

| ADULT |

- ⑫ Group 1
- ⑬ Group 2 (Portuguese/Brazilian)
- ⑭ Group 3
- ⑮ Group 4 (Yugoslavian)
- ⑯ Group 5
- ⑰ Group 6
- ⑱ Group 7
- ⑲ Group 8
- ⑳ Group 9 (Spanish)
- ㉑ Group 10
- ㉒ Group 11 (Balcony)
- ㉓ Group 12 (French)
- ㉔ Conference Room
- ㉕ Indonesian Class
- ㉖ Something In Common
- ㉗ SDA Beliefs

| KEY |

- ? Welcome Centers
- E Elevators
- Restrooms
- Children's Activities & Lending Library

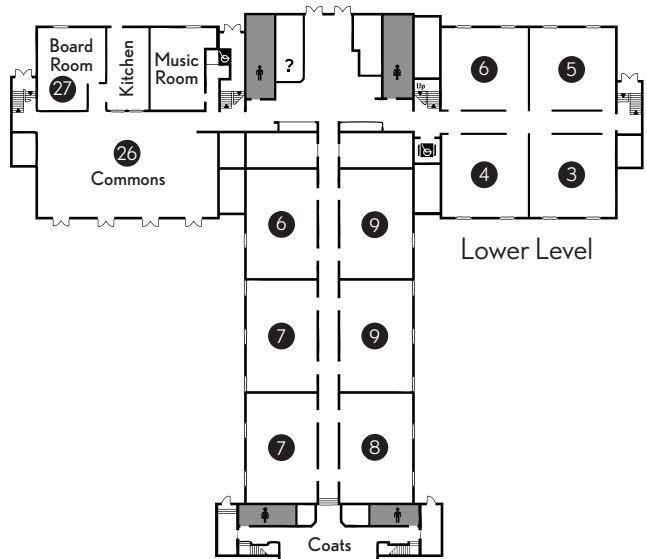

Andrews University Campus Map

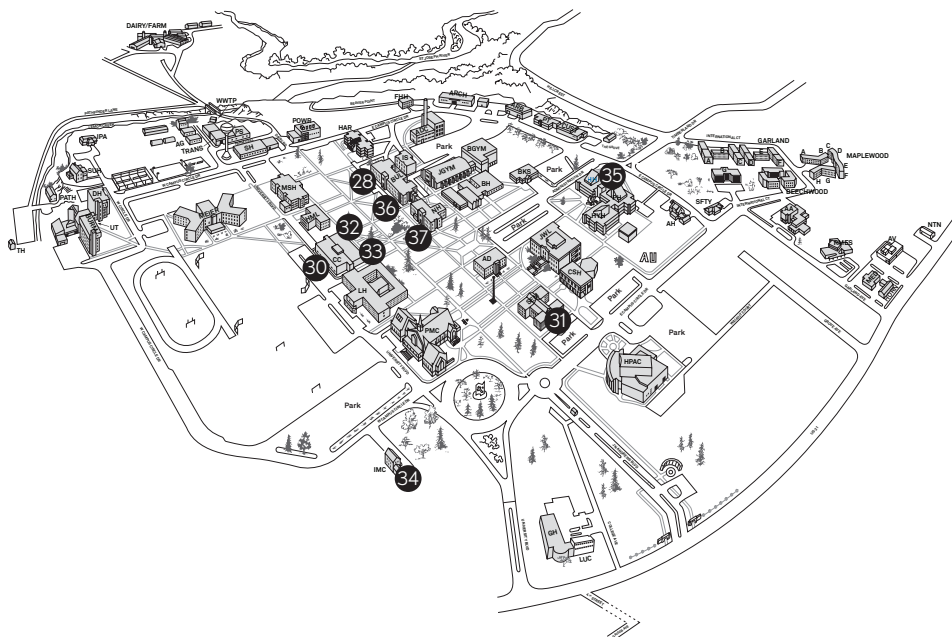

| COLLEGIATE |

- 28 H&M (Hispanic - Religion Amphitheater)
- 29 People on the Move (PMC)
- 30 University Sabbath School (Dining Services)

| SEMINARY |

- 31 N108 (Collegiate)
- N110
- N120 (New Life Church Choir)
- N150
- N211 (Small Group)
- N235
- N310 (Russian)
- N335 (Spanish)
- S340 (Upper Room)

| ADULT @ AU |

- 32 Main Lounge
- 33 Faculty Lounge
- 34 Back to Basics
- 35 Living Word Fellowship
- 36 Current Events (Buller - 135)
- 37 Bible Journey (Nethery - 143)



RMES

GARAGE SALE



JUNE 28 – JULY 5

SUNDAY: 8 AM TO 6 PM

MON-THURS: 2 TO 5 PM

FRIDAY & SATURDAY CLOSED

Help support our school
by donating or volunteering.
The proceeds from the sale will go to support
the Worthy Student Fund.

Donations such as furniture, kitchen items,
clothing, books, toys, seasonal items,
small appliances, large appliances in working condition,
and more are being accepted NOW!

FOR MORE INFORMATION

CALL 269.471.3220

