

PIONEER CONNECT

JANUARY 13, 2018

LETTER

from Dad



WE WORSHIP • PAGE 6 | WE WORSHIP 2 • PAGE 9

WELCOME

to Pioneer

"Christ accepted you, so you should accept each other, which will bring glory to God" (Romans 15:7).

More than ever we live in a time where the prevalency of loneliness has become a health crisis and a cause of premature death among young and old. God created us to belong to each other. The Bible reminds us that God welcomes us as His children. People who realize they are adopted into God's family can see others as brothers and sisters.

Some of the ways we begin to extend God's welcome to each other are through adopting a student, hosting a GROW Group, or acknowledging each other this morning.

Let's take time this morning to share a warm handshake and a smile as we worship our heavenly Father together with gladness. Welcome home!

—Sabine Vatel



PIONEER MEMORIAL CHURCH

8655 UNIVERSITY BOULEVARD, BERRIEN SPRINGS, MI 49103

OFFICE HOURS

Monday – Thursday (8 to 5) • Friday (8 to 12)

PHONE – 269.471.3133

FAX – 269.471.6152

LIVE STREAMING

www.pmchurch.org

Sabbath 11:45 AM

ONLINE

www.pmchurch.org

www.newperceptions.tv

RADIO

WAUS – 90.7 FM

Sabbath 11:30 AM



NOMINATING REPORT

Scan this code to view the most recent Nominating Committee Report.



FIND A SABBATH SCHOOL

FIND IT HERE

CONNECT • GROW • SERVE • GO

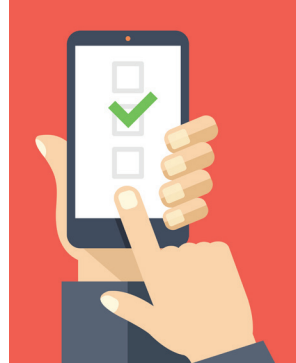

4

PIONEER LIFE
Pathfinder Bible
Experience

8

SABBATH SCHOOL
I See, I Want, I Take

10

ANNOUNCEMENTS

6

WE WORSHIP
9:00 AM Service

9

WE WORSHIP 2
11:45 AM Service

13

CONTACTS



PATHFINDER BIBLE EXPERIENCE

BY RYAN CLOUGH

Today's youth have many things competing for their time: school, family obligations, sports, music, friends, work, etc. They are bombarded with ways to use their time, some positive, some just distracting, and some, downright negative. That's why I'm excited to report that this past fall, over a dozen of our Pathfinder youth signed up to be part of Pioneer Memorial Church's Pathfinder Bible Experience (PBE) teams. We began meeting in November and formed two teams of six, assisted by a few older PBE "veterans." PBE is a big commitment, with weekly meetings and a daily schedule of Bible memorization that, if followed, will result in each team member having 3 to 6 chapters of the Bible memorized by the end of January. Just being on a PBE team doesn't make any of those time distracters go away; and some of the team members are struggling to take the daily time to study and memorize their sections. That's where being part of a team can help. Team members can encourage one another as they work on their sections. Team members are also encouraged to pray for each other.

This year the focus of PBE is the books of Esther and Daniel. Both of these books show how God worked in the lives of youth, when they were faithful to His calling. Each team member has a section of the Bible which he or she is responsible for studying and memorizing: Esther 1-4, 5-10; Daniel 1-3, 4-6, 7-9, 10-12. The sections range from 77 to 100 verses, and each team member has 1 to 3 verses to memorize each day. When we meet at our weekly meetings, we review the memory work, and then quiz each other, practicing using those verses which they have memorized. The goal is to be able to answer questions about their verses at the four different PBE level meets.

The first meet is coming up at the beginning of February. If a team scores high enough at this first meet, they will advance to the next level, and so on. This year's fourth and final meet will be held in Orlando, FL, this April, where over 100 teams of Pathfinder youth are expected to participate in the Division level meet. It is an exciting experience for these Pathfinders to see fellow Pathfinders from across the country, Canada, and the United Kingdom, who have also committed their time and effort to the study and memorization of God's word.

Would you like to partner with us on our PBE journey? The third level meet (Lake Union) will be held here at PMC on the afternoon of March 17. Select one of the sections above and begin studying, then come to the meet and see how you do. As you study, pray for the Pathfinders who are studying this same material. Ask God to bless them as they devote their time to the study of His word. Ask God to help them stay faithful in their daily study.

If you would like more information about this year's PBE teams, and how you can help support and encourage our youth, email evergreenpathfinders@gmail.com.

If you would like to help sponsor our PBE teams with the costs of the trip to this year's Division Final, you can indicate PBE on the tithe envelope. ■

Ryan Clough is the Assistant TLT Director & PBE Coach of Evergreen Pathfinder Club.

SUPPORT THIS MINISTRY

Please write
"PMC Operating Expense"
 on your tithe envelope.

WE WORSHIP

CONNECT • GROW • SERVE • GO

Opening Voluntary

Jesus Calls Us • Emma Lou Diemer

Introit

Turn Your Eyes Upon Jesus • Helen Lemmel

Call to Worship

Sabine Vatel

The God who made the world and everything in it give life and breath to all.

See what love the Father has for us that we should be called the children of God.

This is his promise: if we believe in the name of his Son, Jesus Christ,

We shall have life and experience it abundantly.

Come, then, let us worship him.

Doxology

Praise God, From Whom All Blessings Flow • 2

Invocation

Brandon von Dorpowski

Hymn of Praise

To God Be the Glory • 341

Congregational Prayer

Jonathan Baker
Lord, Speak to Me • st. 1 of 541

Worship in Music

Stay With Us • Egil Hovland

Children's Story

Linda Mosheti
Kum Ba Yah (Come By Here) • Philip Jones

Introduction to Speaker

Jessica Yoong

Scripture

Genesis 12:1-3 NKJV • Connie Schaffer & Harry Hendrix

Now the Lord had said to Abram: "Get out of your country, from your family and from your father's house, to a land that I will show you.

I will make you a great nation; I will bless you and make your name great; and you shall be a blessing.

I will bless those who bless you, and I will curse him who curses you;

And in you all the families of the earth shall be blessed."

Hymn of Preparation

We Would See Jesus • st. 1, 4 of 494

Sermon

"Letter From Dad" • Brandon von Dorpowski

Tithes & Offerings

Michigan Advance Partners

Hymn of Commitment

Seeking the Lost • 373

Benediction

Brandon von Dorpowski

Closing Voluntary

Partita on DETROIT: Sturdily, With Accent • David Hurd

PRESIDING PASTOR: Sabine Vatel; ORGANIST: Kenneth Logan
WORSHIP IN MUSIC: Journey; Marguerite Samuel, director

MUSIC ALIVE

"PLEADING WITH GOD"

"Come By Here" is the varied plea of the words "Kum Ba Yah" in today's offertory. Today's musical setting, skillfully prepared by Philip Jones, seems to reflect a wide range of emotion, with today's selected variations seeming to move from pensive contemplation to quiet hopefulness to bounding joy exultant richness. Today's closing voluntary is by African-American composer David Hurd (born 1950). Dr.

Hurd was for some 28 years a seminary professor in New York, and has been serving as a church music director in that city. Today's closing voluntary is the last one from Hurd's set of variations on the hymn melody *DETROIT* (hymn 299), often sung with the words "Forgive our sins as we forgive."

WE STUDY

CONNECT • GROW • SERVE • GO

Song Service	Vladimir Slavujevic
Prayer	Medgine Picard
Welcome	Sinegugu Katenga
Scripture	Vivian Raimundo
Special Feature	"Outreach Gospel Cry" • Jamila Sylvester
Offertory	<i>Adagio from Sonata No. 3 • Johannes Brahms</i>
Bible Study	Classes • "I See, I Want, I Take"
Theme Song	<i>Make Me a Blessing</i>

Make me a blessing; make me a blessing.
Out of my life may Jesus shine.
Make me a blessing; O Savior, I pray.
Make me a blessing; to someone today.

"Make Me a Blessing," Ira Bishop Wilson
©1924, Renewed 1952 Word Music, LLC; Used by Permission. CCLI License #392652

Benediction

ORGANIST: Kenneth Logan
OFFERTORY: Carlos Lozano, violin; Rachelle Gensolin, piano

WE WORSHIP 2

CONNECT • GROW • SERVE • GO

As We Begin

Jesus Calls Us • Emma Lou Diemer
Turn Your Eyes Upon Jesus • Helen Lemmel

Praise

Your Grace Is Enough • Give Us Clean Hands • I Give Myself Away

Prayer

Jonathan Baker

Pioneer Life

Adopt a Student / GROW Groups • Nayeli Moretta & Sabine Vatel

Children's Story

Kum Ba Yah (Come By Here) • Philip Jones
Linda Mosheti

Introduction to Speaker

Jessica Yoong

Scripture Reading

Genesis 12:1-3 NKJV • Winter Smith & Gideon Moyo

Worship in Music

Stay With Us • Egil Hovland

Sermon

"Letter From Dad" • Brandon von Dorpowski

Tithes & Offerings

Seeking the Lost • 373

As We Depart

Partita on DETROIT: Sturdily, With Accent • David Hurd

WORSHIP COORDINATOR: José Bourget; ORGAN: Kenneth Logan
ACOUSTIC GUITAR: Teddy Ahn; BASS GUITAR: Chris Wilson; PIANO: Ryan Jarvis
CAJON: LJ Robinson; VIOLIN: Danya Wilson; CELLO: Jeremy Ahn; VOCALS: Letitia Bullard,
Emma Magbanua, Jordanne Howell-Walton, Rebecca Puii Fanai, Jonathan Baker, Kyrk Defino
WORSHIP IN MUSIC: Journey, Marguerite Samuel, director

SUBMIT bulletin announcements by visiting our form online at www.pmcchurch.org/announcements/submit. Requests must be received Monday by 5:00 PM for consideration.

NEXT WEEK'S OFFERING
PMC Operating Expense

SUNSET TODAY • 5:35
SUNSET NEXT FRIDAY • 5:43

PIONEER PULPIT

| 01 • 20 |

ELIZABETH TALBOT
"His Assurance"

| 01 • 27 |

DWIGHT K. NELSON
"Tell Your Heart to Beat Again"

FINANCIAL FEATURE

MICHIGAN ADVANCE PARTNERS

Michigan Advance Partners (MAP) recently helped Battle Creek Academy (BCA) with significant renovations. There were classrooms that had been built in 1947. The rooms were gutted and all asbestos was removed. Then new cabinetry was installed, the walls were painted, and carpet was laid. MAP funds allowed them to purchase new tables and chairs for each of these rooms. Now, when members of the community come to tour the school, they are impressed by the classrooms, as well as the welcoming environment of the campus. Their enrollment increased!

Visitors' Dinner

Join us today after second service in the PMC Commons (downstairs) for a home-cooked vegetarian meal.

Family Vespers

TODAY • 5:00 PM
YOUTH CHAPEL

Come and receive a blessing as we praise God at the close of this Sabbath.

Grief Share Support Group

TOMORROW • 4:00 PM
VILLAGE SDA CHURCH, FIRESIDE RM.

A new support group for anyone who has lost a loved one is available at the Village SDA Church. To seek additional information or to register call Shirley Gammon at 989.427.5669 or Linda Pellandini at 517.243.2767

Office Closed

The PMC office will be closed on Monday, January 15 for the Martin Luther King, Jr. holiday. We will re-open at 8:00 AM on Tuesday, January 16.

Adventist Forum

JANUARY 20 • 3:30 PM
GARBER AUD., CHAN SHUN HALL

Dr. Julia Kim will present "A Linguist's Reading of the SDA Church's Debate on Women's Ordination."

Speaking as a Dragon? Religious Liberty & Biblical Justice Today

JANUARY 27 • 3:30 PM
NEWBOLD AUDITORIUM
BULLER HALL

Join us for this presentation by the General Conference Director of Public Affairs and Religious Liberty, Dr. Gaunoune Diop. Musical numbers will be performed by Journey and a panel of experts in law, prophecy, and ministry will discuss if America speaks as a dragon today.

Winter Camp for the Blind

FEBRUARY 4-9
CAMP AU SABLE

Volunteers are needed for the Michigan Winter Camp for the Blind. If you are able to help, please contact Larry Hubbell at 248.459.3165 or 248.634.4379.

Honduras Mission Team

The PMC Youth Mission team to Honduras has returned with much thanks for God's blessings and your support. Scott Schalk directed the day camp team as they conducted a Friendship Camp with 90-120 kids attending each day. Additionally they ministered at the Hogar de Niños children's home operated by REACH International as well as distributed clothing and lots of food to over 30 neighborhood families in the community around the Hogar. Last Sabbath, they presented a live 90 minute television broadcast for the main television station in Santa Barbara, Honduras. To God be the glory, great things he has done. For more information contact Glenn Russell (glenn@andrews.edu).

GROW Groups!

Thinking about leading a GROW Group between February 18 to April 29? Here are just a few ideas for activities or themes to hopefully inspire new ideas: hammocking, paying your student debt, single dads, speaking other languages, learning ASL, random acts of kindness, cooking on a budget, buying your first home, engaged—now what? And many more. To be included in the Spring 2017 semester catalog, sign up your group at www.pmchurch.org/grow and help others GROW new friendships with God and each other. Questions? Contact Pastor Sabine or Gracie Gaytan via growgroups@pmchurch.org.

Join Our Team

PMC is currently seeking candidates for the following positions:

Graphic Designer
Administrative Assistant/Receptionist
Custodian

For more information and to apply visit www.pmchurch.org/employment.

"Adopt" an Andrews Student in 2018!

Are you a Pioneer member, family, or GROW Group with a burden to help transform this generation and make disciples? Are you willing to offer spiritual support, encouragement, occasional care packages, and the feeling of home to a University student starting next semester? An instructional packet on your "adoptee" will be made available on Sabbath January 13, 2018. For more information, contact Pastor Sabine (vatel@pmchurch.org or 269.471.6153).

Septura in Concert

FEBRUARY 4 • 7:00 PM

HOWARD PERFORMING ARTS CENTER

Septura brings together London's leading players to redefine brass chamber music through the uniquely expressive sound of the brass septet. In music for voice and piano, Septura explores a great transatlantic relationship between Maurice Ravel and George Gershwin, whom despite their vastly contrasting musical worlds of French impressionism and American jazz, developed a deep mutual respect for each other. Septura will open the concert with Ravel's Mother Goose, charting a course from Fauré's *Mélodies* and moving on to Gershwin's *Songbook*. They will perform Gershwin's *Three Piano Preludes* and close with *An American in Paris*, especially arranged for brass and solo car-horns.

Thank You

To the many participants who "adopted" families for Christmas, gave gift cards, and made donations to help families who were in need of some support during this Christmastime, WE THANK YOU! We were able to provide Christmas support to 23 student families. We appreciate each participant and your expressions of caring brought joy and feelings of support to many households. A special thanks to Christine Schwer who also assisted with this project.

-Deby Andvik & Carmelita Arthur

Family Prayer Needs

If you have a prayer request or change to the Family Prayer Needs list, please contact the church clerk at clerk@pmchurch.org, or call 471.3133

We Mourn

We are deeply saddened to learn of the death of J. Grady Smoot, President of Andrews University from 1976-1983, who passed away on Friday, January 5, 2018. Currently, there are two services being planned... one in Pittsburg, Kansas and one in Wisconsin. We are also deeply saddened to learn of the death of Warren Popp, father-in-law of Tari (Doug) Popp, who passed away Monday morning, January 8, at his home. Funeral services will be held on Sabbath, January 13, at 2:30 PM, at the Village Church. With both families we pray, "Come Soon, Lord Jesus."

Mommy (and Daddy) & Me

RESUMES JANUARY 17

This is a fun group for kids (0-5 years old) and their parent or caregiver to enjoy friendships and activities together. Each week will include playtime, songs/stories, and crafts. Come make new friends and have fun with your children!

Nominating Committee

FIRST READING

Elder

Heaven Shin

Assistant Head Elder

Denis Kaiser

Angelika Kaiser

More Announcements

For more PMC and community announcements, please visit our website at www.pmchurch.org/announcements. Requests must be received Monday by 5:00 PM for consideration.

| PASTORS |

Chaplain / Pioneer

José Bourget • 471.6254
bourget@pmchurch.org

Discipleship / GROW Groups

Sabine Vatel • 471.6153
vatel@pmchurch.org

Harbor of Hope

Taurus Montgomery • 269.210.6155
montgomery@pmchurch.org

Lead Chaplain

June Price • 471.6282
juneprice@andrews.edu

Lead Pastor

Dwight K. Nelson • 471.3134
nelson@pmchurch.org

Pastoral Care

Don Dronen • 471.3133
dronen@pmchurch.org

Stewardship

Sharon Terrell • 471.6151
terrell@pmchurch.org

This Generation Evangelism

Rodlie Ortiz • 471.6154
ortiz@pmchurch.org

Youth Ministries

Ben Martin • 471.6176
martin@pmchurch.org

Media Ministries

Richard Parke • 471.3246
parke@pmchurch.org

Music

Kenneth Logan • 471.3231
logan@pmchurch.org

| STAFF |

Admin. Assistant

Lailane Legoh • 471.3543
legoh@pmchurch.org

Admin. Assistant / Clerk

Gracie Gaytan • 471.3133
clerk@pmchurch.org

Receptionist

Jackie Bikichky • 471.3133
bikichky@pmchurch.org

Assistant Media Director

Gaddiel Zelaya Martínez • 471.3678
zelaya@pmchurch.org

Assistant Treasurer

JoAnn Siagian • 471.7656
siagian@pmchurch.org

Executive Assistant

Claudia Sowler • 471.3134
sowler@pmchurch.org

Graphic Designer

471.3647
bulletin@pmchurch.org

Maintenance

Larry White • 471.3649
white@pmchurch.org

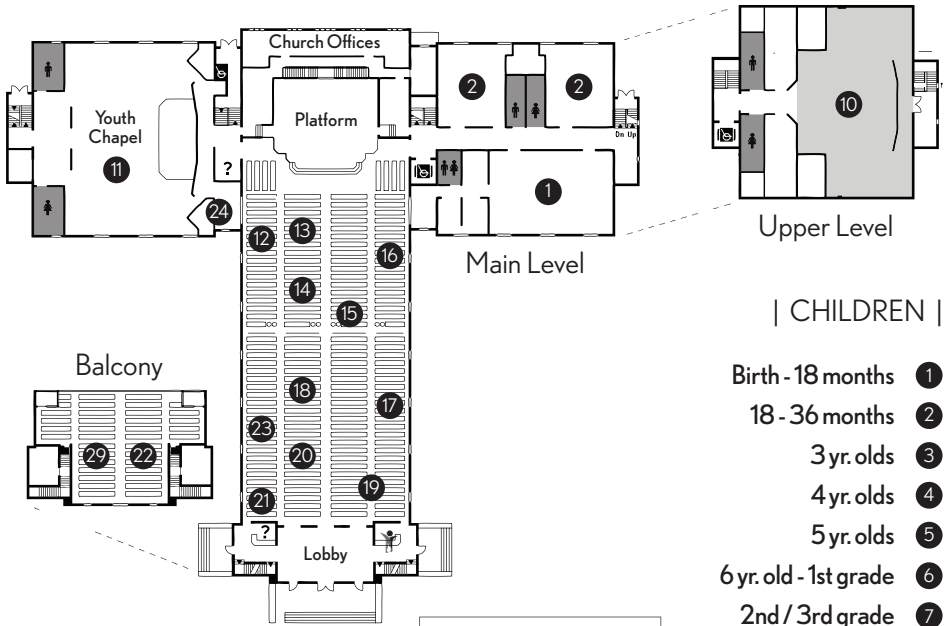

| CHILDREN |

- Birth - 18 months ①
- 18 - 36 months ②
- 3 yr. olds ③
- 4 yr. olds ④
- 5 yr. olds ⑤
- 6 yr. old - 1st grade ⑥
- 2nd / 3rd grade ⑦
- 4th grade ⑧
- 5th / 6th grade ⑨
- Earliteen ⑩
- Youth ⑪

| ADULT |

- ⑫ Group 1
- ⑬ Group 2 (Portuguese/Brazilian)
- ⑭ Group 3
- ⑮ Group 4 (Yugoslavian)
- ⑯ Group 5
- ⑰ Group 6
- ⑱ Group 7
- ⑲ Group 8
- ⑳ Group 9 (Spanish)
- ㉑ Group 10
- ㉒ Group 11 (Balcony)
- ㉓ Group 12 (French)
- ㉔ Conference Room
- ㉕ Something In Common
- ㉖ Young Adults
- ㉗ SDA Beliefs

| KEY |

- ? Welcome Centers
- E Elevators
- Restrooms
- Children's Activities & Lending Library

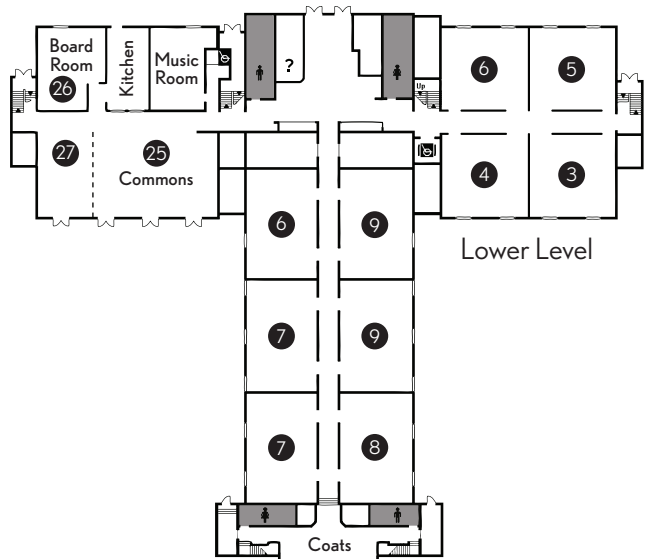

[illegible]

- 28 H&M (Hispanic - Religion Amphitheater)
- 29 People on the Move (PMC)
- 30 University Sabbath School (Dining Services)
- 31 Compass Sabbath School (Buller - Religion Dept.)

32 N108 (Collegiate)
N110
N120 (New Life Church Choir)
N150
N211 (Small Group)
N235
N310 (Russian)
N335 (Spanish)
S340 (Upper Room)

- 33 Main Lounge
- 34 Faculty Lounge
- 35 Back to Basics
- 36 Living Word Fellowship
- 37 Current Events (Nethery Hall-134)
- 38 Bible Journey (Nethery - 143)

TRANSFORMING
THIS **GENERATION**



CONNECT·GROW·SERVE·GO