

PIONEER MEMORIAL CHURCH

CHARISMATIC CONFUSION

THREE ANGELS, ONE WARNING: Charismatic confusion may cause fuzzy thinking, mindless worship, careless living—if experiencing these symptoms, return immediately to reverencing God.

OCTOBER 13, 2012

9:00 AM // PAGE 10 — 11:45 AM // PAGE 13

WELCOME!

"The falling leaves drift by my window" is neither great poetry nor grand hymnody. But surrounded as we are by this most glorious of seasons (beauty is in the eye of the beholder), you can't help but celebrate the goodness of a God, who even in the face of changing weather, splashes golden hues of His glory across the landscape of autumn. It's the providence of divine grace and the grace of divine providence. Taking our "falls" and setting them ablaze with the colors of Calvary's grace. "If anyone is in Christ, he is a new creation" (2 Corinthians 5:17). No wonder we have every reason in the Book to celebrate in God's presence this Sabbath of fall! Welcome to worship at Pioneer.

FIND IT HERE

PAGE FOUR

Church Reports

PAGE NINE

Financial Report

PAGE TEN

Pioneer One

PAGE TWELVE

Sabbath School

Pioneer Two

PAGE FOURTEEN

Pioneer People

Announcements

PAGE EIGHTEEN

AA Alumni Reunion

PAGE TWENTY

Sabbath School Directory

PAGE TWENTY-TWO

Contacts

THE FOURTH WATCH

WWW.PMCHURCH.TV

NO LONGER THE MAJORITY

The internet and wire services have been abuzz with this week's national survey report from Pew Forum on Religion & Public Life. "For the first time in this nation's history, the United States does not have a Protestant majority" (<http://news.yahoo.com/report-us-protestants-lost-majority...>). The new study reports that Protestant adults now comprise 48% of the nation. And apparently nobody is surprised. After all, for the first time there are no Protestants on the U.S. Supreme Court or on the Republican presidential ticket.

So what's the big deal? Among other demographic notables contributing to this decline in Protestants, Pew researchers report "a spike in the number of Americans who say they have no religion." That's an increase from 15% to 20% of the populace over the last five years.

Continued on 7

REVIVAL & REFORMATION

GOD IS INDEPENDENT

With all the political ads, speeches, and debates over the next month, let us remember that unlike our own political leanings, God is actually an Independent. It matters not what our own view of the election outcome should be—whether Republican, Democrat, Independent, Whig, Bull Moose, or Green Party! As Christians, we are citizens of the Kingdom of God and our worldview, lifestyle, and daily interaction with those around us proclaim that God is in control of world events. We need not fear if the opposite candidate from our choice is elected. God will work His purposes in bringing this world to the final events described in Scripture no matter who is in charge.

Daniel stated the same concept 2500 years ago: “Blessed be the name of God, forever and ever. *He knows all, does all: He changes the seasons and guides history, He raises up kings and also brings them down*, he provides both intelligence and discernment, He opens up the depths, tells secrets, sees in the dark—light spills out of him!” Daniel 2:20-22 [*The Message*]

Even King Nebuchadnezzar got the message when He said: “Then I praised the Most High; I honored and glorified him who lives forever. His dominion is an eternal dominion; his kingdom endures from generation to generation. All the peoples of the earth are regarded as nothing. *He does as he pleases with the powers of heaven and the peoples of the earth.*

No one can hold back his hand or say to him: ‘What have you done?’...Now I, Nebuchadnezzar, praise and exalt and glorify the King of heaven, because everything he does is right and all his ways are just.” Daniel 4:34,37 [NIV]

Please pray:

- For our leaders and electorate, that God will influence decisions, events, and elections for His honor, glory, and purposes.
- That God will guide each of us to know for ourselves how we should vote, or even not vote if that is His will.
- For a neighbor and all the other people they represent, and how you might be led to speak, make acquaintance, encourage, or witness to them.
- For any non-Christian student that you know and all the other non-Christian students on campus they represent.
- For a specific department or entity either at the university or in the church, and for the other departments with problems that are unknown.
- For those whose spouses have recently passed away, that God will bring comfort, and that new friendships and support will be found.
- For the Seminary students taking comprehensive exams on Mondays until October 29.
- That God will bless those who are not able to come to House of Prayer.

OPERATING FUND

PATHFINDERS / FALL CAMPOREE



The month of September ushered in a beautiful autumn—perfect weather for the Michigan Pathfinder Camporee held at Camp AuSable on September 14-16. Our PMC Evergreen Pathfinders with 58 other Michigan Pathfinder clubs gathered together to sleep in tents, sing around campfires, prepare and eat meals outdoors, hike, play, and worship.

"We took 59 Pathfinders and 22 staff to the camporee," reported Kathy Capps, co-leader of the club. "The spirit of this camporee was the best I've ever seen. The cooperation of everyone was outstanding." Evergreen Pathfinders marched to every meeting—a new

practice at camporees. They made friends as they mingled with other clubs and participated wholeheartedly in all the team-building events. Jonathan Logan and Wade St. Martin placed first in their division at the 5K Sandy Skedaddle, a run/walk event. Richard Aguilerra (the Mud Guy), who writes for the *Guide*, focused on controversial topics like creation versus evolution. One of Andrews University's Biology professors, Dr. Gordon Atkins, thrilled campers with his powerful presentation on whales. Craig Harris, Michigan Pathfinder Youth Director, encouraged the young people to develop a trusting relationship with Jesus.

The Pathfinder Club is a worldwide organization training youth grades 5-10 and youth leaders grades 11-12. Pioneer Memorial Church has had a Pathfinder Club for the last sixty years and is the oldest, continually-existing Pathfinder Club in Michigan. Check out our display board in the lower level middle hall of our church. If you have a child you would like to enroll or want more information about Pathfinders, you can contact Kathy Capps.

PRAY

That our Pathfinders will continue
to grow in Jesus

MORE INFO

Joe & Kathy Capps / 815.5090
pathfinders@pmchurch.org

OPERATING FUND

GIVE TO LINE 2

Goal to-date	\$469,240
Received to-date	\$416,226
(Received to-date 2011)	\$414,795

As of October 6, 2012

MASTER PLAN OF EVANGELISM

MPE / OUR BAPTISMAL NUMBERS HAVE DOUBLED!

One thing that never gets old, is meeting with people who have made a decision to be baptized. It is the most fulfilling thing I do as a pastor. However, a small issue has come up—actually, it's one of those great problems to have. We are having so many requests for baptism that I'm not able to personally follow up with all of them. I have had to draft other pastors and trained members just to keep up with the requests.

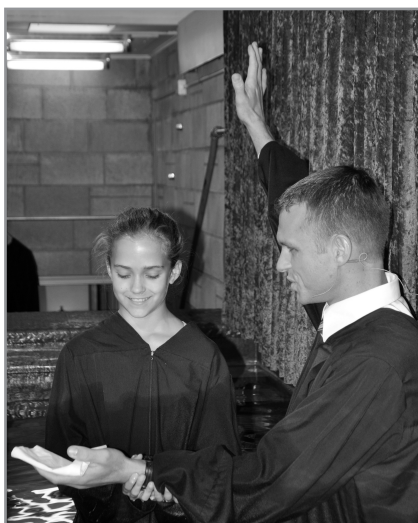

Where has the uptick in baptisms come from? What has made the difference? It's all about the Holy Spirit working through the weekly Connect Card. We challenge people to take a next step and then we do everything we can to create a simple way to respond to God's prompting. For some, that is baptism. For others, it is renewing a commitment they made years ago. Still for others, it may be a reminder that we are all called to take the gospel to the world. To give some perspective on how God has been working, I recently saw the exact number of baptisms that we had last year: 38 for 2011. We praise God for every single one of those. For this year, up to the point of this writing, we have a total of 55 people who have been baptized, and we're looking to baptize about 20 more before the end of the year.

That is where you come in. Your prayers and financial support of line 5, Master Plan of Evangelism, enable this simple system of next steps. Thank you for your faithful giving to MPE.

PRAY

That people will continue to make decisions for Jesus

MORE INFO

Rodlie Ortiz / 471.6154
ortiz@pmchurch.org

MASTER PLAN OF EVANGELISM GIVE TO LINE 5

Goal to-date	\$103,080
Received to-date	\$82,070
(Received to-date 2011)	\$96,635

As of October 6, 2012

CHRISTIAN EDUCATION

RMES / TRAINING AND TEACHING

Family worship at home is vital. It teaches children about Jesus' love as seen through their parents and passed down to them. It shows them consistency in knowing that a relationship with Christ isn't a once a week thing, but an everyday, 24/7 kind of friendship. Praying and being open about a love for Jesus begins in the family circle. But what happens when the child walks out of the home and into the classroom? Do they still have such opportunities to witness and share His love? Our answer is a resounding Yes!

At Ruth Murdoch Elementary School we are training and teaching the next generation of church leaders. As early as Kindergarten our students are encouraged to pray, lead out in song service, and recite Scripture in front of a group. They can daily share Christ's love in a variety of ways. Young people can participate in classroom worship, Jr. High chapel, and our all-school assemblies where they lead approximately 300 people in worship and praise. We teach them how to give Bible studies and encourage

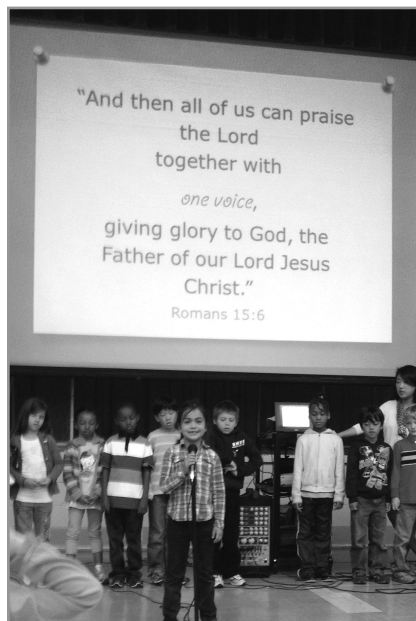

them to serve as junior deacons and deaconesses in their local churches. These leadership skills will equip them to serve and lead throughout their lives. When considering the future of the church, do not forget the important work that is being done at RMES. We thank you for your faithful support and prayers!

PRAY

For the next generation of
church leaders

MORE INFO

David Waller / 471.3225
waller@andrews.edu

CHRISTIAN EDUCATION GIVE TO LINE 3

Goal to-date	\$180,240
Received to-date	\$152,669
(Received to-date 2011)	\$159,462

As of October 6, 2012



i.e., one out of every five Americans declares “none” when asked to describe their religious affiliation.

Is America destined to follow Western Europe into a burgeoning secularism? Over recent years church attendance on that continent has plummeted, leading Pope Benedict XVI to convene this week a three-week synod of bishops from around the world, “aimed at bringing back Roman Catholics who have left the church.” It is clear from Pew research that in the U.S. Protestants, Catholics and Christianity in general are facing a major challenge in retaining their adherents.

So what does that mean for a university congregation like ours? Pew finds that “one-third of adults under age 30 have no religious affiliation, compared to 9% of people 65 and older.” That means that the demographic slice of young adults represented by this university is the least likely to pursue religious affiliation. But that does *not* mean this one-third is godless. To the contrary the Pew category of unaffiliated “encompasses majorities of people who say they believe in God, and a

notable minority who pray daily or consider themselves ‘spiritual’ but not ‘religious.’”

So what will it take for young-on-young or older-on-young to reach them? Isn’t the strategy Jesus modeled the most effective one for us, too? “The Saviour mingled with [people] as one who desired their good. He showed His sympathy for them, ministered to their needs, and won their confidence. Then He bade them, ‘Follow Me’” (*Ministry of Healing* 143). For a generation increasingly distancing itself from formal religion, Jesus’ method of growing friendships with those He wanted to reach makes sense, doesn’t it? Drop in on their dorm room, join them at the cafeteria, engage a conversation around their interests, put them on your prayer list, invite them to join you—i.e., set out to win their friendship. Because apparently it’s always been true—the “nones” and the “unaffiliated” will say “yes” to your friendship while they say “none” to your religion. So I say, like Jesus let’s go for the “yes” first—then the “none” will follow.

WANT TO MAKE THE MOST OF A CHARITABLE DONATION? TAKE IT TO THE BANK.

1. Supply food for needy Andrews University students.
2. The entire donation is credited to PMC at Southwest Michigan's Food Bank, and you receive a tax-deductible receipt.
3. NOTE: To receive the tax benefit, and for PMC to get the credit, you must use the donation envelope provided at the Welcome Centers at PMC. Checks should be made out to Feeding America West Michigan and account number 40108 written on the memo line.

A large, black and white photograph of a variety of grocery items, including cereal boxes (Kellogg's, Wheat Chex, Triscuits), snack bags (Lays), canned goods (mesquite beans), and fresh produce (bananas, grapes). The items are densely packed together, showcasing a wide range of food products.

SEPTEMBER 30 FINANCIAL REPORT

OUR CHURCH FAMILY FINANCES

	Goal 9/30/12	Rec'd 9/30/12	Rec'd 9/30/11
PMC Operating Expense	\$457,509	\$402,475	\$401,256
Christian Education (line 3)	175,734	148,287	155,632
Master Plan for Evangelism	100,503	79,253	94,492
Building Improvement	37,518	28,113	28,021
Student Aid	13,754	13,460	11,546
Total	785,018	671,588	690,947

BY FINANCE COMMITTEE CHAIR, DON WILSON

The final chapter of Revelation provides one last glimpse of the purity that surrounds the throne of God. An urgent appeal is made to be diligent, faithful, and true to His calling. Twice the warning is given, "Behold, I am coming quickly" and then a final affirmation, "Surely, I am coming quickly." The turmoil and darkness blanketing the earth will be replaced by an eternal Light that will forever remove every curse and shadow of night.

The gospel hymn *Work for the Night Is Coming* describes the opportunity and yet urgency of working through the morning, the sunny noon, under a glowing sun, and into the sunset skies. Labor while the dew sparkles amid spring flowers, for the sun will fade and shine no more. Yes, work

every flying minute, while the night is darkening, for soon rest comes and work is no more.

The accompanying financial report reflects our church family finances as of September 30. Thank you for your continued faithfulness. As we approach year end, please pray for the ministry of PMC and for a unity of purpose in Christ. Then join me in praying for a purity of heart that will enable our individual resources to be effectively used to finish His work.

Today we sense that night is coming, that the looming darkness will bring all work to an end. Yet we labor not without the Hope of a new dawn, for Jesus proclaims, "I am ... the Bright and Morning Star." Then the invitation, "Come" and work with Me for the night is coming.

"...and worship him..."

...in seeking

Opening Voluntary	<i>A Hymn Tune Rhapsody / J. Brubaker</i>
Introit	<i>Now Thank We All Our God / Johann Crüger</i>
Invocation	Dwight K. Nelson

...in praising & praying

Hymn of Praise	<i>Immortal, Invisible, God Only Wise / 21</i>
Congregational Prayer	Don Dronen
Worship in Music	<i>When the Stars Began to Fall / Fredrick Allen</i>

...in learning

The Word	Revelation 11:15-19 NKJV / Tiffany & Rodney Summerscales
Children's Offering	<i>Come, Thou Fount of Every Blessing / John Vinson</i>
Children's Story	
Hymn of Preparation	<i>I Sing the Mighty Power of God / 88</i>
Sermon	"Three Angels, One Warning: Charismatic Confusion" Dwight K. Nelson

...in connecting & committing

Connect Card, Tithes, Offerings	Voice of Prophecy
Hymn of Commitment	<i>God the Omnipotent / 84</i>

...in going

Benediction	
Closing Voluntary	<i>Bless the Lord, O My Soul / Charles Wood</i>

PRESIDING PASTOR: Don Dronen; ORGANIST: Kenneth Logan
WORSHIP IN MUSIC: Andrews Academy Concert Band, Byron Graves, director

Then the seventh angel sounded: And there were loud voices in heaven, saying, "The kingdoms of this world have become *the kingdoms* of our Lord and of His Christ, and He shall reign forever and ever!" And the twenty-four elders who sat before God on their thrones fell on their faces and worshiped God, saying: "We give You thanks, O Lord God Almighty, The One who is and who was and who is to come, Because You have taken Your great power and reigned.

The nations were angry, and Your wrath has come, And the time of the dead, that they should be judged, And that You should reward Your servants the prophets and the saints, And those who fear Your name, small and great, And should destroy those who destroy the earth."

Then the temple of God was opened in heaven, and the ark of His covenant was seen in His temple. And there were lightnings, noises, thunderings, an earthquake, and great hail.

MUSIC ALIVE

THE FOUNT

"Come, Thou Fount of Every Blessing," opening worship today, is by Robert Robinson. English-born, he lost his father when he was eight. When a middle teenager he was associated with a notorious gang known for their debauchery in London. At 17, he went to hear preacher George Whitefield to scoff "at the poor, deluded Methodists." However, Whitefield's evangelistic preaching was instrumental in swaying

him to the contrary. A few years later he entered the preaching ministry. He wrote the words of "Come, Thou Fount" when he was 23. It exists in various versions, not always including "my Ebenezer," a somewhat-obscure biblical reference symbolizing God's faithfulness. I Samuel 7:12 says, "Then Samuel took a stone, . . . and called the name of it Ebenezer, saying, Hitherto hath the LORD helped us."

TRANSFORMING
THIS GENERATION



CONNECT · GROW · SERVE · GO

SABBATH STUDY

SANCTUARY 10:30 AM

Song Service	Christina Carroll
Opening Hymn	<i>For All the Saints</i> / 421
Welcome, Scripture, and Prayer	Philip Giddings III
Special Feature	The Sound of Music—Don't Leave This Planet Without It / Byron Graves / RMES & Andrews Academy
Offertory	<i>Softly and Tenderly Jesus Is Calling</i> / Robert Hobby
Bible Study	"Revelation, and the God Revealed in It" / Classes
Theme Song	<i>Make Me a Blessing</i>

*Make me a blessing; make me a blessing.
Out of my life may Jesus shine.
Make me a blessing; O Savior, I pray.
Make me a blessing; to someone today.*

"Make Me a Blessing," Ira Bishop Wilson

©1924, Renewed 1952 Word Music, LLC; Used by Permission. CCLI License #392652

Benediction	Christina Carroll
--------------------	-------------------

ORGANIST: Kenneth Logan

OFFERTORY: Brenton Offenback, organ

[see page 20/21 for Sabbath School directory & map]

HEALTH AND WELLNESS EVENTS

FOR MORE INFORMATION CONTACT PAUL & SHELLI MEULEMANS

CALL: 269.277.3621 **E-MAIL:** health@pmchurch.org

WEBSITE: www.pmchurch.org/health

ONGOING EVENTS:

Exercise classes

- Mondays at 6-7 PM
- Thursdays at 6-7 PM
(PMC Commons)

Running Club

- Sundays at 8 AM
(Meet at PMC Parking Lot)

Walking Club

- Sundays at 8 AM
(Meet at PMC Parking Lot)



Opening Voluntary

Come, Thou Fount of Every Blessing /
John Vinson

Introit

Now Thank We All Our God /
Johann Crüger

Invocation

Songs of Praise

Prayer Garden

Don Dronen

A Witness

Patrick Knighton

Worship in Music

When the Stars Began to Fall /
Fredrick Allen

Message

"Three Angels, One Warning:
Charismatic Confusion"
Dwight K. Nelson

Connect Card, Tithes, Offerings

God the Omnipotent / 84

Closing Voluntary

The Battle of Jericho / Charles Spinney



The Kids Library (in the church lobby) loans quiet activities to young families.

WORSHIP LEADER: José Bourget; PRAISE LEADER: Justin McAuliffe; ORGANIST: Kenneth Logan
WORSHIP IN MUSIC: Andrews Academy Concert Band, Byron Graves, director

PIONEER PEOPLE

SUNSET TODAY: 7:07

SUNSET NEXT FRIDAY: 6:57

To submit a request to have an announcement printed in Pioneer Family Life, please email bulletin@pmchurch.tv. Requests must be received Monday by 5 PM for consideration.

PIONEER FAMILY LIFE

FELLOWSHIP DINNER

Visitors and out-of-town guests are invited to enjoy a home-cooked vegetarian meal following second service in the PMC Commons.

READING THE NEW TESTAMENT

It's never too late to start reading the New Testament or to join the discussion of the readings. The receptionists in the PMC lobby have reading cards that list the daily readings or you can get them on line at <https://sites.google.com/site/anyplaceparish/>. At this same website you can listen to audio recordings made by Seminary faculty, doctoral students, and Religion Department faculty giving introductions to the NT books that we have read. Join the discussion each Sabbath at 10:30 to 11:30 in Nethery Hall Room 143. This week Dr. Ante Jeronic presents on the three epistles of John. Next week Dr. Jacques Doukhan explains the importance of the Old Testament in understanding the book of Revelation.

PMC FAMILY VESPERS

This evening's vespers in the Youth Chapel at 5:30 features the film, "The Encounter," a modern-day parable illustrating the great controversy and Jesus' presence in our lives.

WE MOURN

A memorial service celebrating the life of **Jim Clough** will be held today at 2:30 PM in the PMC Youth Chapel. For those who want to write a memory or story about Jim, please go to www.starks-menchinger.com.

Gerald Alexander, Jamin and Janessa Olney are grieving the death of their wife and mother, **Sandy Alexander**, on Saturday, October 6. Her funeral was on Wednesday, October 10, at PMC.

The University Family mourns the death of **Joseph Warren**, long time English professor. Tomorrow at 1 PM here in this sanctuary we will gather with his wife, Cynthia, and his children Camille, Joseph II, and Jerrick for his funeral service. Family visitation will begin at 11:30 AM.

With all who mourn we cling to the blessed hope of Christ. "Even so, come Lord Jesus."

MOMMY AND ME

Mommy and Me meets every Tuesday at 10 AM in the PMC nursery. Moms and other female guardians with children ages 0-5 are welcome to come play, sing songs, and do other fun activities together.

PIONEER FAMILY LIFE [CONT]

SCRAPBOOKING TOGETHER

Scrapbookers and cardmakers, you are invited to join us tomorrow from 1–5 PM in the Earliteen Loft for the first crop of the school year. Come and enjoy the company of others. We provide refreshments and prizes. No charge. Bring your project to work on and invite your community friends.

PULPIT FLOWERS

The pulpit flowers today are in memory of James Nash, from his loving wife, children and families. We've missed him for 10 years and live each day grateful for the love he shared and life lessons he taught us. We are blessed to hear, even yet, from you—students, colleagues, families, and friends—who were blessed by his life and service. On his gravestone is engraved: "He lived according to Romans 12:9-18." May the Lord bless and keep us until we are all together again!

– *Rosie Nash, Steve and Karen Nash, Shari Smoot, Patricia and David Christel, and the grandchildren*

PIANO CONCERT AND PHOTOGRAPHY EXHIBIT

ArtsBridge presents *Three Pianists Concert and Benton Harbor Photography Exhibit* featuring pianists Jean Prosper, Charlene Jones-Clark, and Marcelo Caceres, and photography by Siobhan Leonard. The exhibit will be at the First Presbyterian Church, 475 Green Avenue on Morton Hill, Benton Harbor, on Sunday, October 14, at 4 PM. Admission is free. Call 269.925.7075 or visit Facebook: First Presbyterian in Benton Harbor for more info.

DINING SERVICES THANKSGIVING DINNER

Andrews University Dining Services would like to cordially invite you to our Thanksgiving Dinner on Thursday, November 22. Seating times will be at 11:30 AM and 2 PM in the Dining Center. For reservations or information, please call 269.471.3161 from 9 AM to 5:30 PM, Monday through Thursday, and 9 AM to 12 PM, Friday.

THANK YOU

Thank you so much for the beautiful flowers and the loving care provided to our family during a very difficult time.

– *Chuck, Dave, Liz, Chris, and Claudia Davisson*

Thank you to the PMC church family and friends for the bright yellow mum plant, the pastoral and friends' visits, and cards. They have brought much cheer to me while I've been recuperating from a broken kneecap. I still have weeks of being home-bound and will continue to enjoy your visits and phone calls. Keep me in your prayers.

– *Ernie Berlin*

JOURNEY FUNDRAISER

Journey (singing group) will be celebrating nine years of ministry with a reunion concert on October 27 at 3:30 PM in the Howard Performing Arts Center. We are doing a fundraiser to help offset costs for the event. If you would be willing to help us in any way, please check out the following website: <http://www.kickstarter.com/projects/30887890/journey-ministries-live-album>.

PIONEER FAMILY LIFE [CONT]

DIAPER DRIVE

One out of four children in Berrien County is born into poverty. Programs like WIC and food stamps don't cover the cost of diapers. From October 1 to November 1, PMC is participating in a Diaper Drive. Diapers dropped off at the church and deposited in the donation box by the Youth Chapel will be given to local food banks, shelters, and home-visiting programs by the Great Start Parent Coalition. Questions, contact Melissa Church at 266.449.6556.

UNITED PRAYER

Students, faculty, and staff—come to United Prayer, Mondays, from 1:30-2:20 PM in the Red Rose Chapel of Buller Hall (every Monday during the semester that classes are held).

BLOOD DRIVE

PMC—October 23 & 24—1 PM to 6:45 PM. Visit redcrossblood.org (sponsor code: AndrewsUniversity) for information or appointment.

MENTAL HEALTH FIRST AID TRAINING COURSE

In partnership with Riverwood Center, Neighbor To Neighbor is offering a 2-day, 12-hour Mental Health First Aid training course on Tuesday and Wednesday, October 30 & 31, from 8:30 AM to 4 PM. A workbook, breakfast, and lunch are included in the registration fee. Participants must attend both days in order to receive a Certificate of Completion. For more information, we can be reached at 269.471.7411.

SABBATH SCHOOL NEEDS

We have the following needs in our Children's Sabbath Schools:

- Beginner (18 months – 3 year old) – Assistant Greeters, Small Group Teachers
- Pre-Kindergarten (3 year old) – Small Group Teachers
- Kindergarten I – Small Group Teachers, Pianist
- Kindergarten II – Small Group Teachers
- Pre- Primary I & II – Small Group Teachers
- Primary I – Assistant Leader, Small Group Teachers
- Primary II – Small Group Teachers
- Junior II – Assistant Leader

These can be weekly commitments or whatever commitment you are willing to give. If interested contact either Rob Barnhurst at g2teen@pmchurch.org; 473.1613, or Glenda Davidson at bg1@pmchurch.org; 471.4170.

OPERATION COATS

Every October, the Women's Service League collects and distributes thousands of free coats to men, women, and children living in Berrien County. A coat drop box is set up outside the youth chapel for you to donate gently used coats and jackets of all shapes and sizes. Last year over 3,000 items were distributed. Any questions, go to www.womensserviceleague.org.

CHILDREN'S CHURCH

Join us today at 5 PM in the Burman Hall Auditorium for a special program. There will be music, skits, puppets, prizes, snacks, videos, and more!

GROWING TRUE DISCIPLES

Opportunities & Challenges in Raising the Next Generation of Believers



WITH DR. GEORGE BARN—George Barna is a Christian Researcher who has held executive positions in advertising, public policy, political campaigns, and media/marketing research. He began his own company, The Barna Group, in 1984. Barna Group is a visionary research and resource company and is widely considered to be a leading research organization focused on the intersection of faith and culture.

Wednesday, November 14 • 3–4:30 PM • HPAC

“Transforming Children Into Spiritual Champions”—Approx. 90 minutes

Among the chief assets of a church are its children. Our approach to their spiritual maturation must be intentional and strategic. This session describes Barna’s research regarding moral and spiritual development, educational strategy, and family-church partnerships, as well as steps that churches and parents may take to buck the culture and raise spiritually mature young people.

BAPTISMAL CLASSES

Classes are beginning at Pioneer for young people. Even if the young person is not sure about baptism yet, they are welcome to join and grow in that direction. Each class will meet weekly for one hour. Please choose as many class time options as work (this allows us flexibility in setting up the classes).

_____ Tuesday, 4:30 PM _____ Wednesday, 5 PM _____ Thursday, 4:30 PM
_____ Tuesday, 6 PM _____ Wednesday, 6 PM _____ Thursday, 6 PM

Name (of young person): _____

Parent/Guardian: _____

Age (of young person): _____

Phone #: _____

E-mail: _____

Return this form to the PMC church office or place it in the offering plate during worship. For more information or questions, contact Pastor Goetz: goetz@andrews.edu—471.6565

*"There is a time for everything
and a season for every activity under heaven."*
Ecclesiastes 3:1

REUNITE REMEMBER RECONNECT

ANDREWS ACADEMY
ALUMNI REUNION
OCTOBER 19-20, 2012



FRIDAY, OCTOBER 19

- | | |
|----------------|--|
| 9:30 a.m.–noon | Alumni Convocation/Career Seminars |
| 12 p.m. | Appreciation Luncheon for
Career Seminar Participants |
| 5–6 p.m. | Alumni Association Assembly |
| 6 p.m. | Registration |
| 6–6:45 p.m. | Continuum Reception |
| 7:30 p.m. | Vespers—Glenn Russell, former faculty |

SABBATH, OCTOBER 20

- | | |
|-------------|--|
| 9 a.m. | Registration (Academy Gym) |
| 9–9:45 a.m. | Continental Breakfast |
| 10 a.m. | Concert by Current AA Students |
| 10:45 a.m. | Alumni Proceedings & Roll Call |
| 11:15 a.m. | Convocation—Machelle Vietz ('88) |
| 12:30 p.m. | Honor Class Photographs &
Alumni Fellowship Luncheons |
| 8 p.m. | Shydepoke—Sylvester Field |

JOIN US FOR A FELLOWSHIP DINNER ▶

Local alumni are asked to provide two generous dishes that serve 12 guests each.
Drop them off when you arrive Sabbath morning, October 20.
Alumni with last names A-L bring entrée/vegetable; M-Z bring entrée/dessert.

GIVE US YOUR NOMINATIONS ▶ Visit: www.andrews.edu/aa/alumni/association/
and share your nominations to fill the soon vacant spots on the Association Committee

QUESTIONS? Please contact our office at 269-471-6140 or acadalum@andrews.edu.
Learn more about this event, and individual class events at: www.andrews.edu/aa/alumni

WHAT DO

hot drinks,
round café tables,
and the Book of Acts

HAVE IN COMMON?



THE NEW HOUSE OF PRAYER

In the Commons (downstairs)

CELEBRATING • CONVERSING • COMMUNING

45 minutes - join us this Wednesday

7 PM • October 17

SABBATH SCHOOL DIRECTORY

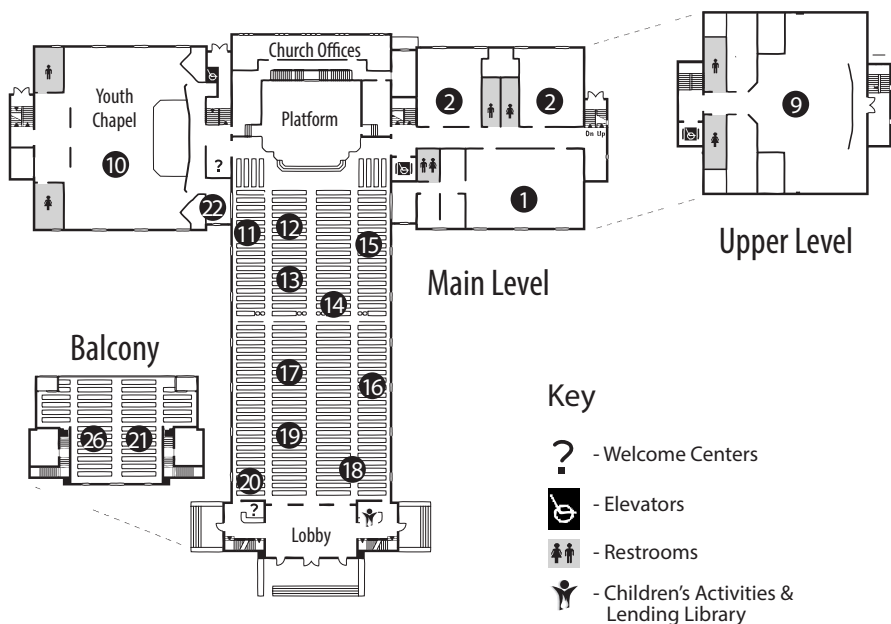

[children]

- ① Birth - 18 months
- ② 18-36 months
- ③ 3 yr olds
- ④ 4 - 5 yr olds
- ⑤ 6 yr old - 1st grade
- ⑥ 2nd/3rd grade
- ⑦ 4th grade
- ⑧ 5th/6th grade
- ⑨ Earliteen: 7th/8th grade
- ⑩ Youth: 9th-12th grade

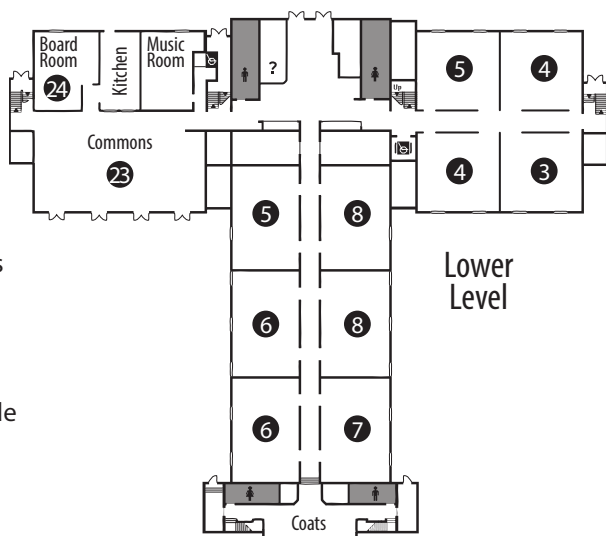

[adult sanctuary]

- [miscellaneous adult]

- ## COLLEGIATE

- ## YOUNG ADULT

SEMINARY GROUPS 28

- ## ADULT @ AU

- ### 33 Current Events
- (Buller—135)

- 21

CONTACTS

PASTORS

[chaplain / pioneer] José Bourget
bourget@pmchurch.org
471.6254

[pastoral care] Don Dronen
dronen@pmchurch.org
471.3133

[youth ministries] Micheal Goetz
goetz@pmchurch.org
471.6176

[discipleship] Esther Knott
knott@pmchurch.org
471.6153

[harbor of hope] Taurus Montgomery
montgomery@pmchurch.org

[senior pastor] Dwight K. Nelson
nelson@pmchurch.org
471.3134

[chaplain / new life] Timothy P. Nixon
nixon@pmchurch.org
471.3212

[chaplain / one place] Japhet De Oliveira
japhet@andrews.edu
471.6282

[this generation evangelism] Rodlie Ortiz
ortiz@pmchurch.org
471.6154

[stewardship] Sharon Terrell
terrell@pmchurch.org
471.6151

MINISTERS

[music] Kenneth Logan
logan@pmchurch.org
471.3231

[media ministries] Nick Wolfer
wolfer@pmchurch.org
471.3246

STAFF

[admin. assistant] Genaida Benson
benson@pmchurch.org
471.6565

[clerk] Jackie Bikichky
bikichky@pmchurch.org
471.3972

[executive assistant] Sherrie Davis
davis@pmchurch.org
471.3134

[asst. media director] Jonathan LaPointe
lapointe@pmchurch.org
471.3678

[admin. assistant] Lailane Legoh
legoh@pmchurch.org
471.3543

[graphic designer] Rachelle Offenback
bulletin@pmchurch.tv
471.3647

[assistant treasurer] JoAnn Siagian
siagian@pmchurch.org
471.7656

[maintenance] Larry White
white@pmchurch.org
471.3649

MINISTRIES

[adventurers] Kathy Capps
adventurers@pmchurch.org
815.5090

[deacons] Milan Vajdic
deacons@pmchurch.org
471.0328

[deaconesses] Vida Giddings
deaconesses@pmchurch.org
473.2175

[elders] Russell & Cynthia Burrill
elders@pmchurch.org
473.3738

[health] Paul & Shelli Meulemans
health@pmchurch.org
277.3621

[pathfinders] Joe Capps
pathfinders@pmchurch.org
815.5090

[public address] Joel Kitchen
audio@pmchurch.org

[small groups]
smallgroups@pmchurch.org

SABBATH SCHOOL

[birth - grade 1] Glenda Davidson
bg1@pmchurch.org
471.4170

[grade 2 - earliteen] Robert Barnhurst
g2teen@pmchurch.org
473.1613

[adult] Elizabeth Wilson
adultss@pmchurch.org
269.782.8923

OUR SCHOOLS

[ruth murdoch / K-8] David Waller
waller@andrews.edu
471.3225

[andrews academy] Robert Overstreet
overstrr@andrews.edu
471.3148

[andrews university]
enroll@andrews.edu
471.7771 / 800.253.2874

PMCHURCH MEDIA

TELEVISION

WHME TV 46
Sunday noon & midnight

SAFE TV, HOPE CHANNEL & 3ABN
See websites for local listings
www.safetv.org
www.hopetv.org
www.3abntv.org

LIVE VIDEO STREAMING

11:45 AM — www.pmchurch.tv

ONLINE

www.pmchurch.org
www.pmchurch.tv

RADIO

WAUS - 90.7 FM
Sabbath 11:30 a.m.



8655 UNIVERSITY BOULEVARD,
BERRIEN SPRINGS, MI 49103
PHONE 269.471.3133 – FAX 269.471.6152

UNIVERSITY VESPERS

FRIDAY @ 7:30 PM, PMC SANCTUARY

We want to invite you to be a part of this experience to rest, revive, and reconnect.

10.19.12	University Vespers
10.26.12	Keith Mattingly
11.2.12	Timothy Nixon
11.9.12	Damien Chandler
11.16.12	Bill Knott
11.30.12	Christmas Choral Concert HPAC at 7 PM
12.7.12	Feast of Lights

COMING SOON

10/20

Dwight K. Nelson
"Three Angels, One Warning:
Babylonian Confusion"

10/27

Evan Knott
"The Way of the Water"

