

# PIONEER CONNECT

AUGUST 5, 2017





# WELCOME

*to Pioneers*

Welcome, AU graduates. We wish you the Lord's blessing this graduation weekend. And welcome students, visitors, and members to our worship service. May you experience rich blessings of comfort, joy and inspiration.

*—Don Dronen*

 <b>PIONEER MEMORIAL CHURCH</b> 8655 UNIVERSITY BOULEVARD, BERRIEN SPRINGS, MI 49103		
<b>OFFICE HOURS</b> Monday – Thursday (8 to 5) • Friday (8 to 12)		<b>PHONE</b> – 269.471.3133 <b>FAX</b> – 269.471.6152
<b>LIVE STREAMING</b> <a href="http://www.pmchurch.org">www.pmchurch.org</a> Sabbath 11:45 AM	<b>ONLINE</b> <a href="http://www.pmchurch.org">www.pmchurch.org</a> <a href="http://www.newperceptions.tv">www.newperceptions.tv</a>	<b>RADIO</b> WAUS – 90.7 FM Sabbath 11:30 AM
 <b>NOMINATING REPORT</b> Scan this code to view the most recent Nominating Committee Report.		 <b>FIND A SABBATH SCHOOL</b>

# FIND IT HERE

CONNECT • GROW • SERVE • GO

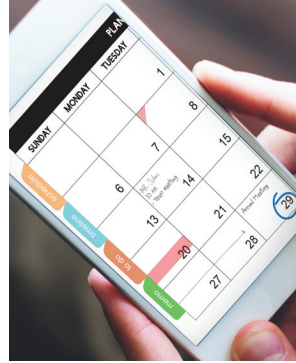

---

**4**

**PIONEER LIFE**  
The Health Tent 2017

---

**8**

**SABBATH SCHOOL**  
The Priority of the Promise

---

**12**

**SABBATH VESPERS**  
8:30 PM Vespers

---

**6**

**WE WORSHIP**  
9:00 AM Service

---

**9**

**BACCALAUREATE**  
11:45 AM Service

---

**13**

**CONTACTS**

---

**10**

**ANNOUNCEMENTS**

---

**14**

**SABBATH SCHOOL  
DIRECTORY**

---

# THE HEALTH TENT 2017

BY KATHERINE KOUDELE

**F**or more than 40 years, the Health Tent at the Berrien County Youth Fair has been providing its visitors with information about how to live healthier lives. The Tent is a joint effort of the Seventh-day Adventist churches in southwestern Michigan (District 9). With attendance at the one-week fair reaching an impressive 125,000 visitors, it is an unparalleled opportunity to show our friends and neighbors that our church is filled with folks who care about them.

In past years, visitors to the Health Tent were offered a relatively lengthy, in-depth screening with our volunteers. Among other services, visitors were given a health age survey, body mass index calculations were assessed, and volunteers offered demonstrations as well as individual counseling. In the past we've had 3,000 visitors stop by the Tent during Fair Week. But last spring a steering committee of health ministry leaders from many District 9 churches envisioned a bold, new goal for the Tent this year: double the number of visitors to 6,000. In order to do this, the format of the Tent needed to be reimaged to allow for quick, 30-60-second interactions. So, the committee has developed five fun, fair-like activities for this year and opened up the entire front of the Tent for easier access.

## 1 AUTOMATIC BLOOD PRESSURE AND HEART RATE MEASUREMENT

Visitors can have their blood pressure and heart rate taken, then go for a ride on the midway, and then return

to see how it has changed. They can also sign up for a drawing for a \$25 gift certificate from Apple Valley, or Dr. Wes Youngberg's book, *Good bye, Diabetes*.

## 2 FACE SCANNING

Visitors will look at their faces in a black-light box and get a sense of the damage sun-exposure has done to their skin. The experience can be eye-opening!

## 3 GRIP STRENGTH TESTING

Research has shown that those who have good upper body muscle strength are better able to live independently and care for themselves. Also younger folks will enjoy the competition to see who has the best grip!

## 4 DRUNKEN GOGGLES EXPERIENCE

When wearing these goggles, one gets the sensation of being legally intoxicated. While it may be amusing to see your friends struggle to walk a straight line, it is sobering to realize the risk of driving while impaired, or riding with drivers who are.

## 5 DENTAL DISCLOSING TABLETS

Tuesday of Fair Week is Kids' Day when those under 18 years old get in for free. Needless to say, it is the busiest day of the Fair. Kids who stop by the Tent can chew dental disclosing tablets which show how much plaque has formed on their teeth after eating all those elephant ears and cotton candy!



Visitors do not leave the Tent with just fun memories, they will also take home a small memento such as an apple-shaped magnet or toothbrush with our website, [www.HealthTent.org](http://www.HealthTent.org), printed on it.

The main goal of redesigning the Tent to reach more people was to be able to let them know about the health events for the whole person that are organized by Adventist churches in southwestern Michigan. To strengthen their spiritual growth each visitor will be given a handout advertising the "Unlock Revelation" seminar series, as well as various health-related events at local Adventist churches, designed to minister to physical, emotional and mental health. All events will be listed and updated on our website. Our goal is for the website to become the go-to place to find health-related happenings.

Would you like to be part of this exciting,

(re-)newed outreach? Join us by visiting [www.HealthTent.org](http://www.HealthTent.org) to learn more and to register as a volunteer. You can also like us on our Facebook page and extend the reach of the Tent to your friends. We invite you to support this outreach ministry financially and most importantly, pray for the Holy Spirit to be present and touch the hearts of those with whom we make contact. ■

*Katherine Koudele is a Certified Group Fitness Instructor and the Co-director of our Health Ministry here at PMC.*

### **SUPPORT THIS MINISTRY**

Please indicate  
"MPE-Health Tent"  
on your tithe envelope.

# WE WORSHIP

CONNECT • GROW • SERVE • GO

## Opening Voluntary

*Praise the Lord, O My Soul* • Johann Herzog

## Introit

*Be Thou My Vision* • Traditional Irish Melody

## Call to Worship

Don Dronen

Jesus told his disciples to bring what they had to fill the need.

**We bring what little faith, hope and love we have to Christ.**

Then let us ask God to bless and use it to be enough.

**Let us worship God in trust he will provide for his people!**

## Doxology

*Praise God, From Whom All Blessings Flow* • 2

## Invocation

John Wesley Taylor V

## Hymn of Praise

*O God, Our Help in Ages Past* • 103

## Congregational Prayer

Don Dronen  
*Lord, Speak to Me* • st. 1 of 541

## Worship in Music

*Nocturne in B-flat Major* • John Field

## Tithes & Offerings

Michigan Advance Partners  
*Rejoice, Ye Pure in Heart!* • Kenneth Logan

## Scripture

Psalm 18:1-3 NRSV • Aron and Ruben Balorda

I love you, O Lord, my strength.

**The Lord is my rock, my fortress, and my deliverer, my God,  
my rock in whom I take refuge, my shield, and the horn of my  
salvation, my stronghold.**

I call upon the Lord, who is worthy to be praised, so I shall be saved  
from my enemies.

## Hymn of Preparation

*Break Thou the Bread of Life* • st. 1 & 4 of 271

**Sermon**

"Life, a Journey. God, the Guide." • John Wesley Taylor V

**Hymn of Commitment**

*Father, Lead Me Day by Day* • 482

**Benediction**

**Closing Voluntary**

*O God, Our Help in Ages Past* • Jan Bender

PRESIDING PASTOR: Don Dronen; ORGANIST: Kenneth Logan  
WORSHIP IN MUSIC: Ruben Balorda, piano

---

# MUSIC ALIVE

REJOICE! GIVE THANKS!

**W**hat better to do on this weekend of beginnings but to rejoice? The text of "Rejoice, Ye Pure in Heart!" (hymn no. 27) is by Edward Plumptre (1821-1891). Originally eleven stanzas long, the text was for a choir festival procession in Peterborough Cathedral in England. The complete hymn uses the processional as a symbol of the Christian's march to heaven. The hymntune, MARION, is named for the

wife of the composer, Arthur Henry Messiter. Born in England, Messiter was active as an organist/chorister at Trinity Church in New York and in Pennsylvania, serving also as a professor in Vermont. Messiter's hymntune MARION was sung in 1887 at Trinity Church in New York for the jubilee service celebrating the fiftieth anniversary of the accession of Queen Victoria to the throne of England: rejoicing indeed!

# WE STUDY

CONNECT • GROW • SERVE • GO

**Song Service**

Rachel Sauer

**Opening Hymn**

*Standing on the Promises* • 518

**Welcome & Prayer**

Philip Giddings III with Isabelle Xiomara Urbina

**Offertory**

*The Promise* • Michael Card

**Bible Study**

The Priority of the Promise • Panel Discussion  
P. Richard Choi, Erhard H. Gallos, & Ranko Stefanovic

**To Internalize**

By the Law or By Promise? • Galatians 3:18, ESV

**Benediction**

Rachel Sauer

ORGANIST: Kenneth Logan  
OFFERTORY: Ryan Clough, vocals; Jennifer Clough, piano



# BACCALAUREATE

SEEK. AFFIRM. CHANGE.

<b>Opening Voluntary</b>	<i>O Sons and Daughters, Let Us Sing</i> • Healey Willan
<b>Processional</b>	<i>Lift High the Cross</i> • Donald Busarow
<b>Hymn of Praise</b>	<i>Rejoice, Ye Pure in Heart!</i> • 27
<b>Congregational Prayer</b>	Thomas R. Shepherd
<b>Worship in Music</b>	<i>Count Your Many Blessings</i> • Edwin O. Excel
<b>Offering</b>	Michigan Advance Partners
Dedication Prayer	Kimberly W. Ferreira
Offertory	<i>Rejoice, Ye Pure in Heart!</i> • Kenneth Logan
<b>Scripture</b>	Felipe E. Tan
<b>Hymn of Meditation</b>	<i>Be Thou My Vision</i> • 547
<b>Introduction of Speaker</b>	Andrea Luxton President
<b>Baccalaureate Sermon</b>	"Life, a Journey. God, the Guide." • John Wesley Taylor V Associate Director of Education, General Conference of Seventh-day Adventists
<b>Hymn of Commissioning</b>	<i>Go Forth, Go Forth With Christ</i> • 377
<b>Benediction</b>	<i>Nadia Nosworthy</i>
<b>Recessional</b>	<i>Dialogue</i> • Gilbert Martin
<b>Closing Voluntary</b>	<i>Guide Me, O Thou Great Jehovah</i> • Kenneth Logan

ORGANIST: Kenneth D. Logan, Professor of Music  
 MARSHAL: Darah J. Regal, Assistant Professor of Audiology  
 WORSHIP IN MUSIC: Monika Ansinn, trombone;  
 Analiz Lozano, French horn; Ricardo Reyna, trumpet

**SUBMIT** announcements by emailing [bulletin@pmchurch.org](mailto:bulletin@pmchurch.org) or by going to [www.pmchurch.org/announcements/submit](http://www.pmchurch.org/announcements/submit). Requests must be received **Monday by 5:00 PM** for consideration.

**NEXT WEEK'S OFFERING**  
World Budget

**SUNSET TODAY** • 9:01  
**SUNSET NEXT FRIDAY** • 8:52

## PIONEER PULPIT

| 08 • 12 |

### TAURUS MONTGOMERY

The Tale of Two Thieves and the Man in the Middle

| 08 • 19 |

### DWIGHT K. NELSON

"Ground Zero: Living in the Cross Hairs (of Total Engagement)"

## FINANCIAL FEATURE

### MICHIGAN ADVANCE PARTNERS

Do you know someone who enjoyed Camp Au Sable this summer? Camp is a week full of time spent making new friends, doing crafts and outdoor activities. But even more important than all of the activities, the week at Camp Au Sable may be the first time a child learns that Jesus loves them or it may be a time that a decision to follow Jesus for life is made. Your support of Michigan Advance Partners (MAP) helps fund Camp Au Sable each year and can make a difference in the lives of many children.

### Overflow Seating

Overflow seating for the 11:45 AM service is available in the PMC Youth Chapel.

### Commencement Services

Please remember that tickets are required for seating at the Andrews University Commencement services tomorrow, Sunday, August 6. For guests without tickets, there will be overflow seating provided for all three services in the PMC Youth Chapel.

### Stay in Touch

Congratulations class of 2017! As you leave Andrews University and venture out into the world we encourage you to stay connected with Pioneer Memorial Church—[www.pmchurch.org](http://www.pmchurch.org). There you can follow Pastor Dwight's blog, "The Fourth Watch," share a prayer request, or join us each week in worship via our livestream at 11:45 AM Eastern Time. We wish for God's richest blessings as you share the Gospel with the world.

### Art Job Opening

Niles Adventist School in Niles, Michigan, is seeking someone to teach K-8 art at the school this year. Interested Adventists, please contact the school office for information: 269.683.5444 or Mr. Crawford at 269.591.0729.

## **Adventist Retirees of Michiana**

AUGUST 13 • 1:00 PM

WOLF PRAIRIE PARK, BERRIEN SPRINGS

All Adventist Retirees of Michiana are invited to meet for the annual corn roast. Bring a dish to pass for the potluck meal. Come out for good fellowship and appreciation of a summer day! Use the Cass Street entrance to enter the park.

## **Sanctuary Choir**

WEDNESDAYS • 7:00 TO 8:30 PM

PMC TEEN LOFT

Are you interested in joining the PMC Sanctuary Choir? Have you ever sung with us before? Not singing anymore? Leave your borrowed folder and music at the PMC Reception Desk with Janna. Better yet, bring it to rehearsal and sing with the choir again! For more information contact Jeannie Pedersen-Smith, at [jean.pedersen.smith@gmail.com](mailto:jean.pedersen.smith@gmail.com).

## **PMC Prayer Teams**

The PMC Prayer Teams are in need of your participation during first or second services. We gather each Sabbath in the Prayer Room (located behind the big glass window on the piano side of the sanctuary) to pray for the indwelling and blessings of the Holy Spirit on each aspect of the church service. We are not isolated from the happenings in the Sanctuary, for we see and hear the whole service and are blessed along with the congregation. If the Holy Spirit impresses you to join us, or you want additional information, please call Katherine Smith at 269.471.1502 (1st service) or call/text Andrea Gibbs at 209.663.9891 (2nd service).

## **Rotary BBQ**

BERRIEN SPRINGS MIDDLE SCHOOL

AUGUST 10 • 4 TO 7PM

PMC makes a difference in our local community through our connection with Rotary Club. Join us to help fund local scholarships and initiatives that bless our community and beyond. For tickets or information contact Lailane Legoh at [legoh@pmchurch.org](mailto:legoh@pmchurch.org).

## **Women's Day at the Historic Adventist Village**

AUGUST 19

Please RSVP and join us at the Historic Adventist Village in Battle Creek. A haystack supper is by reservation only by calling 269.965.3000. If you have questions, please contact Laurie Snyman at [lsnyman@misda.org](mailto:lsnyman@misda.org).

## **District 9 Family Camp**

SEPTEMBER 2-5

CAMP AU SABLE

Applications for the annual District 9 Family Camp at Camp Au Sable can be found at the PMC receptionist's desk or online at [www.districtnine.wix.com/home](http://www.districtnine.wix.com/home). Deadline for reservations is Sunday, August 14, by noon. For more information contact Ric Streelman at 269.208.7172.

## **GROW More in 2017**

Lead a GROW Group between Sept. 24 and Dec. 10, 2017. **1** Think of a subject or activity that you're passionate about. **2** Invite at least 2 others to join you. **3** Sign up at [www.pmchurch.org/grow](http://www.pmchurch.org/grow). Help us grow more hope, community, and friends for Christ! Contact Pastor Sabine at [growgroups@pmchurch.org](mailto:growgroups@pmchurch.org) or call 269.471.6153.

# SABBATH VESPERS

SEEK. AFFIRM. CHANGE.

<b>Opening Voluntary</b>	<i>Andante Moderato • Marcel Dupré</i>
<b>Scripture &amp; Prayer</b>	Pamela Carter, DPT
<b>Introduction of the President</b>	Felecia De'Andrea Datus, MA
<b>Welcome to Parents &amp; Guests</b>	Andrea Luxton President
<b>Tribute to University</b>	<i>Hebe Soares, MBA</i>
<b>Musical Selection</b>	<i>Oblivion • Astor Piazzolla</i> <i>Pedro Falcón, oboe; Kleberson Calanca, piano</i>
<b>Tribute to Students</b>	Oliver Glanz Associate Professor of Old Testament
<b>Musical Selection</b>	<i>On a Rugged Hill • Keith Whitford</i> Josileia Da Cruz Kister, BA, soprano; Ronnie Zanella, piano
<b>Tribute to Faculty</b>	Renaude Saint-Phard, PhD
<b>Musical Selection</b>	<i>That's For Me • Kurt Frederic Kaiser</i> Michaela Souza, flute; Ronnie Zanella, piano
<b>Tribute to Family &amp; Friends</b>	Abner Hernandez, PhD
<b>Benediction</b>	Gala Ualita, MArch
<b>Closing Voluntary</b>	<i>A Mighty Fortress Is Our God • Max Reger</i>

Graduates and their families are invited to a reception hosted by President Andrea Luxton immediately following in the Great Lakes Room of the Campus Center.

## | PASTORS |

**Chaplain / Pioneer**

José Bourget • 471.6254  
bourget@pmchurch.org

**Discipleship / GROW Groups**

Sabine Vatel • 471.6153  
vatel@pmchurch.org

**Harbor of Hope**

Taurus Montgomery • 269.210.6155  
montgomery@pmchurch.org

**Lead Chaplain**

June Price • 471.6282  
juneprice@andrews.edu

**Lead Pastor**

Dwight K. Nelson • 471.3134  
nelson@pmchurch.org

**Pastoral Care**

Don Dronen • 471.3133  
dronen@pmchurch.org

**Stewardship**

Sharon Terrell • 471.6151  
terrell@pmchurch.org

**This Generation Evangelism**

Rodlie Ortiz • 471.6154  
ortiz@pmchurch.org

**Youth Ministries**

Ben Martin • 471.6176  
martin@pmchurch.org

**Media Ministries**

Richard Parke • 471.3246  
parke@pmchurch.org

**Music**

Kenneth Logan • 471.3231  
logan@pmchurch.org

## | STAFF |

**Admin. Assistant**

Lailane Legoh • 471.3543  
legoh@pmchurch.org

**Admin. Assistant / Facilities / Clerk**

Janna Quetz • 471.3133  
quetz@pmchurch.org

**Assistant Media Director**

Gaddiel Zelaya Martínez • 471.3678  
zelaya@pmchurch.org

**Assistant Treasurer**

JoAnn Siagian • 471.7656  
siagian@pmchurch.org

**Bible Work Coordinator**

Tabitha Umali • 471.3550  
umali@pmchurch.org

**Executive Assistant**

Claudia Sowler • 471.3134  
sowler@pmchurch.org

**Graphic Designer**

Rachelle Offenback • 471.3647  
bulletin@pmchurch.org

**Maintenance**

Larry White • 471.3649  
white@pmchurch.org

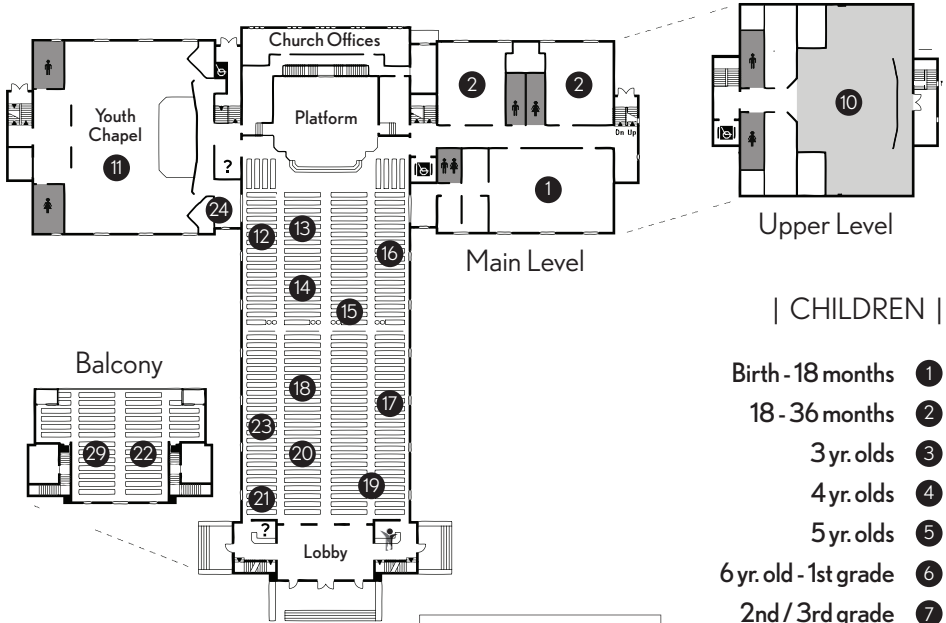

| CHILDREN |

- Birth - 18 months ①
- 18 - 36 months ②
- 3 yr. olds ③
- 4 yr. olds ④
- 5 yr. olds ⑤
- 6 yr. old - 1st grade ⑥
- 2nd / 3rd grade ⑦
- 4th grade ⑧
- 5th / 6th grade ⑨
- Earliteen ⑩
- Youth ⑪

| ADULT |

- ⑫ Group 1
- ⑬ Group 2 (Portuguese/Brazilian)
- ⑭ Group 3
- ⑮ Group 4 (Yugoslavian)
- ⑯ Group 5
- ⑰ Group 6
- ⑱ Group 7
- ⑲ Group 8
- ⑳ Group 9 (Spanish)
- ㉑ Group 10
- ㉒ Group 11 (Balcony)
- ㉓ Group 12 (French)
- ㉔ Conference Room
- ㉕ Something In Common
- ㉖ Young Adults
- ㉗ SDA Beliefs

| KEY |

- ? Welcome Centers
- ⬇ Elevators
- ♿ Restrooms
- 👤 Children's Activities & Lending Library

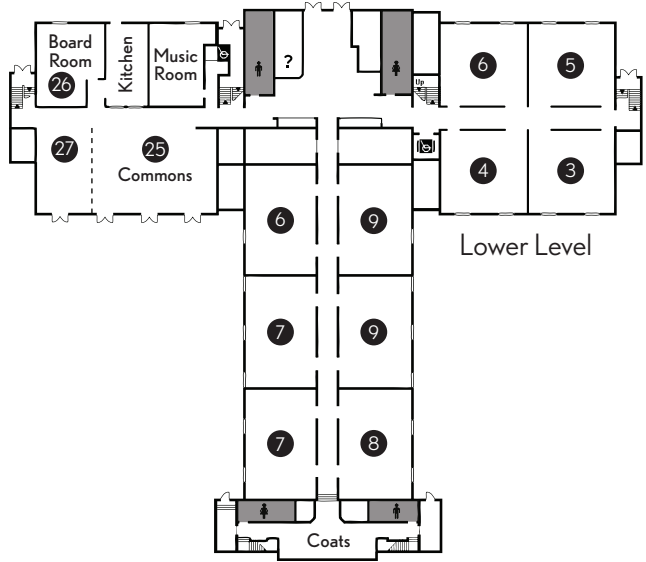

Lower Level

# Andrews University Campus Map

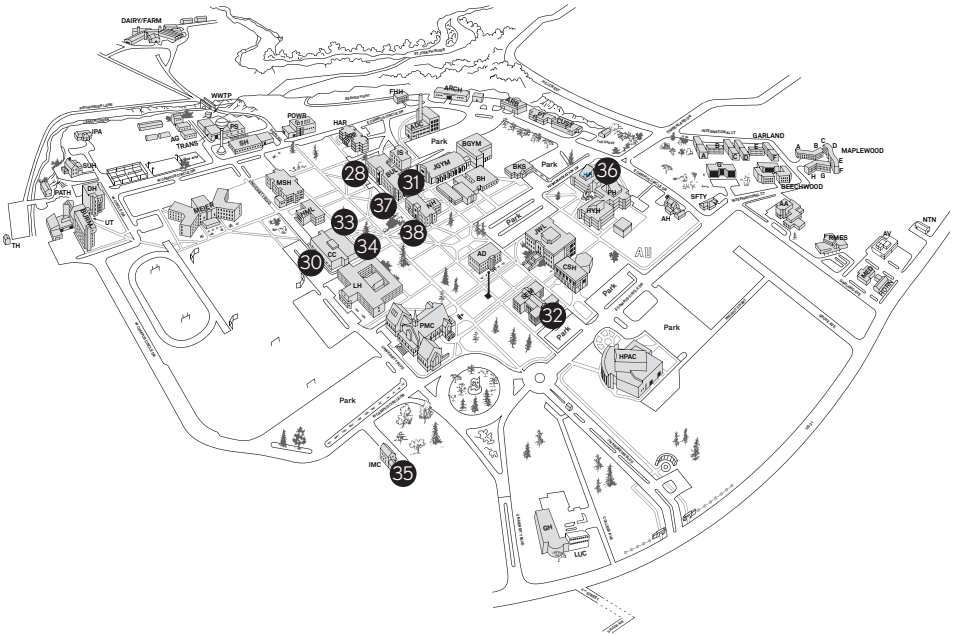

## | COLLEGIATE |

- 28 H&M (Hispanic - Religion Amphitheater)
- 29 People on the Move (PMC)
- 30 University Sabbath School (Dining Services)
- 31 Compass Sabbath School (Buller - Religion Dept.)

## | SEMINARY |

- 32 N108 (Collegiate)
- N110
- N120 (New Life Church Choir)
- N150
- N211 (Small Group)
- N235
- N310 (Digging Deep)
- N335 (Spanish)
- S340 (Upper Room)

## | ADULT @ AU |

- 33 Main Lounge
- 34 Faculty Lounge
- 35 Back to Basics
- 36 Living Word Fellowship
- 37 Current Events (Nethery - 134)
- 38 Bible Journey (Nethery - 143)



# ARE YOU READY?

- ✓ Backpack
- ✓ Water Bottle
- ✓ Markers
- ✓ Calculator
- ✓ Registration at RMES

.....

If you haven't enrolled your student at RMES,  
would like to tour the campus, or just have questions,  
please feel free to contact us.



Ruth Murdoch Elementary School  
8885 Garland Ave., Berrien Springs, MI 49104  
269.471.3225 • [www.myRMES.org](http://www.myRMES.org)



**school begins  
AUGUST 21!**