

**PIONEER** \_\_\_\_\_  
**CONNECT**

FEBRUARY 24, 2018



**King of Hearts:**  
CAN YOU FEEL THE LOVE?

# WELCOME



*to Pioneer*

Today I invite you to remember your place in the world. It involves a crown. I'm often so distracted by the immediate that I forget about my crown. In Shakespeare's Henry VI part 3—we find the displaced Henry working through his 'crown' issues:

"My crown is in my heart, not on my head,  
Not decked with diamonds and Indian stones;  
Nor to be seen: my crown is called content,  
A crown it is that seldom kings enjoy"(3.1.62-65).

Is he clear about his place or just coping? Let's be clear. We are the children of Him whose place is "far above all rule and authority and power and dominion" (Ephesians 1:21). Today, let's consider welcoming Him into our hearts, accepting our inheritance as princesses and princes. Our place in the world? We belong to royalty!

—José Bourget

 <b>PIONEER MEMORIAL CHURCH</b> 8655 UNIVERSITY BOULEVARD, BERRIEN SPRINGS, MI 49103		
<b>OFFICE HOURS</b> Monday – Thursday (8 to 5) • Friday (8 to 12)		<b>PHONE</b> – 269.471.3133 <b>FAX</b> – 269.471.6152
<b>LIVE STREAMING</b> <a href="http://www.pmchurch.org">www.pmchurch.org</a> Sabbath 11:45 AM	<b>ONLINE</b> <a href="http://www.pmchurch.org">www.pmchurch.org</a> <a href="http://www.newperceptions.tv">www.newperceptions.tv</a>	<b>RADIO</b> WAUS – 90.7 FM Sabbath 11:30 AM
 <b>CONNECT CARD</b> Scan this code to receive this week's Connect Card.		 <b>FIND A SABBATH SCHOOL</b>

# FIND IT HERE

CONNECT • GROW • SERVE • GO



---

**4**

**THE FOURTH  
WATCH BLOG**

Remembering Billy  
Graham (1918-2018)

---

---

**10**

**WE STUDY**

The Impact of Tithing

---

---

**13**

**ANNOUNCEMENTS**

---

---

**6**

**PIONEER LIFE**

Preserving Memories  
While Making Them

---

---

**11**

**WE WORSHIP 2**

11:45 AM Service

---

---

**16**

**FAMILY FINANCES**

---

---

**8**

**WE WORSHIP**

9:00 AM Service

---

---

**12**

**MEMBERSHIP  
TRANSFERS**

---

---

**19**

**CONTACTS**

---

# REMEMBERING BILLY GRAHAM

(1918-2018)

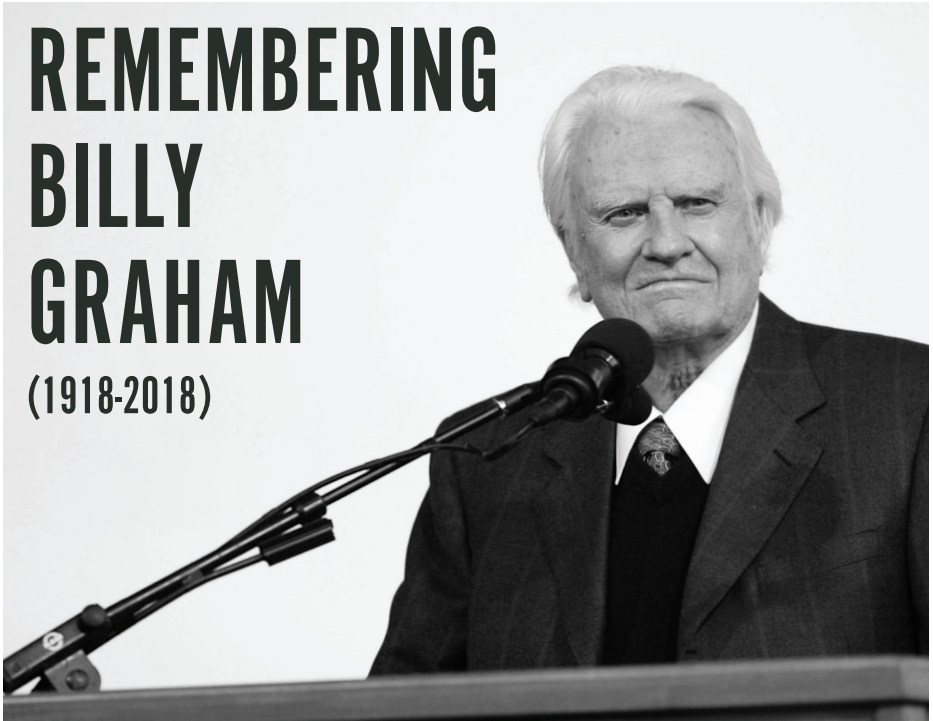

BY DWIGHT K. NELSON

"Billy Graham, America's Pastor, Has Died" intoned the *USA Today* headline this morning: "The world's best-known evangelist, the Rev. Billy Graham, has died. He was 99. From the gangly 16-year-old baseball-loving teen who found Christ at a tent revival, Graham went on to become an international media darling, a preacher to a dozen presidents and the voice of solace in times of national heartbreak. He was America's pastor" ([www.usatoday.com/story/news/nation/2018/02/21/billy-graham-americas-pastor-has-died/858017001](http://www.usatoday.com/story/news/nation/2018/02/21/billy-graham-americas-pastor-has-died/858017001)).

It's no secret I have admired Billy Graham throughout my ministry (is there a preacher who hasn't?). I've read his autobiography, *Just as I Am*. And then on a two-day trip with my mother-in-law sitting beside me, I listened to Cliff Barrow,

Graham's longtime evangelistic associate, read the autobiography on tape. Last May Cheryl Logan gave me a book, *God in the Garden: The Amazing Story of Billy Graham's First New York Crusade*. What a stirring first person account of that historic four-month series in Gotham City! Throw in a couple of John Pollack's biographies of the famous preacher-evangelist and a tour of the amazing Billy Graham Museum Library in Charlotte, North Carolina—and I can testify I've come to know this great man who died peacefully this Wednesday, nine months short of a century on earth.

In May, 1957, Billy Graham wrote in his diary: "Tonight I felt probably the greatest liberty I have felt thus far [in his New York City Madison Square Garden crusade]. I doubt if there is an experience in

the world quite like a minister preaching the Gospel and having liberty and power. It is beyond any other human experience. There is nothing more horrible than to preach without liberty and power. I have had ministers tell me that they never had liberty or power in preaching. . . . I think I would leave the pulpit" (*God in the Garden* 132). How very true!

According to most estimates, Billy Graham through his 417 crusades and music events spoke to more human beings than any other single individual in history (popes and politicians included). In live audiences alone, he preached the gospel to more than 215 million people globally (with 3.2 million people accepting Christ in those crusades). But adding his radio and television broadcasts, Wikipedia calculates "Graham's estimated lifetime audience . . . topped 2.2 billion" ([en.wikipedia.org/wiki/Billy\\_Graham](http://en.wikipedia.org/wiki/Billy_Graham)). No wonder he appeared in Gallup's list of most admired men and women sixty times since 1955, more than any other person in the world.

After reading his autobiography, I jotted down a list of life lessons for me as we counted down to something we called NET98. And I submit this list of lessons as a humble testimony to the influence this godly man has had on my own journey as a preacher (journal entry August 9, 1997):

1. *Plunge into challenge no matter how you feel*
2. *Bathe your campaign in prayer*
3. *Believe the Bible is God's Word to your world (stupendous mission—Rev 14:6, 7)*
4. *Surround yourself with a team of honest, devoted spiritual leaders*
5. *Turn down \$\$ as sideline—keep all fund-raising accountable*
6. *Be willing to travel*

7. *Learn from each new experience and campaign*
8. *Expect setbacks and failures*
9. *Expect God to intervene*
10. *Go for the young*
11. *Be willing to speak to any group*
12. *Don't let important messages hold you back from accepting invitations*
13. *If God could bless Billy [Graham] & Charles [Spurgeon] & [Dwight L] Moody—why couldn't God bless me*
14. *Think strategically*
15. *Rally local pastors to your support*
16. *Don't be afraid of interviews, news conferences and publicity*
17. *Remember Who called you*
18. *Remember the message you found is what the world's hungry for*
19. *Work with a partner and a team—no Lone Rangers*
20. *Talk boldly—your spirit will follow—EGW*
21. *Pray—pray—pray*
22. *Drink warm water—ice water only tightens the throat muscles*
23. *There is absolutely no need to apologize for the gospel of Jesus Christ in academic settings—the gospel can more than hold its own*
24. *Jer 29:11 & Is 55:[11]*
25. *Always preach the cross*

A great man has died. But the Christ Billy Graham preached still lives—and still issues today to all who follow Him His compelling imperative: "Go therefore and make disciples of all the nations, baptizing them in the name of the Father and of the Son and of the Holy Spirit, teaching them to observe all things that I have commanded you; and lo, I am with you always, even to the end of the age" (Matthew 28:19-20).

To which I invite you to respond with me to Jesus, "Here am I—send me." Amen. ■



## BY SHERRIE DAVIS

Over ten years ago, three Pioneer Memorial Church employees were looking at ways to share their love of scrapbooking and create an opportunity for women of any faith to get together in addition to the regular Women's Ministry meetings. At that time scrapbooking was a very popular hobby loved by many generations. Over the years we have had women from teenagers to 80-year-old grandmas come and preserve their memories through scrapbooking.

When the group first started we were strictly a scrapbooking group. If you were to walk into one of the meetings now, you would find people documenting their heritage with pictures and documents from past generations or preserving memories of vacations taken or major life events (weddings, births). Other ladies would be sorting pictures to put in future scrapbooks. Others would be making greeting cards to be shared with loved ones and friends, and at least once a year we all make cards to send to those listed on the Family Prayer Needs list. Someone else might be working on a mixed-media project. Therefore, the name of the group changed to Papercrafting Together.

Long-time friendships have formed. Rena Richter, a Canadian "on vacation" while her husband was here studying at the Seminary, heard about Scrapbooking Together from her father-in-law who saw a bulletin announcement. She walked in "late" but felt welcomed. She didn't miss another meeting while she was here. She encouraged the group to meet longer and to have our once-a-year overnight

meeting. It was through her connections that we found out about another crafting group that meets in Bridgman. Some of those ladies now attend our Sunday meetings while several of the paper-crafting group attend their gatherings.

There is a core group that meets regularly with others coming and going as their schedule allows. We pray for and encourage each other.

The paper-crafting group meets one Sunday a month for a minimum of 5 hours, but lately has been meeting from 11:00 AM to 5:00 PM. There is no expectation that you must attend the full meeting. You can come for a portion or you can stay for the entire time. Once-a-year, we meet on Saturday night and all day Sunday. The beauty of this is that you can come, set up your work, go home and sleep and come back on Sunday for a full day of crafting. When you arrive you will be asked to put your name in a basket; later, names will be drawn for prizes. Prizes include paper, embellishments, stickers, buttons, etc., most of which have been donated.

Over the years paper-crafting has changed, but our love for sharing our talents and memories hasn't. We welcome everyone from beginners to experts, and love seeing new faces. We pray that God will continue to direct people to our group. ■

*Sherrie Davis along with Gaie Lynne Leer  
co-direct the Papercrafting/Scrapbooking  
GROW Group.*

# WE WORSHIP

CONNECT • GROW • SERVE • GO

## Opening Voluntary

*The King of Love My Shepherd Is • John Dykes*

## Introit

*Come Holy Spirit • Marguerite Samuel*

## Call to Worship

José Bourget

The Lord has gone up with a shout, with the sound of a trumpet.

**Let us sing praise to our God: let us sing praise to our King!**

God is king of all the earth; God reigns over all the nations.

**"And I," said Jesus, "when I am lifted up, shall draw all people to myself."**

Let us give God the glory, forever and ever.

## Doxology

*Praise God, From Whom All Blessings Flow • 2*

## Invocation

Dwight K. Nelson

## Hymn of Praise

*Crown Him With Many Crowns • 223*

## Congregational Prayer

José Bourget  
*Spirit of the Living God • 672*

## Worship in Music

*Walk in Light • Karen Marrolli*

## Children's Story

*Poem of Divine Love • Kenneth Logan*

## Scripture

1 Corinthians 13:4-8 • Jessica Yoong and Sinegugu Katenga

**Love suffers long and is kind; love does not envy; love does not parade itself, is not puffed up;**

Does not behave rudely, does not seek its own, is not provoked, thinks no evil;

**Does not rejoice in iniquity, but rejoices in the truth;**

Bears all things, believes all things, hopes all things, endures all things.

**Love never fails.**



<b>Hymn of Preparation</b>	<i>"In the Heart of Jesus"</i> • 577 (stanzas 1 & 3)
<b>Sermon</b>	"King of Hearts: Can You Feel the Love?" • Dwight K. Nelson
<b>Connect Card</b>	
<b>Tithes, Offerings</b>	World Budget
<b>Hymn of Commitment</b>	<i>"'Tis Love That Makes Us Happy"</i> • 579
<b>Benediction</b>	
<b>Closing Voluntary</b>	<i>Fantasie</i> • Johann Sebastian Bach

PRESIDING PASTOR: José Bourget; ORGANIST: Kenneth Logan  
 WORSHIP IN MUSIC: PMC Sanctuary Choir; Marguerite Samuel, director;  
 Danya Wilson, violin; James North, Jr., piano

---

## MUSIC ALIVE

### "POEM: NO WORDS"

**T**oday's offertory seeks to peek into the immensity of the topic of God's love—divine love. It is an organ piece—so how can it be a “poem,” given that it has no words communicated to the listener? One thing that it is not: It is not music that is so specific in its meaning that it will elicit particular words for all listeners, thus forming a collective

“poem” of clear meanings to all. No—but it should, if successful, broadly invoke for the aware listener meanings suggestive of its title. What is it about divine love that the music may communicate in this way, through its ethereal and mysterious beginning, songlike continuation, “warm” midsection, rise to a high point, and reflective close? ■

# WE STUDY

CONNECT • GROW • SERVE • GO

**Song Service**

Jimmer Mun

**Scripture & Prayer**

3 John 1:4

**Welcome**

Ben Martin

**Mission Feature**

"Flag Camp"

**Offertory**

"We Worship and Adore You" • arr. Mark Hayes

**Bible Study**

Classes • "The Impact of Tithing"

**Theme Song**

*Make Me a Blessing*

Make me a blessing; make me a blessing.  
Out of my life may Jesus shine.  
Make me a blessing; O Savior, I pray.  
Make me a blessing; to someone today.

"Make Me a Blessing," Ira Bishop Wilson

©1924, Renewed 1952 Word Music, LLC; Used by Permission. CCLI License #392652

**Benediction**

Jimmer Mun

ORGANIST: Kenneth Logan  
OFFERTORY: Hteemu Dee, piano

# WE WORSHIP 2

CONNECT • GROW • SERVE • GO

## As We Begin

*The King of Love My Shepherd Is* • John Dykes  
*Come Holy Spirit* • Marguerite Samuel

## Praise

*Crown Him with Many Crowns* • *You Are My Vision*  
*Healer* • *Holy Spirit Rain Down*

## Prayer

John Gonzalez

## Children's Story

*Poem of Divine Love* • Kenneth Logan

## Worship in Music

*Walk in Light* • Karen Marrolli

## Sermon

"King of Hearts: Can You Feel the Love?" • Dwight K. Nelson

## Connect Card

## Tithes & Offerings

"'Tis Love That Makes Us Happy" • 579

## As We Depart

*Fantasia* • Johann Sebastian Bach

WORSHIP COORDINATOR: José Bourget; ORGAN: Kenneth Logan  
WORSHIP LEADER: Alex Wilson; VOCALS: David Hernandez, Kenric Rimoni, Nayeli Moretta;  
PIANO: Joshua Goines; CAJON: LJ Robinson; BASS GUITAR: Chris Wilson  
WORSHIP IN MUSIC: Sanctuary Choir; Marguerite Samuel, director;  
Danya Wilson, violin; Dr. James North, piano

**| TRANSFERS IN |**

BENJAMIN, Jean  
 BENJAMIN, Sival  
 CARDOSO, Ana  
 CARDOSO, Debora  
 CHIMWAMCHERE, Joseph  
 CHIMWAMCHERE, Rhoda  
 DALEY, Jenifer  
 DE LIMA, Ana Cardoso  
 ESCOTTO, Anthony S.  
 GALINDO, Ruben  
 GALLARDO, Elsy  
 KAYAGA, Agatha  
 KLIMKEWICZ, Joel  
 MIYATA, Hitoshi  
 MIYATA, Yumiko  
 PALMER, Alyssa  
 SAMOS, Adrienne  
 SNYDER, Karen  
 VARGAS, Nereida

**| FROM |**

Kraaifontein, Capetown South Africa  
 Kraaifontein, Capetown South Africa  
 Kona/Captain Cook, HI  
 Kona/Captain Cook, HI  
 Central/Lilongwe, Malawi  
 Central/Lilongwe, Malawi  
 Kencot/Kinston 10, Jamaica  
 Kona/Captain Cook, HI  
 Village/Berrien Springs,MI  
 Spanish/Berrien Springs, MI  
 Central del Valle/McAllen, TX  
 Kampala/ Uganda  
 LaPorte, IN  
 East Japan/Tokyo  
 East Japan/Tokyo  
 Central/Milwaukee, MI  
 Spanish/Benton Harbor, MI  
 College View/Lincoln, NE  
 Spanish/Berrien Springs,MI

**| TRANSFERS OUT |**

BENJAMIN, Jean  
 BENJAMIN, Sival  
 ESCORBAR, Jose R.  
 EVANS, Andre  
 EVANS, Lucas  
 EVANS, Silmara  
 EVANS, Tom  
 FIO, Fontaine  
 FIO, Meaatoa  
 GOYA, Ignacio  
 GOYA, Magaly  
 HANDY, Elizabeth G.  
 HATCHER, Theodore  
 JORGENSEN, Jessica (Helm)  
 JORGENSEN, Johnathan  
 JUSTINIANO, Lorraine  
 LIVESAY, Barbara  
 LIVESAY, Don  
 LUNETTA, Miralles

**| TO |**

Missing  
 Missing  
 Spanish/Poinciana, FL  
 Avondale Memorial/ Cooranbong, AUS  
 Avondale Memorial/ Cooranbong, AUS  
 Avondale Memorial/ Cooranbong, AUS  
 Avondale Memorial/ Cooranbong, AUS  
 Village/Berrien Springs,MI  
 Village/Berrien Springs,MI  
 Linthicum Heights, MD  
 Linthicum Heights, MD  
 Buchanan, MI  
 Kahului, HI  
 Hamilton /Chattanooga,TN  
 Hamilton Comm/Chattanooga,TN  
 Spanish/Poinciana, FL  
 Calhoun, GA  
 Calhoun, GA  
 Nova Semente/Sao Paulo, Brazil

**SUBMIT** bulletin announcements by visiting our form online at [www.pmchurch.org/announcements/submit](http://www.pmchurch.org/announcements/submit). Requests must be received Monday by 5:00 PM for consideration.

**NEXT WEEK'S OFFERING**  
PMC OPERATING EXPENSE

**SUNSET TODAY** • 6:27  
**SUNSET NEXT FRIDAY** • 6:36

## PIONEER PULPIT

| 03 • 03 |

**DWIGHT K. NELSON**

"Church of Hearts: Can You Feel the Love?"

| 03 • 10 |

**DWIGHT K. NELSON**

"Teach Your Heart to Sing Again"

## FINANCIAL FEATURE

### MICHIGAN ADVANCE PARTNERS

The Lord owns everything. Psalms 50:10, 12 says, "For every animal of the forest is mine, and the cattle on a thousand hills. If I were hungry I would not tell you, for the world is mine, and all that is in it." God is able to support His work without human input but chooses to partner with us in order to impart in us the divine attribute of selfless giving which is a by-product of love. Today it is our privilege to partner with the Lord by helping the Michigan Conference fund evangelism, building programs, camp meeting, Camp Au Sable and education through the Conference advance offering.

### Visitors' Dinner

Join us today after second service in the PMC Commons (downstairs) for a home-cooked vegetarian meal.

### Family Vespers

TODAY • 6:00 PM  
YOUTH CHAPEL

Revive Club Ministry is presenting "What is Keeping you on the Bench?"

### Paper Crafting Together

FEBRUARY 24 • 11:00 AM-5:00 PM  
PMC COMMONS

Make memories while preserving your memories. Bring your scrapbook, card, or mixed media projects and favorite snack. We will provide prizes and chocolate. For more information email [sherrie.davis@lakeunion.org](mailto:sherrie.davis@lakeunion.org).

### We GROW Better Together

Spring GROW Groups registration is now available. See the catalog that is in your bulletin for options. Register online at [www.pmchurch.org/grow](http://www.pmchurch.org/grow).

### Burt & Babb Wedding

MARCH 4 • 3:30 PM  
PIONEER MEMORIAL CHURCH

The Burt and Babb families invite you to rejoice with them over the marriage of their children Celesta and Zack. We hope to see you there!

**Keys to Personal Revival  
and a Lifestyle of Vibrant  
Living in Christ**

MARCH 2 • 5:30 PM  
FIVE PINES MINISTRIES

Female spouses of seminary students and student women clergy are invited to a Prayer Retreat. Be prepared for an extraordinary-life changing experience with guest speaker and author Melody Mason of the GC Prayer Ministries Dept. Melody is the author of the bestselling book "Daring to Ask for More." Register at the NADEI Office in the Seminary Building.

**Engaged Encounter**

MARCH 2-4 • 6:00 PM  
COUNCIL CHAMBER  
GRIGGS HALL

Engaged Encounter is a retreat weekend for engaged, recently married, or seriously dating couples. If you've talked about getting married, you should attend engaged encounter! Register now at [aee@andrews.edu](mailto:aee@andrews.edu) or call 269.815.8491.

**Wind Symphony  
Vespers Concert**

MARCH 2 • 7:30 PM  
HOWARD PERFORMING ARTS CENTER

For our annual Vespers Concert as part of the Andrews University Music Festival, the Wind Symphony presents a wide of variety of inspirational sacred music for wind band. Headlining the program is David Gillingham's, No Shadow of Turning, a distinctive arrangement of Great is Thy Faithfulness, and other repertoire. Come be blessed and inspired by these moving pieces!

**Benefit Concert  
Featuring Jamie Jorge**

MARCH 14 • 7:00 PM  
HOWARD PERFORMING ARTS CENTER

Come for a wonderful night of violin music by the world renowned artist, Jaime Jorge, and a special dedication for the Care for Cuba mission team leaving March 16. They will be spearheading evangelistic efforts in Cuba. A free-will offering will be collected to support Care for Cuba. Admission is free.



## New Member Orientation

MARCH 3 • 10:30 AM  
PMC BOARDROOM

If you have recently transferred your church membership, been baptized, joined by Profession of Faith, or enrolled at Andrews University, you are invited to attend the Pioneer new member orientation. We want to meet you, share the mission and vision of Pioneer with you, and introduce you to your pastors as we help you become better acquainted with your new church family. Register at [www.pmchurch.org/new-member](http://www.pmchurch.org/new-member) or call pastor Sabine or Gracie Gaytan via 269.471.3133.

## Madagascar Project

AU's Community & International Development Dept. provides an opportunity for students to attend the Madagascar Study tour. The goal every year is to implement a humanitarian and development project. This year's project supports La Chretienne College, an Adventist school there. Students who attend are in need of supplies to make their education more successful. For more information about donating to these projects in Madagascar go to: [www.andrews.edu/services/development/](http://www.andrews.edu/services/development/)

## More Announcements

For more PMC and community announcements, please visit our website at [www.pmchurch.org/announcements](http://www.pmchurch.org/announcements). Requests must be received Monday by 5:00 PM for consideration.

## Nominating Committee

FIRST READING

Dave Nowack, Chair  
Renaude StPhard, Vice Chair  
Janna Quetz, Technical Support  
Skip Bell  
Julie Clayburn  
Kemmorie Duncombe  
Pat Erhard  
Jim Ford  
Phil Giddings  
Larry Habenicht  
Rick Jones  
Andrew Kipp  
Sheila Kipp  
Cheryl Logan  
Jim McKee  
Macy McVay  
John Nay  
Jim North  
Mordekai Ongo  
Bonnie Perry  
Melchi Ponniah  
Suzanne Renton  
Milan Vajidic  
Dave Waller  
Cleon White  
Ralph Wood  
Bruce Wrenn  
Xiaming Xu

# PMC 2017 YEAR END REPORT

Copies of the 2017 End of Year Data Summary and the 2018 Proposed Budget Summary are available at the reception desks in the Narthex, downstairs entrance and the Sanctuary reception area.

## 2017 Budget Summary

	Actual 2017	Budget 2017	Actual Allocation
<b>NET ASSET BEGINNING BALANCE</b>	\$846,332		
<b>INCOME</b>			
<i>Church Family Finance Goals</i>			
Church Operating	\$596,279	\$635,000	28.8%
Christian Education	202,555	205,294	9.8
Master Plan for Evangelism (MPE)	105,771	135,000	5.1
Building Fund	56,468	46,000	2.7
Student Aid	49,701	57,000	2.4
<b>Total Family Finance Goals</b>	<b>\$1,010,974</b>	<b>\$1,078,294</b>	<b>48.8%</b>
Other Evangelism/Harbor of Hope	289,488	215,645	14.0
Sabbath School	91,026	42,775	4.4
Youth/Outreach Ministries	173,841	129,393	8.4
Television/Media Ministry	321,365	261,000	15.5
Other Income	184,922	123,557	8.9
<b>TOTAL INCOME</b>	<b>\$2,071,616</b>	<b>\$1,850,664</b>	<b>51.2%</b>
<b>EXPENSES</b>			
Evangelism Programs	\$300,611	\$280,095	16.5%
Sabbath School	99,683	60,335	5.5
Youth/Outreach Min/GROW Groups	186,865	175,251	10.3
Christian Educ./Student Aid	314,870	319,994	17.3
Church Operations	370,427	430,366	20.4
Building/Maintenance	167,411	175,679	9.2
Television/Media Ministry	327,297	347,456	18.0
Other	50,186	69,100	2.8
<b>TOTAL EXPENSES</b>	<b>\$1,817,349</b>	<b>\$1,858,276</b>	<b>100%</b>
Net Increase (Decrease)	254,268	(7,612)	
<b>NET ASSET ENDING BALANCE</b>	<b>1,100,600</b>		
<b>TITHE</b>	<b>2017</b>	<b>2016</b>	<b>2015</b>
	5,162,567	5,235,539	5,305,791



# PMC 2018 OPERATING BUDGET

All members are encouraged to attend the Church Business Meeting on Monday, February 26, in the Commons at 7:00 PM.

## 2018 Budget Summary

	Budget 2018	Allocation 2018
<b>NET ASSET BEGINNING BALANCE</b>	\$1,100,600	
<b>INCOME</b>		
<i>Church Family Finance Goals</i>		
Church Operating	\$597,000	35.1%
Christian Education	202,756	12.0
Master Plan for Evangelism (MPE)	106,000	6.3
Building Fund	56,000	3.3
Student Aid	50,000	3.0
<b>Total Family Finance Goals</b>	<b>\$1,011,756</b>	<b>59.7%</b>
Other Evangelism/Harbor of Hope	106,200	6.3
Sabbath School	43,566	2.6
Youth/Outreach Ministries	152,275	9.0
Television/Media Ministry	267,000	15.8
Other Income	114,057	6.7
<b>TOTAL INCOME</b>	<b>\$1,694,854</b>	<b>40.3%</b>
<b>EXPENSES</b>		
Evangelism Programs	\$199,500	12.0
Sabbath School	67,380	4.0
Youth/Outreach Min/GROW Groups	196,890	11.0
Christian Educ./Student Aid	312,556	18.0
Church Operations	396,892	23.0
Building/Maintenance	209,924	12.0
Television/Media Ministry	295,886	17.0
Other	50,925	3.0
<b>TOTAL EXPENSES</b>	<b>\$1,729,953</b>	<b>100%</b>
Net Increase (Decrease)	(35,099)	
<b>NET ASSET ENDING BALANCE</b>	\$1,065,501	

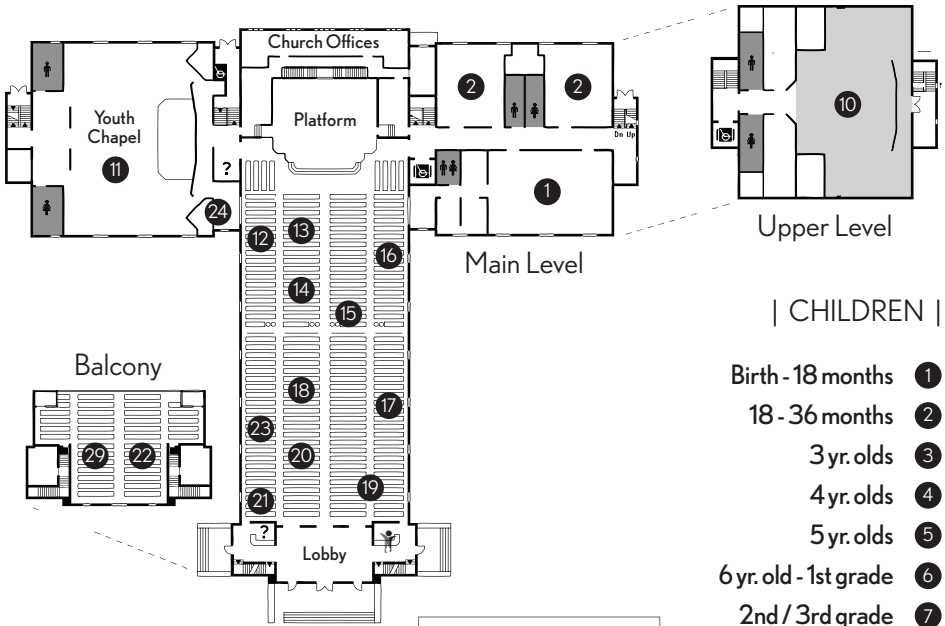

| CHILDREN |

- Birth - 18 months ①
- 18 - 36 months ②
- 3 yr. olds ③
- 4 yr. olds ④
- 5 yr. olds ⑤
- 6 yr. old - 1st grade ⑥
- 2nd / 3rd grade ⑦
- 4th grade ⑧
- 5th / 6th grade ⑨
- Earliteen ⑩
- Youth ⑪

| ADULT |

- ⑫ Group 1
- ⑬ Group 2 (Portuguese/Brazilian)
- ⑭ Group 3
- ⑮ Group 4 (Yugoslavian)
- ⑯ Group 5
- ⑰ Group 6
- ⑱ Group 7
- ⑲ Group 8
- ⑳ Group 9 (Spanish)
- ㉑ Group 10
- ㉒ Group 11 (Balcony)
- ㉓ Group 12 (French)
- ㉔ Conference Room
- ㉕ Something In Common
- ㉖ Young Adult
- ㉗ SDA Beliefs

| KEY |

- ? Welcome Centers
- ⬇ Elevators
- ♿ Restrooms
- 👤 Children's Activities & Lending Library

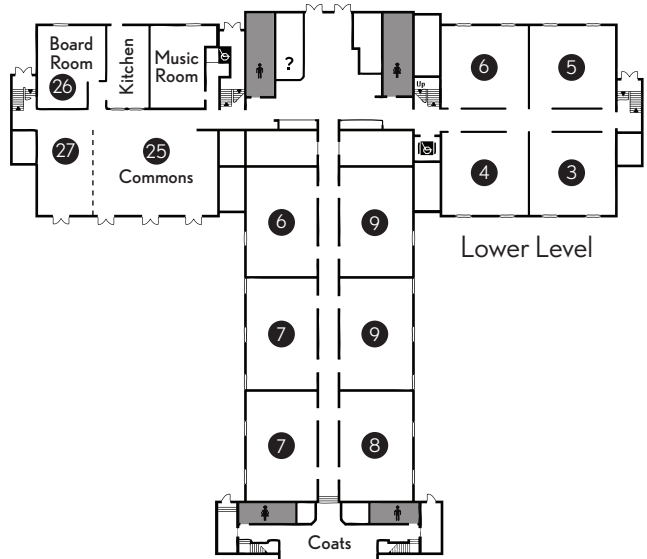

Lower Level

## | PASTORS |

**Chaplain / Pioneer**

José Bourget • 471.6254  
[bourget@pmchurch.org](mailto:bourget@pmchurch.org)

**Discipleship / GROW Groups**

Sabine Vatel • 471.6153  
[vatel@pmchurch.org](mailto:vatel@pmchurch.org)

**Harbor of Hope**

Taurus Montgomery • 269.210.6155  
[montgomery@pmchurch.org](mailto:montgomery@pmchurch.org)

**Lead Chaplain**

June Price • 471.6282  
[juneprice@andrews.edu](mailto:juneprice@andrews.edu)

**Lead Pastor**

Dwight K. Nelson • 471.3134  
[nelson@pmchurch.org](mailto:nelson@pmchurch.org)

**Stewardship**

Sharon Terrell • 471.6151  
[terrell@pmchurch.org](mailto:terrell@pmchurch.org)

**This Generation Evangelism**

Rodlie Ortiz • 471.6154  
[ortiz@pmchurch.org](mailto:ortiz@pmchurch.org)

**Youth Ministries**

Ben Martin • 471.6176  
[martin@pmchurch.org](mailto:martin@pmchurch.org)

**Media Ministries**

Richard Parke • 471.3246  
[parke@pmchurch.org](mailto:parke@pmchurch.org)

**Music**

Kenneth Logan • 471.3231  
[logan@pmchurch.org](mailto:logan@pmchurch.org)

## | STAFF |

**Admin. Assistant**

Lailane Legoh • 471.3543  
[legoh@pmchurch.org](mailto:legoh@pmchurch.org)

**Admin. Assistant / Clerk**

Gracie Gaytan • 471.3133  
[clerk@pmchurch.org](mailto:clerk@pmchurch.org)

**Receptionist**

Jackie Bikichky • 471.3133  
[bikichky@pmchurch.org](mailto:bikichky@pmchurch.org)

**Assistant Media Director**

Gaddiel Zelaya Martínez • 471.3678  
[zelaya@pmchurch.org](mailto:zelaya@pmchurch.org)

**Assistant Treasurer**

JoAnn Siagian • 471.7656  
[siagian@pmchurch.org](mailto:siagian@pmchurch.org)

**Executive Assistant**

Claudia Sowler • 471.3134  
[sowler@pmchurch.org](mailto:sowler@pmchurch.org)

**Graphic Designer**

Brittany Doyle • 471.3647  
[bulletin@pmchurch.org](mailto:bulletin@pmchurch.org)

**Maintenance**

Larry White • 471.3649  
[white@pmchurch.org](mailto:white@pmchurch.org)

