

PIONEER

CONNECT

JUNE 2, 2018



GONE TO THE BIRDS



Lessons from the Divine Ornithologist—1

WE WORSHIP • PAGE 6 | WE WORSHIP 2 • PAGE 9

WELCOME

to Pioneer

To all who have come, welcome to Pioneer. Summertime is here! With Memorial Day behind us, we welcome the warmer weather and all the joys it brings. Psalm 113:3 says, "From the rising of the sun to the place where it sets, the name of the Lord is to be praised." On this Sabbath let us take the time to rest, reset, and relax as we join together in worshipping our Creator. May you be blessed by this time with Him.

 PIONEER MEMORIAL CHURCH 8655 UNIVERSITY BOULEVARD, BERRIEN SPRINGS, MI 49103		
OFFICE HOURS Monday – Thursday (8 to 5) • Friday (8 to 12)		PHONE – 269.471.3133 FAX – 269.471.6152
LIVE STREAMING www.pmchurch.org Sabbath 11:45 AM	ONLINE www.pmchurch.org www.newperceptions.tv	RADIO WAUS – 90.7 FM Sabbath 11:30 AM
 CONNECT CARD Scan this code to receive this week's Connect Card.		 FIND A SABBATH SCHOOL

FIND IT HERE

CONNECT • GROW • SERVE • GO



4

**THE FOURTH
WATCH BLOG**

"Japan: The Son is Rising"

6

WE WORSHIP

9:00 AM Service

8

WE STUDY

"End Time Deceptions"

9

WE WORSHIP 2

11:45 AM Service

10

ANNOUNCEMENTS

12

FAMILY FINANCES

13

CONTACTS

14

**SABBATH SCHOOL
DIRECTORY**

JAPAN: THE SON IS RISING

BY DWIGHT K. NELSON

It was a first for me, this idea of posting an online daily journal from the frontlines of evangelism (www.pmchurch.org/japanjournal). But I'm glad I did, because even if no one read the journal, the very exercise of recording the acts of the Holy Spirit inspired my own soul. So on this first Sabbath back at Pioneer, let me share a few lines from my next to the last journal entry:

"As the Sabbath draws to a close here in my guest room apartment on the Saniku Gakuin campus [201 college students, 70% non-Christian] . . . on the last day of this short but intensive evangelistic series, what an experience this has been for me. And what a blessing to have a small army of prayer partners who have unselfishly devoted extra intercession time to pray for Japan and this college and the advance of the everlasting gospel to this great unreached people group. My reciprocal prayer of gratitude this Sabbath is that God would pour back into your life--in the currency of His Kingdom--a super bundle of blessings for your unselfish

ministry!
T h a n k
you."

"Cars and busses from all over Chiba prefecture (prefectures are small state-like governing administrative units throughout Japan) arrived on campus for the ten o'clock worship celebration in the gymnasium (see photo gallery) and the outdoor baptism and lunch and afternoon concert that followed. My friend, Masumi Shimada, the Japan Union Conference president [we grew up together], told me this afternoon that they counted 775 . . . in the morning event in the gym and Granger Hall [the campus church], an overflow livestreaming site for elderly worshippers. . . ."

"It was my joy to preach on the second coming of our Lord Jesus, the eleventh and final piece in this campus series. . . . My translator, one of the pastors in this prefecture, did a masterful job (as did the other four translators who stood up and preached with me through the week). It is

my opinion that translators are the Spirit-guided preachers who deserve to be remembered long after the visiting foreign preachers have left the country. Because no matter how well or how poorly the guest preacher does, the communication event is what transpires between the translator and the listeners. So I say, God bless them every one."

"One of the reasons it is such a joy to preach the soon coming of Christ is the tonic it provides for my own soul. As Peter expressed it, **We have not followed 'cunningly devised fables' (as the KJV renders it) but we have 'the prophetic message completely reliable, and you will do well to pay attention to it, as to a light shining in a dark place, until the day dawns and the morning star rises in your hearts' (2 Peter 1:16, 19 NIV).** It [always] stirs my soul to recall with the listeners the indicators Jesus gave as harbingers of His return—political, ecological, economic, moral, psychological, societal markers that indicate the unraveling of humanity's hold on this planet and the approach of the King of kings and Lord of lords. And for our natural tendency to dismiss these indicators with the aside—'everything goes on as it has since the beginning of creation' (2 Peter 3:4)—there is the provocative Chris Martenson illustration of geometric progression/compounding we humans tend nearly always to forget (www.adventistreview.org/voices-dwight-k-nelson). The last five minutes are what catch you by surprise."

"Once again through the decision card we made an invitation to guests and students alike to carefully weigh God's call to follow Christ through baptism. And with the final Amen, the entire convocation stood and moved out of the gym, up the winding road to the campus proper high on that hillside, where the Granger Hall outdoor baptistery was already surrounded by family and friends awaiting the baptisms..."

[From the journal entry on Sunday: "Kondo sensei, the campus pastor, handed me a sheet of names when we met this morning with this written report: 'At least 24 non-Christian students put a mark on Question 2 (I would like to bury my past and rise up to new life in Jesus through being baptized as He was) on the Thursday morning decision card. . . . He also notes that at our Friday evening meeting 3 more students indicated they would like to be baptized someday—and the Sabbath morning decision cards have yet to be tallied. Plus . . . five more non-Christian students indicated on the decision card they would like to talk with someone about this decision re baptism. So God has abundantly answered our many prayers in guiding these students to their decisions!"]

"Whenever you begin one of these evangelistic series, you simply have no idea how the series will proceed and eventually end—such is the adventure of preaching. But when it ends . . . there is a quiet sense of gratitude that steals over you, along with a surrender of it all back to God. For, as Jesus reminded us, the mystery of soul-winning is truly divine: **"This is what the kingdom of God is like. A man scatters seed on the ground. Night and day, whether he sleeps or gets up, the seed sprouts and grows, though he does not know how"** (Mark 4:26-27). Or as Paul put it, **'I planted the seed, Apollos watered it, but God has been making it grow. So neither the one who plants nor the one who waters is anything, but only God, who makes things grow' (1 Corinthians 3:6-7 emphasis supplied).**"

"And that's the way it should always be. **'But only God.'** Which is why I thank Him for you, for drawing from your heart the very prayers He needed, in order to do the very work He promised to do and will yet do for His glory alone. Amen."

[Sing Doxology here.]

WE WORSHIP

CONNECT • GROW • SERVE • GO

Opening Voluntary

Allegro • Henry Heron

Introit

Each Little Bird That Sings • Larry Visser

Call to Worship

Rodlie Ortiz

Trust in the Lord, and do good;

The Lord gives wisdom; from His mouth come knowledge and understanding.

Be still before the Lord, and wait patiently for Him.

We wait before the Lord and we keep His way.

Let us praise the name of the Lord.

Doxology

Praise God, From Whom All Blessings Flow • 2

Invocation

Dwight K. Nelson

Hymn of Praise

Joyful, Joyful, We Adore Thee • 12

Congregational Prayer

Rodlie Ortiz
Spirit of the Living God • 672

Fare Thee Well, Pastors

Sabine Vatel and Sharon Terrell with Royce Snyman

Worship in Music

His Eye Is on the Sparrow • Charles Gabriel

Children's Story

With Wings as Eagles • Kenneth Logan

Scripture

Isaiah 40:28-31 NIV • Rick and Joan Register

Do you not know? Have you not heard? The Lord is the everlasting God, the Creator of the ends of the earth.

He will not grow tired or weary, and his understanding no one can fathom.

He gives strength to the weary and increases the power of the weak.

Even youths grow tired and weary, and young men stumble and fall;

but those who hope in the Lord will renew their strength.

They will soar on wings like eagles; they will run and not grow weary, they will walk and not be faint.

Hymn of Preparation

There Is a Quiet Place • 503

Sermon

"Gone to the Birds: Lessons from the Divine Ornithologist—1"
Dwight K. Nelson

Connect Card

Tithes, Offerings

PMC Operating Budget

Hymn of Commitment

I Know Whom I Have Believed • 511

Benediction

Closing Voluntary

The Heavens Declare God's Glory • Benedetto Marcello

PRESIDING PASTOR: Rodlie Ortiz; ORGANIST: Kenneth Logan
MUSICAL SELECTIONS: Marguerite Samuel, soprano; Leslie Samuel, piano

MUSIC ALIVE

"WINGS AS EAGLES"

From Isaiah 40:31 come these words: "they that wait upon the Lord shall renew their strength; they shall mount up with wings as eagles." Commentator Barnes said, "The eagle rises on the most vigorous wing of any bird, and ascends apparently further toward the sun." Barnes further refers to "an elevation above the world; communion with God." One can hear today's children's offertory as re-

flecting on aspects of wings, eagles, and environment. In the music, one can hear the quiet murmuring of water imitated, and suddenly overshadowed by the majestic soaring of an eagle high above. One can imagine other elements of nature interacting with the bird's soaring, and its flying on air currents with slight undulations. The music is in its premiere public hearing in worship today. ■

WE STUDY

CONNECT • GROW • SERVE • GO

Song Service

Jimmer Mun

Scripture

Revelation 12:7-9 NKJV • Zoey Caballero

Prayer & Welcome

Qaisar Ayaz

Mission Feature

"Referral for Healing"

Offertory

*We Are Singing for the Lord Is Our Light (from South Africa),
Christ the Lord Is Risen (from Ghana–West Africa)*

Lesson Study

Classes • "End Time Deceptions"

Theme Song

Make Me a Blessing

Make me a blessing; make me a blessing.
Out of my life may Jesus shine.
Make me a blessing; O Savior, I pray.
Make me a blessing; to someone today.

"Make Me a Blessing," Ira Bishop Wilson
©1924, Renewed 1952 Word Music, LLC; Used by Permission. CCLI License #392652

Benediction

Jimmer Mun

ORGANIST: Kenneth Logan
OFFERTORY: Slavujevic Family

WE WORSHIP 2

CONNECT • GROW • SERVE • GO

As We Begin

Allegro • Henry Heron

Praise

*Better Is One Day • I Give You My Heart
Your Grace Still Amazes Me*

Prayer

Rodlie Ortiz

Fare Thee Well, Pastors

Sabine Vatel and Sharon Terrell with Royce Snyman

Children's Story

With Wings as Eagles • Kenneth Logan

Worship in Music

His Eye Is on the Sparrow • Charles Gabriel

Sermon

"Gone to the Birds: Lessons from the Divine Ornithologist—1"
Dwight K. Nelson

Connect Card

Tithes & Offerings

I Know Whom I Have Believed • 511

As We Depart

The Heavens Declare God's Glory • Benedetto Marcello

WORSHIP COORDINATOR: José Bourget; ORGAN: Kenneth Logan
PRAISE LEADER: Sinegugu Katenga; VOCALS: Chad Angasan, Ivana Ticar, Kenric Rimoni
PIANO: Joshua Goines; BASS GUITAR: Lorian Guillaume; ACOUSTIC GUITAR: Randall Ulangca
MUSICAL SELECTIONS: Marguerite Samuel, soprano; Leslie Samuel, piano

SUBMIT bulletin announcements by visiting our form online at www.pmchurch.org/announcements/submit. Requests must be received Monday by 5:00 PM for consideration.

NEXT WEEK'S OFFERING
World Budget

SUNSET TODAY • 9:14
SUNSET NEXT FRIDAY • 9:18

PIONEER PULPIT

| 06 • 09 |

DWIGHT K. NELSON

"Gone to the Birds: Lessons from the Divine Ornithologist"—2

| 06 • 16 |

DWIGHT K. NELSON

"Gone to the Birds: Lessons from the Divine Ornithologist"—3

FINANCIAL FEATURE

PMC OPERATING EXPENSE

How amazing that we have a God who has set aside 24 hours so we can worship and rest, so we can be recharged to face another week. And what a blessing to worship together as a congregation! This fellowship with other believers is a refreshing break in the busyness of the week. If you feel blessed week after week by worshipping within the walls of PMC, please consider a gift today toward PMC Operating Expenses and add to your blessings of worship.

Family Vespers

TODAY • 8:00 PM
YOUTH CHAPEL

Vespers this evening will be a time of testimonies by graduates and others sharing stories of God's providence.

Global Church Member Survey

We are pleased our congregation was randomly selected to participate in an online global church member survey. An explanatory email from the pastor with a web link to the survey was sent this week to all Pioneer members with an email address on file at the church. If you did not receive that email, please call Claudia Sowler (471.3134) on Monday—numerous “unable to deliver” emails have been returned to the office for address correction. If you would like to participate in this survey, you may go to www.pmchurch.org/globalmembersurvey. Please submit your survey responses by June 7. Thank you.

Adventist Seniors Monthly Meeting

JUNE 10 • 1:00 PM
VILLAGE CHURCH

A haystack meal will be provided—cost \$5.00/person. There will not be a pot-luck meal, so do not bring any food items. All seniors, members or not, are invited to come fellowship with us.

Andrews University Health and Wellness

Andrews University Health and Wellness invites you to take advantage of our state-of-the-art 3-D Massage Chair, figure out your real body age and body composition with our full body sensor, and discover various ways to become A healthier U! Visit: www.andrews.edu/wellness for more information and to schedule appointments! Contact wellness@andrews.edu.

Berrien Springs 5K Color Run

JUNE 3 • 7:00 AM

Multicultural Ministries Department of the Lake Union Conference and ASAP Ministries are sponsoring as a fundraising project a 5K COLOR RUN that will take place on Sunday, June 3, at 7:00 AM on the Andrews campus. A special Color Run t-shirt will be provided for all those who register by May 24. Register online at www.berriencolorrun.com.

We GROW Better Together

We're pressing pause for the Summer but it's not too early to start planning what GROW Group you might want to lead for the Fall Semester between September 30 to December 9, 2018! Register your group at www.pmchurch.org/grow and help us build an intergenerational community where people can grow together in friendship with God and each other. Here are some ideas for groups: Happily Single, Pickleball, Baking Desserts, Women's Prayer Studies, Dads and Prayer. What's your idea? For more information, please contact Gracie Gaytan or Pastor Sabine Vatel at growgroups@pmchurch.org or 471.3133.

Farewell Picnic for Pastors Sharon & Sabine

TODAY • 1:30 PM

Church family—you are invited to a planned potluck lunch in the PMC Commons. Pioneer will provide dessert, drinks, plates, and eating utensils. To ensure a wonderfully memorable experience for everyone, please bring the following menu items.

A-H—Bring baked beans for 25 people, and a vegetable relish tray for 25 people.

I-P—Bring salad for 25 people, salad dressing if needed, and a large bag of chips.



Q-Z—Bring sandwiches for 25 people and a watermelon.



pioneer memorial church
FAMILY FINANCES

As of April 30, 2018

Includes April online giving



OPERATING FUND

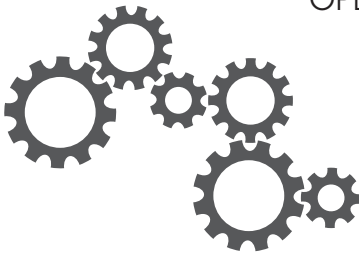

LINE 2 IN YOUR TITHE ENVELOPE

GOAL TO-DATE	195,177
RECEIVED TO-DATE	174,450
RECEIVED TO-DATE 2017	173,213

CHRISTIAN EDUCATION

LINE 3 IN YOUR TITHE ENVELOPE

GOAL TO-DATE	66,283
RECEIVED TO-DATE	55,674
RECEIVED TO-DATE 2017	55,366



MASTER PLAN OF EVANGELISM



LINE 5 IN YOUR TITHE ENVELOPE

GOAL TO-DATE	34,646
RECEIVED TO-DATE	36,788
RECEIVED TO-DATE 2017	35,340

| PASTORS | | STAFF |

Chaplain / Pioneer

José Bourget • 471.6254
bourget@pmchurch.org

Admin. Assistant

Lailane Legoh • 471.3543
legoh@pmchurch.org

Discipleship / GROW Groups

Sabine Vatel • 471.6153
vatel@pmchurch.org

Admin. Assistant / Clerk

Gracie Gaytan • 471.3133
clerk@pmchurch.org

Harbor of Hope

Taurus Montgomery • 269.210.6155
montgomery@pmchurch.org

Receptionist

Jackie Bikichky • 471.3133
bikichky@pmchurch.org

Lead Chaplain

June Price • 471.6282
juneprice@andrews.edu

Assistant Media Director

Gaddiel Zelaya Martínez • 471.3678
zelaya@pmchurch.org

Lead Pastor

Dwight K. Nelson • 471.3134
nelson@pmchurch.org

Assistant Treasurer

JoAnn Siagian • 471.7656
siagian@pmchurch.org

Stewardship

Sharon Terrell • 471.6151
terrell@pmchurch.org

Executive Assistant

Claudia Sowler • 471.3134
sowler@pmchurch.org

This Generation Evangelism

Rodlie Ortiz • 471.6154
ortiz@pmchurch.org

Graphic Designer

Brittany Doyle • 471.3647
bulletin@pmchurch.org

Youth Ministries

Ben Martin • 471.6176
martin@pmchurch.org

Maintenance

Larry White • 471.3649
white@pmchurch.org

Media Ministries

Richard Parke • 471.3246
parke@pmchurch.org

Music

Kenneth Logan • 471.3231
logan@pmchurch.org

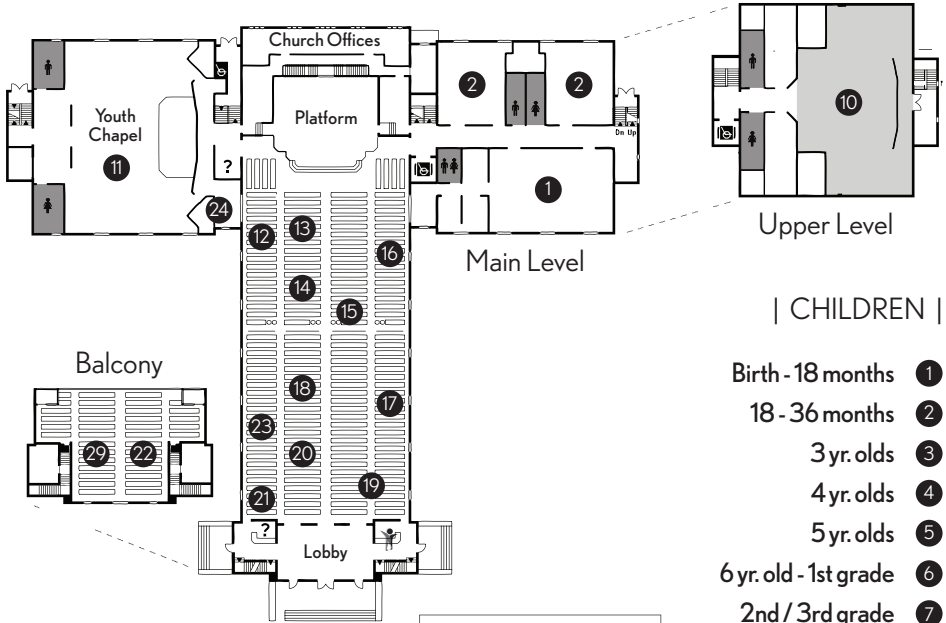

| CHILDREN |

- Birth - 18 months ①
- 18 - 36 months ②
- 3 yr. olds ③
- 4 yr. olds ④
- 5 yr. olds ⑤
- 6 yr. old - 1st grade ⑥
- 2nd / 3rd grade ⑦
- 4th grade ⑧
- 5th / 6th grade ⑨
- Earliteen ⑩
- Youth ⑪

| ADULT |

- ⑫ Group 1
- ⑬ Group 2 (Portuguese/Brazilian)
- ⑭ Group 3
- ⑮ Group 4 (Yugoslavian)
- ⑯ Group 5
- ⑰ Group 6
- ⑱ Group 7
- ⑲ Group 8
- ⑳ Group 9 (Spanish)
- ㉑ Group 10
- ㉒ Group 11 (Balcony)
- ㉓ Group 12 (French)
- ㉔ Conference Room
- ㉕ Something In Common
- ㉖ Young Adults
- ㉗ SDA Beliefs

| KEY |

- ? Welcome Centers
- ⬇ Elevators
- ♿ Restrooms
- 👤 Children's Activities & Lending Library

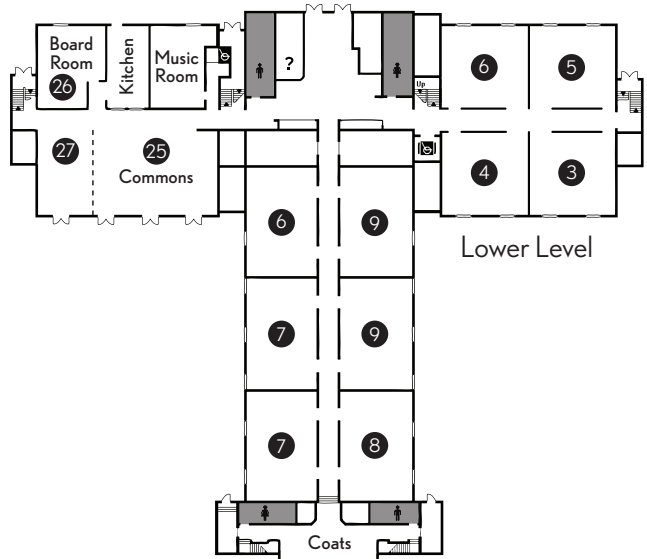

Lower Level

Andrews University Campus Map

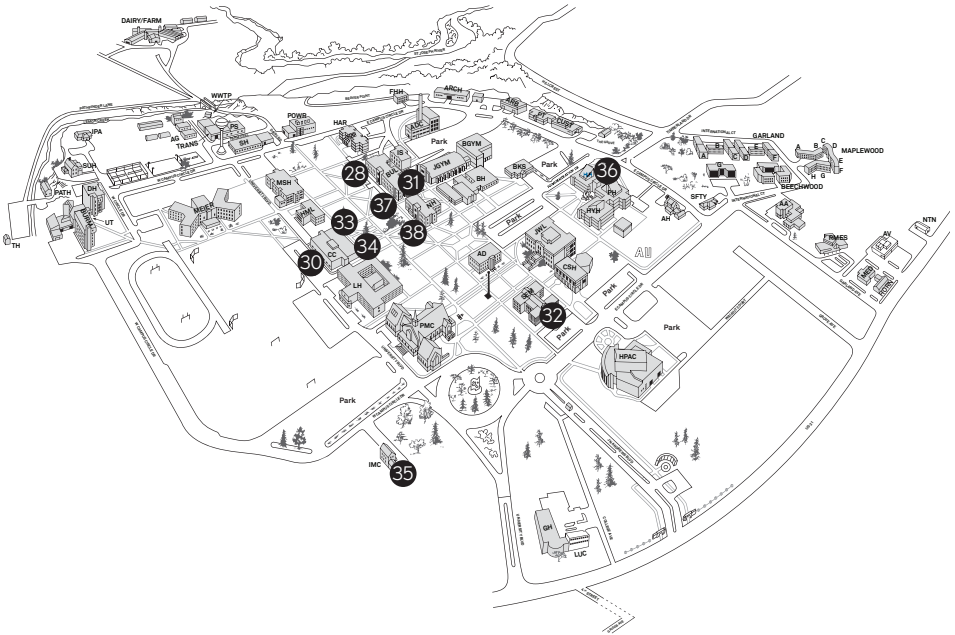

| COLLEGIATE |

- 28 H&M (Hispanic - Religion Amphitheater)
- 29 People on the Move (PMC)
- 30 University Sabbath School (Dining Services)
- 31 Compass Sabbath School (Buller - Religion Dept.)

| SEMINARY |

- 32 N108 (Collegiate)
- N110
- N120 (New Life Church Choir)
- N150
- N211 (Small Group)
- N235
- N310 (Russian)
- N335 (Spanish)
- S340 (Upper Room)

| ADULT @ AU |

- 33 Main Lounge
- 34 Faculty Lounge
- 35 Back to Basics
- 36 Living Word Fellowship
- 37 Current Events (Nethery Hall-134)
- 38 Bible Journey (Nethery - 143)

Farewell Pastor Sharon and Pastor Sabine!



In the ebb and flow of life and pastoring, we at Pioneer say "Good-bye and Godspeed" to two of our beloved pastors, Sharon Terrell and Sabine Vatel. One is retiring and the other is plunging into a new professional challenge as a hospital chaplain. And both will be dearly missed here at Pioneer by congregation and pastoral colleagues alike. Their spiritual and professional giftedness has blessed us all.

Farewell picnic in Commons 1:30 PM