

PIONEER CONNECT

FEBRUARY 28, 2015

Stories in the Rearview Mirror

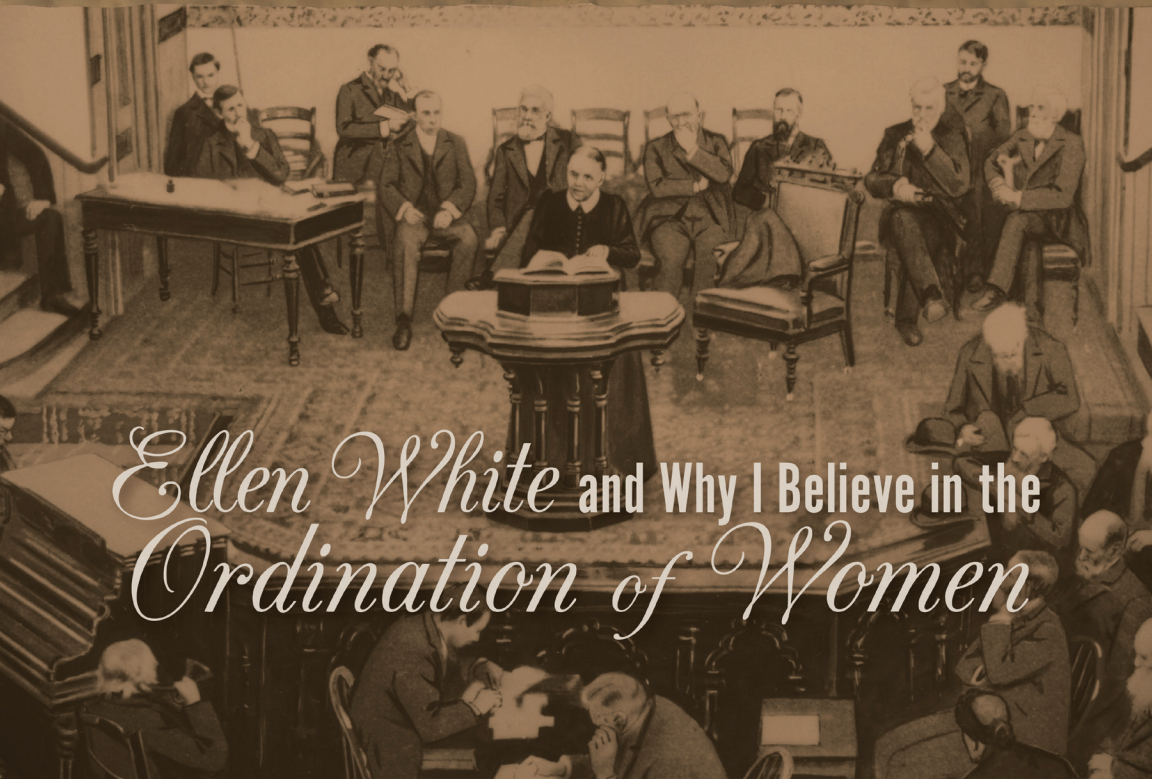

Ellen White and Why I Believe in the *Ordination of Women*

"IN THE BEGINNING, GOD..."

I was in a group of people, most of whom I had not met yet, and we had the task of brainstorming for the best strategies for kingdom growth. We began with prayer asking for divine wisdom, and challenged each other to think outside the box, and even discard the box altogether. To dream God-sized dreams is to consider contexts not realized, unlimited resources and fearlessness—and most importantly that only God's power can drive our mission. We were willing to go on the wild ride with Him.

Are you facing the unknown, unexpected chaos, or planning in your personal life, workplace or ministry? The Bible begins with "In the beginning God..." and this could be our reminder that we serve a creative God who's dream for us far exceeds our own. This morning, worshiping together is a good place to begin again and renew our vision of the God with outstretched arms and for whom nothing is impossible. (Jeremiah 32:17)
—Sabine Vatel

READY CAMERA ONE!

*Isabel Stafford, senior Math and Physics major, directs the video production from the PMC media control room during the Thursday Series.
(Photo taken by Emmanuel Leonard)*



FIND IT HERE

CONNECT • GROW • SERVE • GO



4

**THE FOURTH
WATCH BLOG**

“Global Flight From the
Family”

6

FEATURE ARTICLE

Media in the Nursery

8

PIONEER ONE

9:00 AM Worship

10

SABBATH SCHOOL

Words of Truth

11

PIONEER TWO

11:45 AM Worship

12

ANNOUNCEMENTS

15

**OPERATING
BUDGET**

16

CONTACTS

18

**SABBATH SCHOOL
DIRECTORY**

“GLOBAL FLIGHT FROM THE FAMILY”

That’s the headline of a *Wall Street Journal* piece last weekend, reporting the startling demise of the family as we know it, not only here in the United States but in Europe and Asia as well. “All around the world today, pre-existing family patterns are being upended by a revolutionary new force: the seemingly unstoppable quest for convenience by adults demanding ever-greater autonomy. . . . Thanks to this revolution, it is perhaps easier than ever before to free oneself from the burdens that would otherwise be imposed by spouses, children, relatives or significant others with whom one shares a hearth” (*WSJ* February 21-22, 2015, A11).

GOD SPEAKS A “LAST WORD” INTO THE CRISIS.

Consider these statistics:

- As of 2013 according to the Centers for Disease Control “40% of babies in the U.S. were born outside of marriage.”
- The Census Bureau for 2014 estimates that “27% of all children (and 22% of ‘White’ children) lived in a fatherless home.”
- A 2011 study reported “just 59% of all American children (and 65% of ‘Anglo’ or non-Hispanic white children) lived with married and biological parents as of 2009.”
- In Europe “the probability of marriage before age 50 has been plummeting for European women and men, while the chance for divorce for those who do marry has been soaring.”
- In Belgium “the likelihood of a first marriage for a woman of reproductive age is now down to 40%, and the likelihood of divorce is over 50%. This means that in Belgium the odds of getting married and

staying married are under one in five.”

- In Europe “the proportion of childless 40-something women is one in five for Sweden and Switzerland, and one in four in Italy. In Berlin and in the German city-state of Hamburg, it’s nearly one in three.”

- “In Western Europe, nearly one home in three (32%) is already a one-person unit, while in autonomy-prizing Denmark the number exceeds 45%.”

- In Japan “about one-sixth of Japanese women in their mid-40s are still single, and about 30% of all women that age are childless. Twenty years hence 38% of all Japanese women in their mid-40s would be childless, and an even higher share—just over 50%—would never have grandchildren.”

- South Korea, Singapore, Hong Kong—the statistics mirror those above.

- Even in less affluent Muslim-majority societies “a flight from marriage within the Arab world is in process,” indicating “high levels of income and educational attainment are not preconditions for the new family revolution in those spots on the globe it hasn’t reached.”

And who will suffer the most in this social revolution? Our children and our aged. The *WSJ* report concludes: “Our world-wide flight from family constitutes a significant international victory for *self-actualization over sacrifice*, and might even be said to mark a new chapter in humanity’s conscious pursuit of happiness. But . . . it is far from clear that humanity is prepared to cope with the consequences of its impending family deficit, with [its] increasing independence [from] those



traditionally most dependent on others—i.e., the young and the old” (emphasis supplied).

A global shift from sacrificing for the sake of others to caring only for one’s self. Must it come to this?

The Old Testament ends with this provocative prophecy: **“See, I will send the prophet Elijah to you before that great and dreadful day of the LORD comes. He will turn the hearts of the parents to their children, and the hearts of the children to their parents”** (Malachi 4:5-6). This prediction of a global movement to repair and restore the family clearly

presupposes endtime forces bent on destroying the divine edenic ideal of the nuclear family. The statistics are sobering, but God speaks a “last word” into the crisis. Could you and I become part of that restorative “last word?” Could we by our compassion and proactive care for the young and aged be instrumental in God’s effort to save not only the most vulnerable, but to save the family itself? Clearly, we can’t just sit here and do nothing, can we? So what shall we do? ■

You can follow Pastor Dwight’s blog at www.pmchurch.tv/blog.

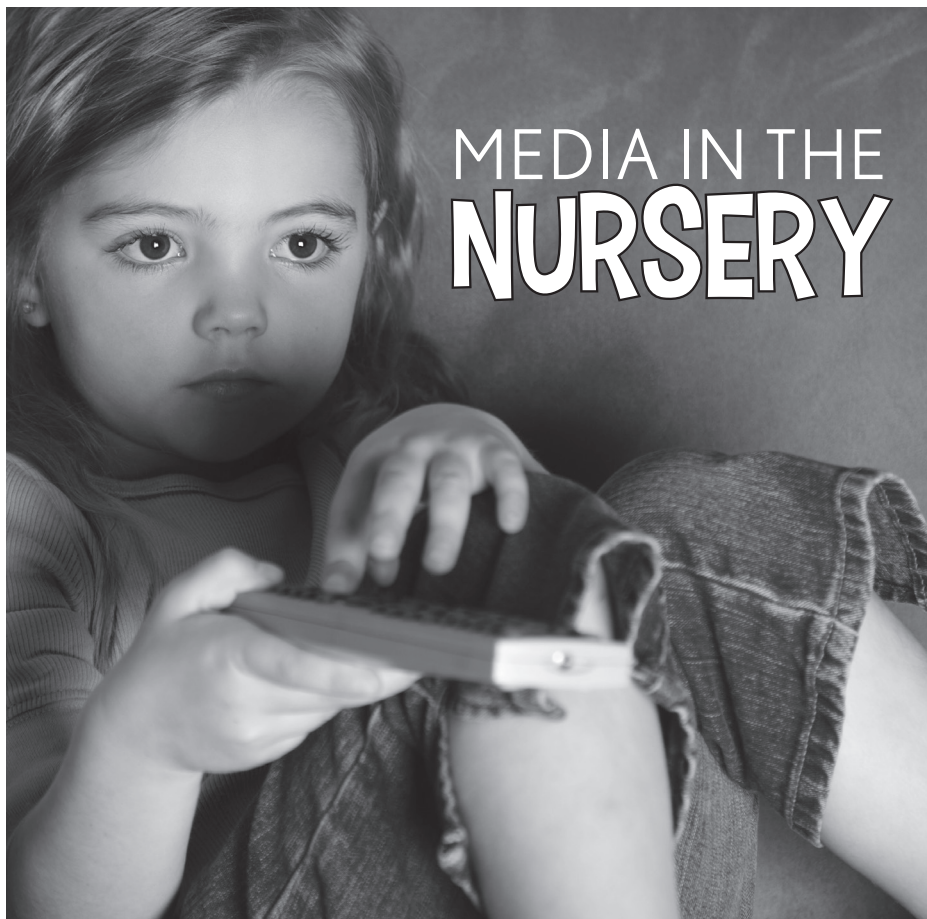

MEDIA IN THE NURSERY

BY LOIS LELLO-BURN

What is God's purpose for you and your children? Proverbs 22:6 says, "Train up a child in the way he should go and when he is old he will not depart from it." Train up is Hebrew for build up, lay the foundation or lay the groundwork for the future. These children are sacred gifts from God—a sacred stewardship temporarily entrusted to us.

WHAT DOES THE MEDIA HAVE TO DO WITH THE NURSERY?

Television still dominates kids' screen

time. Of the average 2 hours of screen time a day that young children are exposed to, 50% is spent in front of TV. Three fourths of all children 0 to 8 years of age have access to mobile devices in the home. Their average daily use of mobile devices has tripled from 5 to 15 minutes a day. Thirty-eight percent of all kids under 2 years old are tech-savvy toddlers who use a mobile device.

"I've never seen a new medium take hold among little kids this fast," said Rideout, a senior adviser to Common Sense

Media, and director of more than 30 studies on children, media, and health. "As many little babies and one-year-olds have used smartphones or tablets today as all kids under eight had done just two years ago."

"This is quite an extraordinary shift for our young children. In the past we could measure and control exactly where, when, and how they were engaging with screens. Now, mobile devices follow our kids from room to room," said James Steyer, CEO

CHILDREN ARE A GIFT OF THE LORD

and founder, Common Sense Media. "The media children consume can have a profound impact on their learning, social development, and behavior, and the only way to maximize the positive impact—and minimize the negative—is to have an accurate understanding of the role it plays in their lives."

HOW YOUNG IS TOO YOUNG TO WATCH TELEVISION?

Under the age of 2 we are not able to even decode the images that are seen on television. The light and color we see stimulate us but do not become meaningful content until the brain is more fully developed. Our brain develops in response to the environment that it needs to function in. As parents, we get to build the architecture of the child's brain.

There are three things that are important to build our children's brains. The first is bonding with human beings. Second, we need to learn to manipulate our physical environment. Third, we need to participate in open-ended problem-solving. All three of these tasks are short-circuited by media use under two. In this crucial time the brain

triples in volume and trims thousands of pathways to allow focus above the background of environmental "noise."

How do we engage media in a thoughtful way for our youngest family members?

MESSAGE MATTERS

All media teaches so choose media that teaches the lessons you want your children to learn. Music and books are great for kids under 2 years old.

ENVIRONMENT MATTERS

Create environments for infants and toddlers with child-friendly MP3 player, radios and illustrated board & soft books. Media in the form of screens distracts babies and toddlers from meaningful manipulative play activities.

DEVELOPMENTAL STAGES MATTER

Support the intense rapid brain development by encouraging creative problem-solving play and opportunities to interact with your child's physical environments as she develops relationships with family and friends.

INFORMATION MATTERS

Research and review media yourself before sharing it. Look into family-friendly reviews to inform your decisions on media.

AMOUNT MATTERS

Spend time reading to your baby. The touch of your hand, sound of your voice and the texture of the pages will stimulate their development. Children below the age of 2 years are not to be exposed to any screen media. So limit screen time with the babies around.

Remember, "Children are a gift of the Lord, the Fruit of the womb is a reward. Like arrows in the hand of a warrior so are the children of one's youth." Psalms 127:3,4. ■

Lois Lello-Burn is an M.D. and the director of Birth through 18 months Sabbath School.

FAMILY WORSHIP

CONNECT • GROW • SERVE • GO

Opening Voluntary

Toccata in G • Heinrich Scheidemann

Introit

Let Thy Holy Presence • Pavel Chesnokov

Call to Worship

Sabine Vatel

Let us speak our prayers of praise and thanksgiving.

We cannot be silent, when the wonders of God's ways are before us.

We praise you, God, for the hope to which Christ is herald.

We thank you, God, that trust in your grace is never misplaced.

Doxology

Praise God, From Whom All Blessings Flow • 2

Invocation

Dwight K. Nelson

Hymn of Praise

All Creatures of Our God and King • 2

Congregational Prayer Response

Sabine Vatel
Hear Our Prayer, O Lord • George Whelpton

Worship in Music

When I Survey the Wondrous Cross • Gilbert Martin

Kingdom Growth

Sabine Vatel, Rodlie Ortiz

Children's Story

Now We Pray for the Holy Spirit • Dieterich Buxtehude

Scripture

Acts 2:17-21 NIV • Kelly Gabriel & Timothy Dolan

"In the last days, God says, I will pour out my Spirit on all people.

Your sons and daughters will prophesy, your young men will see visions, your old men will dream dreams.

Even on my servants, both men and women, I will pour out my Spirit in those days, and they will prophesy.

I will show wonders in the heavens above and signs on the earth below, blood and fire and billows of smoke.

And everyone who calls on the name of the Lord will be saved."

Hymn of Preparation

Hover O'er Me, Holy Spirit • 260 (stanzas 1 & 4)

Sermon

*“Stories in the Rearview Mirror:
Ellen White and Why I Believe in the Ordination of Women”*
Dwight K. Nelson

Connect Cards, Tithes & Offerings

PMC Operating

Hymn of Commitment

Rise Up, O Church of God • 615

Benediction

Benediction Response

God Be With You • Ralph Vaughan Williams

Closing Voluntary

Fugue in E-Flat • Johann Sebastian Bach

PRESIDING PASTOR: Sabine Vatel; ORGANIST: David Williams
WORSHIP IN MUSIC: PMC Sanctuary Choir, Jeannie Pedersen-Smith, director

MUSIC ALIVE

SOMETHING NEW!

This column normally is devoted to music that will be in both the 9:00 AM and the 11:45 AM worship services. However, this week's *Music Alive* is about a new feature in the worship of Jehovah God at Pioneer—a new church choir! This week they will sing at the 9:00 AM service only, but on March 14 the choir will expand to sing in both the 9:00 AM and the 11:45 AM worship services. With the energetic, capable leadership of

Jeannie Pedersen-Smith, what a sizable turnout of singers there has been! This new PMC Sanctuary Choir is scheduled to sing monthly through May, interweaving with the schedule of our schools' ensembles in PMC. There still is room for more singers—jean.pedersen.smith@gmail.com or 269.277.0488, voice or text for information. Praise the Lord with the voices! ■

WE STUDY

CONNECT • GROW • SERVE • GO

Song Service	Vladimir Slavujevic
Opening Hymn	<i>I Sing the Mighty Power of God</i> • 88
Welcome	Philip Giddings III
Prayer and Scripture	Proverbs 22: 20-23 NLT Sion Kim & Einra Baker
Special Feature	<i>The Boeing 747 Challenge</i> • Veronica Johnson
Offertory	<i>I Need You, Lord</i> • Josh Bales
Bible Study	"Words of Truth" • Classes
Theme Song	<i>Make Me a Blessing</i>

Make me a blessing; make me a blessing.
Out of my life may Jesus shine.
Make me a blessing; O Savior, I pray.
Make me a blessing; to someone today.

"Make Me a Blessing," Ira Bishop Wilson
©1924, Renewed 1952 Word Music, LLC; Used by Permission. CCLI License #392652

Benediction	Vladimir Slavujevic
--------------------	---------------------

ORGANIST: David Williams; OFFERTORY: Cristy Doria, soprano and Rachel Lynne Brantley, piano

See page 18/19 for Sabbath School directory & map

WE PRAISE

CONNECT • GROW • SERVE • GO

As We Begin

Toccata in G • Heinrich Scheidemann

Introit

Alleluia Praise • Paul Basler

Praise

I Can Only Imagine • Hosanna • Let My Words Be Few

Prayer

Sabine Vatel

Kingdom Growth

Sabine Vatel, Rodlie Ortiz

Worship in Music

If Love Should Count You Worthy • James Mulholland

Sermon

“Stories in the Rearview Mirror:

Ellen White and Why I Believe in the Ordination of Women”

Dwight K. Nelson

Connect Card, Tithes & Offerings

Closing Hymn

Rise Up, O Church of God • 615

As We Depart

Fugue in E-Flat • Johann Sebastian Bach

WORSHIP DIRECTOR: José Bourget; ORGANIST: David Williams

PLATFORM MANAGER: Debbie Weithers; MUSIC DIRECTOR: Ilana Cady

VOCAL DIRECTOR: Josh Ahn; PIANO: Ellen Yoon; KEYS: Jonathan Dominique;

ACCOUSTIC GUITAR: Brenden Croughan, Josh Ahn; BASE GUITAR: Jason Lee

DJEMBE: Stacey DePluzer; VOCALS: Dawn Roselio, Kyrk Defino, Melissa Ruhupatty

WORSHIP IN MUSIC: Andrews University Choral Union, Stephen Zork, director; Rachelle Gensolin, piano

PIONEER PEOPLE**SUNSET TODAY** • 6:32
SUNSET NEXT FRIDAY • 6:40

SUBMIT announcements by emailing bulletin@pmchurch.tv or by going to www.pmchurch.org and click on “submit a bulletin announcement.” Requests must be received Monday by 5:00 PM for consideration.

WEEK AT A GLANCE

| SATURDAY |

FAMILY VESPERS

6:00 PM • YOUTH CHAPEL

| WEDNESDAY |

HOUSE OF PRAYER

7:00 PM • YOUTH CHAPEL

| FRIDAY |

UNIVERSITY VESPERS

7:30 PM • PMC SANCTUARY

PIONEER PULPIT

| 03 • 07 |

DWIGHT K. NELSON

“Stories in the Rearview Mirror: Why I Believe in the Third Person’s Last Rain”

| 03 • 14 |

RODLIE ORTIZ**Sanctuary Flowers**

Today’s flowers are given in memory of Robert and Ilea McDaniel from their church family.

Family Vespers

TODAY • 6:00 PM

YOUTH CHAPEL

How is Christ active in your life? This evening we will watch The Encounter and discuss this vital question.

Winter Classical Concert & Free Dinner

TONIGHT • 5:00 PM

EAU CLAIRE SDA CHURCH

Join us for this rescheduled event and enjoy the works of great composers. Immediately following the annual Winter Classical Concert will be a free Valentine’s Dinner provided by the Eau Claire Critters Pathfinder Club (dinner donations are always accepted but not expected).

Old-time Gospel and Hymn Sing-a-Long

TONIGHT • 6-7 PM

VILLAGE CHURCH

Join us in picking old favorites rarely sung. Invite your neighbors who might know these oldies. Come and share your voice to end the Sabbath.

Memorial Service

MARCH 1 • 2 PM • PMC SANCTUARY

Longtime members of this congregation, Bob and Ilea McDaniel were active in the community and on campus (37 years as the campus barber). Their untimely death while returning home from the holidays is tempered by the memory of their gracious living. Join the family from across the nation on March 1, as we remember and look forward to the “blessed hope” of Jesus’ return.

Andrews Filipino International Association

MARCH 1 • 3:00 PM
ANDREWS ACADEMY

Andrews Filipino International Association invites you to Andrews Academy as we learn about one of the Philippines’ greatest heroes: Jose Rizal. You will be entertained, educated, and fed. For ticket information email afia@andrews.edu.

Michigan Camp Meeting Registration

MARCH 5-15

To register for Camp Meeting 2015, go to the misda.org website and click on *Camp Meeting Registration*, or visit tinyurl.com/pzslq3t. The March *Michigan Memo* also contains a camp meeting application. For assistance contact Jody Murphy at 517.316.1512 or jmurphy@misda.org.

Hooked on Games

MARCH 5 • 7:00 PM
ANDREWS ACADEMY

Andrew and Julie Doan present to parents and students on how your family can win the battle over gaming & technology overuse. For information contact Deborah Weithers at rdw@andrews.edu or 471.6684.

Baptismal Class Grades 4-8

WEDNESDAY 4-5 PM; THURSDAY 5-6 PM;
FRIDAY 1:30 PM • PMC

The first week of March will be the beginning of small group baptismal classes to encourage young people in understanding what they believe and how they can build their relationship with Jesus. To join one of these groups contact the PMC office at 471.6565 or genaida@andrews.edu.

AU Department of Music Showcase Recital

MARCH 5 • 7:00 PM •
HOWARD CENTER

The Department of Music Faculty presents a Showcase Recital as part of the Andrews Band & Keyboard Music Festival. All are invited. Admission is free.

AU Department of Music Vesper Concert

MARCH 6 • 7:00 PM
HOWARD CENTER

The Wind Symphony will perform in a Vesper Concert. The University Singers, under the direction of Stephen Zork, will also perform. Admission is free.

AU Band & Keyboard Music Festival Concert

MARCH 7 • 4:00 PM
HOWARD CENTER

Ninety-seven academy students from four states and Canada present the Andrews Band & Keyboard Music Festival Concert.

Women’s Ministry

If you have any really great ideas or would like to help out with Women’s Ministry at PMC, contact Sallie Alger at salger@andrews.edu.

Sanctuary Choir Call

WEDNESDAYS • 7:00-8:30 PM
PMC TEEN LOFT

Join the Sanctuary Choir! Come rehearse with us in the PMC Teen Loft. Contact Director Jeannie Pedersen-Smith at jean.pedersen.smith@gmail.com or 269.277.0488, voice or text.

Adventist Retirees of Michiana

MARCH 8 • 1PM • VILLAGE CHURCH

You are invited to a meeting and potluck. To join bring a dish for 8-12 people. The featured speaker is Rex Welch, WWII veteran who will share stories and memorabilia. If you are a veteran and have pictures or items that you are willing to share, please bring them to display. For information contact Mike or Shirley Gammon at 989.427.5669.

Academy Day

MARCH 10 • 7:30 AM-2:15 PM
ANDREWS ACADEMY

Andrews Academy is hosting a special day on which any 8th-graders are welcome to come, explore, and get to know about Andrews Academy. For information contact Hannah Smoot at 471.6140 or email smoot@andrews.edu.

The Journey to Wholeness

FRIDAYS • 10 TO 11 AM

ANDREWS SEMINARY HALL RM N-108

SATURDAYS • 10:15 TO 11:15 AM

ANDREWS NETHERY HALL RM NH-134

The Journey to Wholeness 12-step meetings offer hope and help in addressing challenges, to help you become the person God and you intend. For information email adventistrecovery@gmail.com or call 240.346.5204.

**Children's Ministry
Resource Center**

CMRC needs two volunteers to input data into the Center's resource database and scan paper resources to make them available digitally. Volunteers should be comfortable with computer-based work, file management, and organization. Contact Debi Robertson, CMRC Associate Director, at 471.7150.

Give the Gift of Service

Pioneer member and Andrews alumna Keitha Grant invites you to partner with herself and *Students for International Mission Service* (SIMS) as they conduct mobile clinics & health fairs in Bolivia, March 20-29. To sponsor a participant or make a general donation, please visit <http://tinyurl.com/p664y75> or call SIMS at 909.558.8089. Thank you!

The Creation Case

MARCH 31 • 7PM • HPAC

World Premiere and Dedication event for this 13-part video series produced by Rich Aguilera. Screen episode #1, meet the cast, get a copy, watch the blooper reel, and more. This event is free and open to all.

Women's Retreat

APRIL 3-5, 10-12, 17-19

CAMP AU SABLE

Find your direction at the 2015 Michigan Conference Women's Retreat. For information and registration visit www.misda.org and click on Women's Ministry or call 517.316.1565.

Horn Museum Exhibits

Visit the exhibit, "Figurines of Tall Jalul" at the museum until late April. For information call 471.6180.

PMC 2015 OPERATING BUDGET

The 2015 PMC Operating Budget will be presented for approval during a business meeting on March 9 at 7:00 PM. Detailed budget information is available at each welcome center and at the church office.

2015 BUDGET SUMMARY

	Budget 2015	Budget 2014	Actual 2014
NET ASSET BEGINNING BALANCE	\$711,289	\$941,366	\$941,403
INCOME			
<i>Church Family Finance Goals:</i>			
Church Operating	\$610,000	\$610,000	\$637,433
Kingdom Growth	100,000	0	0
Christian Education	211,695	222,913	211,695
Master Plan for Evangelism	139,800	127,000	126,987
Building Fund	45,000	45,000	44,979
Student Aid	55,000	55,000	56,146
Total Family Finance Goals	\$1,161,495	\$1,059,913	\$1,077,240
Other Evangelism	182,122	223,755	119,576
Sabbath School	44,180	44,106	44,363
Youth/Outreach Ministries	133,500	133,431	196,253
Television/Media Ministry	317,000	299,500	446,044
Other Income	153,601	132,921	221,011
TOTAL INCOME	\$1,991,898	\$1,893,626	\$2,104,487
EXPENSES			
Evangelism Programs	\$350,908	\$338,628	\$290,515
Sabbath School	71,450	77,865	79,568
Youth/Outreach Min/GROW	176,915	177,636	250,658
Christian Educ./Student Aid	301,645	342,163	313,572
Church Operations	487,722	435,523	421,858
Building/Maintenance	183,544	277,187	230,151
Television/Media Ministry	376,870	346,500	603,062
Other	97,010	74,900	145,179
TOTAL EXPENSES	\$2,046,064	\$2,070,402	\$2,334,563
Net Increase (Decrease)	(54,166)	(176,776)	(230,076)
NET ASSET ENDING BALANCE	\$657,123	\$764,590	\$711,327

| PASTORS | | STAFF |

Chaplain / Pioneer • José Bourget
bourget@pmchurch.org
471.6254

Discipleship / GROW Groups
Sabine Vatel
vatel@pmchurch.org
471.6153

Harbor of Hope • Taurus Montgomery
montgomery@pmchurch.org
269.923.9274

Lead Chaplain • June Price
madrigal@andrews.edu
471.6282

Lead Pastor • Dwight K. Nelson
nelson@pmchurch.org
471.3134

Pastoral Care • Don Dronen
dronen@pmchurch.org
471.3133

Stewardship • Sharon Terrell
terrell@pmchurch.org
471.6151

This Generation Evangelism
Rodlie Ortiz
ortiz@pmchurch.org
471.6154

Youth Ministries • 471.6176

Media Ministries • Nick Wolfer
wolfer@pmchurch.org
471.3246

Music • Kenneth Logan
logan@pmchurch.org
471.3231

Admin. Assistant • Genaida Benson
benson@pmchurch.org
471.6565

Admin. Assistant • Lailane Legoh
legoh@pmchurch.org
471.3543

Asst. Media Dir. • Jonathan LaPointe
lapointe@pmchurch.org
471.3678

Assistant Treasurer • JoAnn Siagian
siagian@pmchurch.org
471.7656

Bible Work Coordinator
Tabitha Umali
tabitha.umali@pmchurch.org
269.340.2031

Clerk • Jackie Bikichky
bikichky@pmchurch.org
471.3972

Communications • Rebecca Coleman
rebecca.coleman@pmchurch.org

Executive Assistant • Sherrie Davis
davis@pmchurch.org
471.3134

Graphic Designer • Rachele Offenback
bulletin@pmchurch.org
471.3647

Maintenance • Larry White
white@pmchurch.org
471.3649

| MINISTRIES |

| SABBATH SCHOOL |

Adventurers • Daniel González
adventurers@pmchurch.org
423.432.0780

Adult • Judy Aitken
adultss@pmchurch.org
240.7997

Deacons • Milan Vajdic
deacons@pmchurch.org
471.0328

Birth - Grade 1 • Claudia Davisson
bg1@pmchurch.org
269.208.7081

Deaconesses • Vida Giddings
deconesses@pmchurch.org
473.2175

Grade 2 - Earliteen • Robert Barnhurst
g2teen@pmchurch.org
473.1613

Elders • Russell & Cynthia Burrill
elders@pmchurch.org
473.3738

| OUR SCHOOLS |

Andrews Academy • Robert Overstreet
overstrr@andrews.edu
471.3148

GROW Groups
growgroups@pmchurch.org

Andrews University
enroll@andrews.edu
471.7771 or 800.253.2874

Health • Evelyn Kissinger
health@pmchurch.org
930.0505

Ruth Murdoch / K-8 • David Waller
waller@andrews.edu
471.3225

Pathfinders • Matthew Johnson
evergreenpathfinders@gmail.com
240.755.2661

Public Address • Joel Kitchen
audio@pmchurch.org



PIONEER MEMORIAL CHURCH

8655 UNIVERSITY BOULEVARD, BERRIEN SPRINGS, MI 49103

OFFICE HOURS

Monday – Thursday (8 to 5) • Friday (8 to 12)

PHONE – 269.471.3133

FAX – 269.471.6152

LIVE STREAMING

www.pmchurch.tv
Sabbath 11:45 AM

ONLINE

www.pmchurch.org
www.pmchurch.tv

RADIO

WAUS – 90.7 FM
Sabbath 11:30 AM

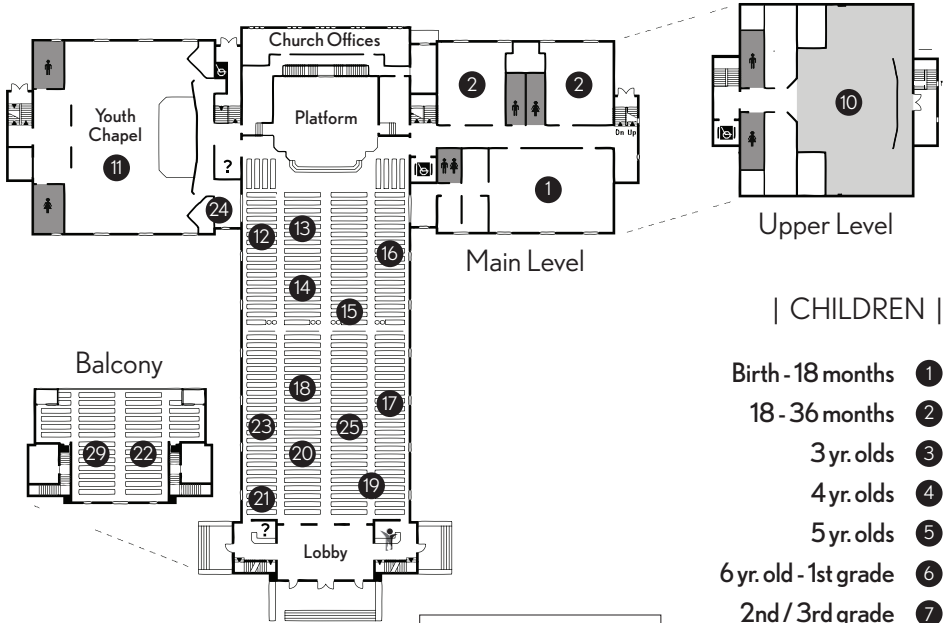

| CHILDREN |

- Birth - 18 months ①
- 18 - 36 months ②
- 3 yr. olds ③
- 4 yr. olds ④
- 5 yr. olds ⑤
- 6 yr. old - 1st grade ⑥
- 2nd / 3rd grade ⑦
- 4th grade ⑧
- 5th / 6th grade ⑨
- Earliteen ⑩
- Youth ⑪

| ADULT |

- ⑫ Group 1
- ⑬ Group 2 (Portuguese/Brazilian)
- ⑭ Group 3
- ⑮ Group 4 (Yugoslavian)
- ⑯ Group 5
- ⑰ Group 6
- ⑱ Group 7
- ⑲ Group 8
- ⑳ Group 9 (Spanish)
- ㉑ Group 10
- ㉒ Group 11 (Balcony)
- ㉓ Group 12 (French)
- ㉔ Conference Room
- ㉕ Indonesian Class
- ㉖ Something In Common
- ㉗ SDA Beliefs

| KEY |

- ? Welcome Centers
- ⬇ Elevators
- ♿ Restrooms
- 👤 Children's Activities & Lending Library

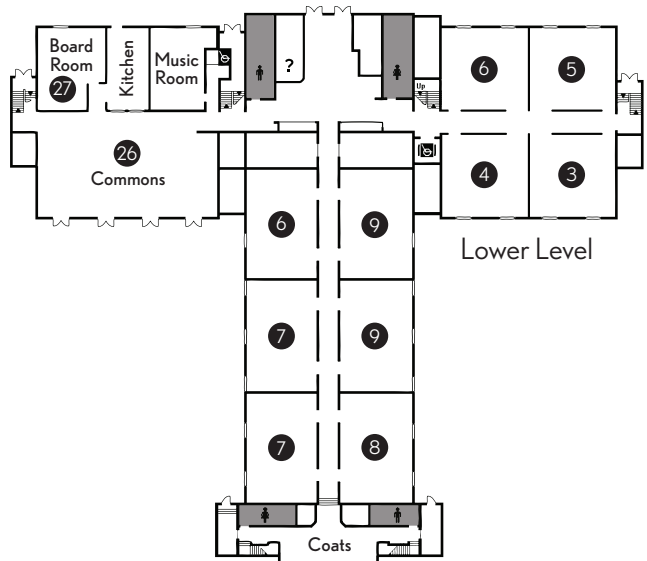

Lower Level

Andrews University Campus Map

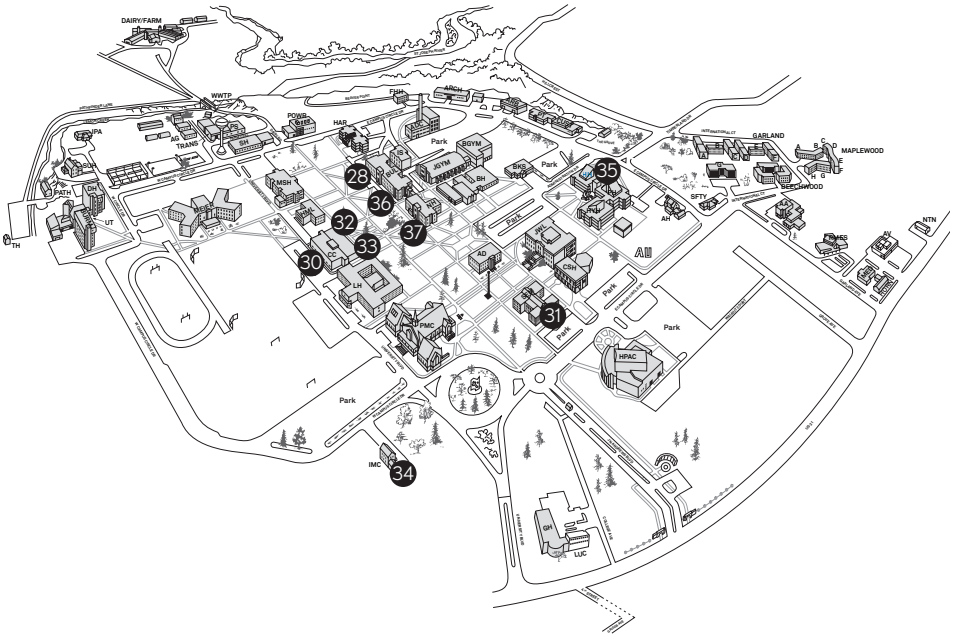

| COLLEGIATE |

- 28 H&M (Hispanic - Religion Amphitheater)
- 29 People on the Move (PMc)
- 30 University Sabbath School (Dining Services)

| ADULT @ AU |

| SEMINARY |

- 31 N108 (Collegiate)
- N110
- N120 (New Life Church Choir)
- N150
- N211 (Small Group)
- N235
- N310 (Russian)
- N335 (Spanish)
- S340 (Upper Room)

- 32 Main Lounge
- 33 Faculty Lounge
- 34 Back to Basics
- 35 Living Word Fellowship
- 36 Current Events (Buller - 135)
- 37 Bible Journey (Nethery - 143)

VISITORS' DAY

RUTH MURDOCH ELEMENTARY SCHOOL

TUESDAY, MARCH 10

Grades 1-6 • 8:15 AM-12:30 PM
Grades 7-8 • 8:15 AM-3:30 PM



Experience the RMES community in action!

We offer Christian education, high academic standards, and positive peer influence from Kindergarten through grade 8—all close to home.

Lunch will be provided

An Andrews University School • www.myRMES.org • 8885 Garland Ave., Berrien Springs, MI 269.471.3220