

# PIONEER CONNECT

AUGUST 8, 2015

## Diversity Yet Unity



## A HOUSE FOR ALL NATIONS

As we look around, we will find reminders that we have entered a "house of prayer." We are not only reminded of it because of the stained glass, the singing, the kneelings or even because the insignia in the back wall says so. The reminders of God's house of prayer are in our diversity. Isaiah 56:7 says that God will build a house of prayer for all nations!

As we look around, we will see people from many backgrounds who bring with them rich stories, traditions, and spiritual gifts. We are diverse and united by God's invitation to be His.

Welcome! May God make us joyful in His presence as we gather and worship together. -Sabine Vatel

---

### SUMMER GRADUATION

*Our own Debbie Weithers and Erica Griessel celebrate their MA degrees in Leadership this past weekend.  
(Photo credit: Sarah Lee)*



# FIND IT HERE

CONNECT • GROW • SERVE • GO

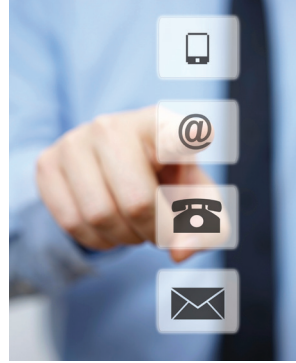

---

**4**

**FEATURE ARTICLE**  
Fess Up and Be Free

---

**8**

**ANNOUNCEMENTS**

---

**12**

**CONTACTS**

---

**6**

**PIONEER  
@ WORSHIP**  
9:00 & 11:45 AM

---

**11**

**SABBATH SCHOOL**  
Esther and Mordecai

---

**14**

**SABBATH SCHOOL  
DIRECTORY**

---

# FESS UP AND BE FREE

*“When sin becomes bitter, then Christ becomes sweet.”*  
*—Thomas Merton*

BY EV MILLINER

October 11, 2014, was a significant date in regard to my spiritual journey. In order to do justice to my testimony and the work God has done in my life, I must set a reference point as to where I was in order to show where God has brought me. One of the biggest things I struggle with is the desire to be seen as perfect by my own merits. I saw character growth as a competition and a way to measure how good I was compared to others. As a result, I fell into the mind-set of placing sin into different categories, and I have come to the conclusion that this is wrong. I would look down on other people and uplift myself because my sin wasn't as bad as theirs.

Romans 6:23 clearly states that the wages of sin is death regardless of how small or big it may seem. I would think of myself as a pretty good person and I figured my “God encounter” would eventually happen. See, the problem is not seeing yourself as a good person, the problem comes when the pursuit of God no longer becomes a priority and we become complacent. Jeremiah 29:13 says, “You will seek Me and find Me when you search for Me with all your heart.” God is not just going to appear to us and magically make us Christians: God wants to be pursued, and it's the only way we truly become war-

riors for Christ. So, as you can see, I had set myself up for failure.

I have been through a number of trials and troubles in my short life that left me questioning God, but I now know it was because I was never meant to go through my trials alone. In the 21st century it's a disgrace to be seen as weak. In movies, songs, and social media you have to be strong, mentally and physically. In and of itself, there is nothing wrong with this; however, humanity has a tendency of overlapping things and making our earthly practices spiritual ones, when, in fact, we should be allowing our spiritual practices to pour out into everything else.

I remember walking through church one Sabbath and I casually asked an acquaintance how he was doing. He immediately said, “Spiritually, not good.” I felt awkward, yet amazed. Why? Because that is unheard of! No one wants to be seen as weak, but we all want help. How are we supposed to get help if you don't tell anyone? Last summer, I felt convicted of my complacency. I remember sitting in staff worship at FLAG Camp and listening to a co-counselor pour out their heart. I truly admired that, wanting the same thing: The ability to share what is truly on my heart, so others could see how God is working in my life.

---

**GOD IS NOT  
 JUST GOING  
 TO APPEAR  
 TO US AND  
 MAGICALLY  
 MAKE US  
 CHRISTIANS.**

---



That started an uphill journey in my spiritual walk until October 11, 2014. That day was my breaking point. None of my friends were in Berrien, my parents were out of town and I was alone. I went to New Life and distinctly remember Chaplain Polite preaching a sermon on clothing and outward appearance. At the end of the sermon I was literally sobbing in public. This was not me crying because I felt God's presence: this was me crying because I felt ashamed and it was the first time I felt truly separated from God: cold, dark, and empty. I felt like God was telling me that this was it: I could either move forward, search Him out, and dedicate my heart to pursuing Him. Or I could go back and live that pixie-dust, covered up, glossy complacent life I was once living. I

realized that I was feeding off of the spirituality of others and now God was calling me to have my own relationship with Him. God graciously let me fall; and, looking back, I know in my heart I wouldn't have it any other way. I know what is required of my life, I know what is required of me. As bad as it may be, my prayer is to count it all a joy. I know it isn't going to be easy, but if God is with me, who can be against me? Though the shadows may fall and darkness come upon me, I must shine the light. I will prevail. ■

*Ev Milliner is pursuing an Elementary Education degree here at AU.*

# WE WORSHIP

CONNECT • GROW • SERVE • GO

**Opening Voluntary** *Holy Ghost, With Light Divine • Healey Willan*

**Introit** *Come, Holy Spirit • John Dykes*

**Call to Worship** Sabine Vatel

We are many diverse persons gathered here.

**Bind us into one body, Beloved God.**

We have brought many diverse hopes to this day.

**Blend them into one sacred hope, Beloved God.**

**Doxology** *Praise God, From Whom All Blessings Flow • 2*

**Invocation** Sharon Terrell

**Hymn of Praise** *Come, Thou Almighty King • 71*

**Congregational Prayer** Sabine Vatel  
*Blest Be the Tie That Binds • st. 1 & 2 of 350*

**Worship in Music** *Prelude in E Minor • Felix Mendelssohn*

**Children's Story** *I Want to Walk as a Child of the Light • Wayne Wold*

**Scripture** 1 Corinthians 12:1, 4-6, 27, 13a, 14 NKJV, CEB • Joan Banks

Brothers and Sisters, concerning spiritual gifts, I do not want you to be ignorant. There are diversities of gifts, but the same Spirit.

**There are differences of ministries, but the same Lord. And there are diversities of activities, but it is the same God who works all in all;**

One and the same Spirit works all these things, distributing in each one individually as He wills.

**Now you are the body of Christ, and members individually. For by one Spirit, we were all baptized into one body. For, in fact, the body is not one member, but many.**

**Hymn of Preparation** *O for That Flame of Living Fire • st. 1, 5 of 264*

**Sermon** "Diversity Yet Unity" • Sharon Terrell

**Connect Cards, Tithes & Offerings**

Oakwood / AU / LLU

**Hymn of Commitment**

*I'll Go Where You Want Me to Go* • 573

**Benediction**

**Closing Voluntary**

*Come, God Creator, Holy Spirit* • Johann Sebastian Bach

PRESIDING PASTOR: Sabine Vatel; ORGANIST: Kenneth Logan

WORSHIP IN MUSIC: Anne Loura, piano

---

# MUSIC ALIVE

## SPIRIT, WIND AND MUSIC

**T**oday's Worship in Music seems not to reference directly the biblical concept of the Holy Spirit as wind. But from its very first notes this music is infused with rippling figures (to invoke a concept familiar in water) that sound much as vigorous wind blowing this way and that, varied yet persistent. Indeed, Mendelssohn is unlikely to have intended

such a reference. But he did compose many Songs Without Words for piano solo, so it is not foreign to his thinking for sheer piano music to associate with word images. Tucked into the apparent musical gusts of wind is a beautiful, flowing melody that is eloquent in its simplicity, a melody of pathos and spirit, a melody of grace and strength. ■

**PIONEER PEOPLE****SUNSET TODAY** • 8:58  
**SUNSET NEXT FRIDAY** • 8:49

**SUBMIT** announcements by emailing [bulletin@pmchurch.tv](mailto:bulletin@pmchurch.tv) or by going to [www.pmchurch.org](http://www.pmchurch.org) and click on "submit a bulletin announcement." Requests must be received **Monday by 5:00 PM** for consideration.

**WEEK AT A GLANCE****| SATURDAY |****FAMILY VESPERS**

8 PM • PMC YOUTH CHAPEL

**| SUNDAY |****RMES CLEANING-BEE**

8 AM TO 12 PM • RMES

**ADVENTIST RETIREES**

1 PM • WOLF PRAIRIE PARK

**| THURSDAY |****ROTARY BARBEQUE**

4-7 PM • MIDDLE SCHOOL

**PIONEER PULPIT****| 08 • 15 |****DWIGHT K. NELSON**University Fall Fellowship: "Engage Globally:  
How to Discover Blessed Reciprocity"**| 08 • 22 |****DWIGHT K. NELSON**New Student Welcome: "Engage Globally:  
How to Join the New Legion—Clothed, in  
Your Right Mind and Sent"**Visitors' Dinner**

Join us today after second service in the PMC Commons (downstairs) for a home-cooked vegetarian meal.

**Family Vespers**TODAY • 8:00 PM  
PMC YOUTH CHAPEL

Join us this evening as we listen to Pastor Sean Brizendine present "Overcoming the Four-fold Attack."

**Fall GROW Group Leaders**Sign up your GROW Group via [www.pmchurch.org/newgrowgroup](http://www.pmchurch.org/newgrowgroup). Have an idea for a group you'd like to lead between September 27 and December 13? "How to Give a Bible Study," "Parenting," "Study on the Beatitudes," or "Learn Golf" are just a few of the suggestions received. Help us build a community where members and visitors grow through meaningful connections with each other and with God. For questions email [growgroups@pmchurch.org](mailto:growgroups@pmchurch.org).**RMES Cleaning-Bee**TOMORROW • 8:00 AM TO 12:00 PM  
RMES

Join us as we beautify our building and grounds for the beginning of the new school year. Bring your cleaning supplies: buckets, cloths, soap, etc. See you there!



## Adventist Retirees of Michiana

TOMORROW • 1:00 PM  
WOLF PRAIRIE PARK

This is a reminder about the Corn Roast this Sunday. Bring a salad, entree, or dessert for 10-12 people. Results of the Mission Project will be announced and the new officers for 2015-16 will be presented. Questions? Call Mike or Shirley Gammon at 989.427.5669.

## Rotary Barbeque

AUGUST 13 • 4:00 TO 7:00 PM  
BERRIEN SPRINGS MIDDLE SCHOOL

Pick up your tickets at PMC or the ABC to help Pastor Rodlie and Pastor Esther sell their quota. Take-outs available. Menu includes: Sam's Vege Chicken, potato salad, vegetarian baked beans, dinner roll, cookies, and drink (for those who dine in). Proceeds help Rotary support community youth projects.

## PMC Job Opening

PMC is looking for a Facilities Coordinator and Administrative Assistant to Associate Pastor. This person will perform standard and confidential clerical duties requiring Christian discernment and interpersonal skills. This position is at the hub where the life and ministry of PMC converge in terms of organization, communication and management of facilities usage and services relative to the church's location within the community. A resume and cover letter should be mailed to:

Personnel Committee  
Pioneer Memorial Church  
8655 University Blvd.  
Berrien Springs, MI 49103

## Stuff the Bus Event

AUGUST 14 • 4:00 TO 8:00 PM  
FEATHER PARK

The *Backpacks for Berrien* group is collecting backpacks and school supplies for needy students attending Berrien Springs public schools and parochial schools. The bus will be parked at Feather Park next to the Oronoko Township Hall on Snow Road. If you are unable to bring school items, please give a donation by coming to Stuff the Bus or using donation jars located in local businesses. For more info contact Jane Thayer at [thayerja@andrews.edu](mailto:thayerja@andrews.edu).

## District 9 Family Camp

District 9 Family Camp at Camp Au Sable is just around the corner. Applications are available at the church office. **The deadline for submitting applications has been extended till Sunday, August 16.** We hope to see you at Family Camp for Labor Day Weekend, September 4-7! For questions, call Ric Streelman at 269.471.7172 or visit <https://districtnine.wix.com/home>.

## Barn Conference

AUGUST 21-22  
FULLER'S RESORT IN BUCHANAN

Join the Buchanan SDA Church at their third annual Barn Conference. The speaker, Mark Howard, will cover topics including: "Ellen White? Why Should I Care?," "How to Read Ellen White in the 21st Century," "Why I Believe in Ellen White," and "The Truth About the White Lie." Children's Sabbath School is available on Sabbath morning for ages 3-12 and Sabbath lunch will be provided for all. Seating is limited and on a first-come, first-served basis so reservations are required. To reserve your seat, call Gary Doty at 269.471.7328.

## PMC Pathfinders

The Evergreen Pathfinder Club is getting ready for a new year of friendships, experiences, honors, and learning about God! Keep an eye on the bulletin for more information, as we get closer to the end of summer and the start of a new Pathfinder year. Questions? E-mail Director Matt Johnson at [evergreenpathfinders@gmail.com](mailto:evergreenpathfinders@gmail.com).

## New Student Welcome Lunch

We need 100 families to extend a warm PMC welcome to our new University Students by providing them a meal after second service on August 22. Each family is asked to bring a complete meal of lasagna or a pasta dish (vegetarian or vegan), salad, and garlic bread to feed 10 to 12 people. Two or three friends could also band together and help provide this complete meal. Drink and dessert will be provided. To confirm that you will participate in this special hospitality ministry on August 22, please email [davis@pm-church.org](mailto:davis@pm-church.org) or call 471.3150.

## We Mourn

Today we mourn with the following families: Irene Fishell and her children on the death of their husband and father, Martin, on Monday, July 27. A funeral service was held Tuesday, August 4. We think today also of Don Dronen on the death of his sister, Margaret Wheeler. She died on Tuesday, August 3. The funeral was held Friday, August 7, in Fargo, North Dakota. With each of these families we look forward to the resurrection morning. "Even so, come Lord Jesus."

## 2015 BCYF Health & Wellness Exhibit

AUGUST 16-22

This year's health tent is fitness-focused. We need volunteers for the following positions:

**Blood-pressure Readings**—Be familiar with this process.

**Welcome—outside**—Be welcoming.

**Welcome—inside**—Direct people in the tent, and be able to answer questions.

**Massage—sign-in**—Register and announce names for appointments.

**Registration/waiver**—The participant fills out a registration form and a waiver before participating at a station.

**Data entry**—Be able to type and decipher hand-written registration forms.

**Set-up**—Help transport, assemble, and position all equipment used in the tent.

**Take-down**—Similar process to set-up.

**Host/hostesses**—Guide people in the tent and answer questions.

**Prayer Tree Team**—Take prayer requests and pray with participants if they want.

**Massage Therapists/Physical Therapists**—Provide a 10-minute basic upper back/neck massage.

**Personal Trainers, group fitness instructors, physical education teachers, or other related fields**—Be able to provide on-the-spot fitness advice to people of all demographics.

**Kids' station**—Kids' fitness exercise demonstration.

If you are interested in any of these positions please contact Ryan and Christine Wallace: [ryanandchristine@gmail.com](mailto:ryanandchristine@gmail.com) or 269.815.0557.

# WE STUDY

CONNECT • GROW • SERVE • GO

<b>Song Service</b>	Ed Higgins
<b>Opening Hymn</b>	<i>Bringing in the Sheaves</i> • 369
<b>Welcome</b>	Judy Wright
<b>Scripture &amp; Prayer</b>	Joel 3:13, 14 • Judy Wright
<b>Special Feature</b>	Mission Spotlight
<b>Offertory</b>	<i>Adagio</i> • Johann Georg Herzog
<b>Bible Study</b>	“Esther and Mordecai” • Classes
<b>Theme Song</b>	<i>Make Me a Blessing</i>

Make me a blessing; make me a blessing.  
Out of my life may Jesus shine.  
Make me a blessing; O Savior, I pray.  
Make me a blessing; to someone today.

“Make Me a Blessing,” Ira Bishop Wilson  
©1924, Renewed 1952 Word Music, LLC; Used by Permission. CCLI License #392652

<b>Benediction</b>	Ed Higgins
--------------------	------------

ORGANIST: Kenneth Logan

**See page 18/19 for Sabbath School directory & map**

| PASTORS | | STAFF |

**Chaplain / Pioneer**

José Bourget • 471.6254  
bourget@pmchurch.org

**Admin. Assistant**

Autumn Roberts  
autumn.m@pmchurch.org

**Discipleship / GROW Groups**

Sabine Vatel • 471.6153  
vatel@pmchurch.org

**Admin. Assistant**

Lailane Legoh • 471.3543  
legoh@pmchurch.org

**Harbor of Hope**

Taurus Montgomery • 269.923.9274  
montgomery@pmchurch.org

**Interim Media Director**

Jonathan LaPointe • 471.3678  
lapointe@pmchurch.org

**Lead Chaplain**

June Price • 471.6282  
madrigal@andrews.edu

**Assistant Treasurer**

JoAnn Siagian • 471.7656  
siagian@pmchurch.org

**Lead Pastor**

Dwight K. Nelson • 471.3134  
nelson@pmchurch.org

**Bible Work Coordinator**

Tabitha Umali • 269.340.2031  
tabitha.umali@pmchurch.org

**Pastoral Care**

Don Dronen • 471.3133  
dronen@pmchurch.org

**Clerk**

Jackie Bikichky • 471.3972  
bikichky@pmchurch.org

**Stewardship**

Sharon Terrell • 471.6151  
terrell@pmchurch.org

**Communications**

Rebecca Coleman  
rebecca.coleman@pmchurch.org

**This Generation Evangelism**

Rodlie Ortiz • 471.6154  
ortiz@pmchurch.org

**Executive Assistant**

Sherrie Davis • 471.3134  
davis@pmchurch.org

**Youth Ministries**

Ben Martin • 471.6176  
martin@pmchurch.org

**Graphic Designer**

Rachelle Offenback • 471.3647  
bulletin@pmchurch.org

**Media Ministries**

471.3246

**Maintenance**

Larry White • 471.3649  
white@pmchurch.org

**Music**

Kenneth Logan • 471.3231  
logan@pmchurch.org

| MINISTRIES | | SABBATH SCHOOL |

**Adventurers**

Daniel González • 423.432.0780  
adventurers@pmchurch.org

**Adult**

Judy Aitken • 240.7997  
adultss@pmchurch.org

**Deacons**

Milan Vajdic • 471.0328  
deacons@pmchurch.org

**Birth - Grade 1**

Claudia Davisson • 269.208.7081  
bg1@pmchurch.org

**Deaconesses**

Vida Giddings • 473.2175  
deconesses@pmchurch.org

**Grade 2 - Earliteen**

Robert Barnhurst • 473.1613  
g2teen@pmchurch.org

**Elders**

Russell & Cynthia Burrill • 473.3738  
elders@pmchurch.org

| OUR SCHOOLS |

**Andrews Academy**

Jeannie Leiterman • 471.3140  
leiterma@andrews.edu

**GROW Groups**

growgroups@pmchurch.org

**Andrews University**

471.7771 or 800.253.2874  
enroll@andrews.edu

**Health**

Evelyn Kissinger • 930.0505  
health@pmchurch.org

**Ruth Murdoch / K-8**

Evelyn Savory • 471.3225  
esavory@andrews.edu

**Pathfinders**

Matthew Johnson • 240.755.2661  
evergreenpathfinders@gmail.com

**Public Address**

Joel Kitchen  
audio@pmchurch.org



**PIONEER MEMORIAL CHURCH**

8655 UNIVERSITY BOULEVARD, BERRIEN SPRINGS, MI 49103

**OFFICE HOURS**

Monday – Thursday (8 to 5) • Friday (8 to 12)

**PHONE** – 269.471.3133

**FAX** – 269.471.6152

**LIVE STREAMING**

www.pmchurch.tv  
Sabbath 11:45 AM

**ONLINE**

www.pmchurch.org  
www.pmchurch.tv

**RADIO**

WAUS – 90.7 FM  
Sabbath 11:30 AM

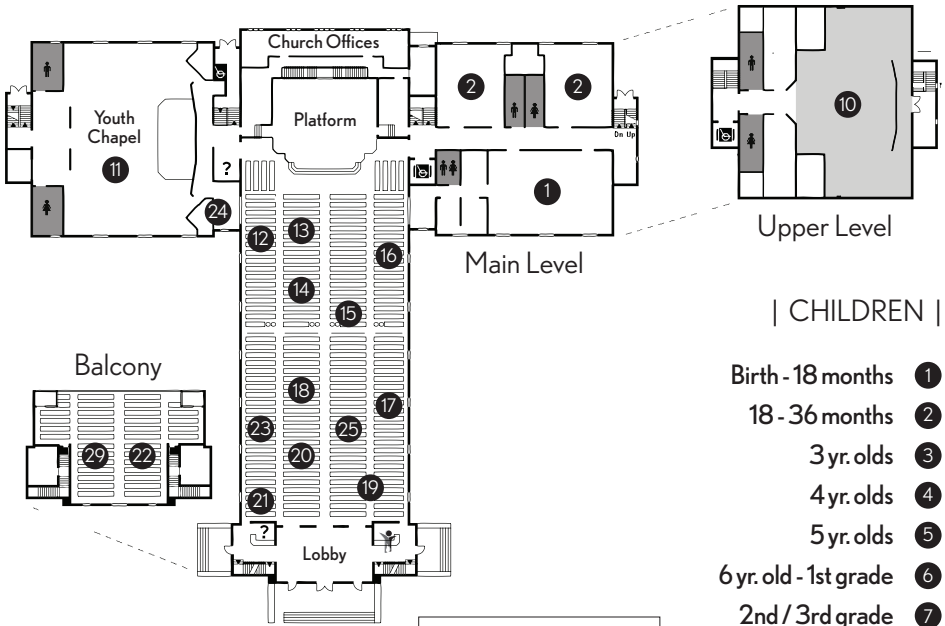

| CHILDREN |

- Birth - 18 months ①
- 18 - 36 months ②
- 3 yr. olds ③
- 4 yr. olds ④
- 5 yr. olds ⑤
- 6 yr. old - 1st grade ⑥
- 2nd / 3rd grade ⑦
- 4th grade ⑧
- 5th / 6th grade ⑨
- Earliteen ⑩
- Youth ⑪

| ADULT |

- ⑫ Group 1
- ⑬ Group 2 (Portuguese/Brazilian)
- ⑭ Group 3
- ⑮ Group 4 (Yugoslavian)
- ⑯ Group 5
- ⑰ Group 6
- ⑱ Group 7
- ⑲ Group 8
- ⑳ Group 9 (Spanish)
- ㉑ Group 10
- ㉒ Group 11 (Balcony)
- ㉓ Group 12 (French)
- ㉔ Conference Room
- ㉕ Indonesian Class
- ㉖ Something In Common
- ㉗ SDA Beliefs

| KEY |

- ? Welcome Centers
- ⬇ Elevators
- ♿ Restrooms
- 👤 Children's Activities & Lending Library

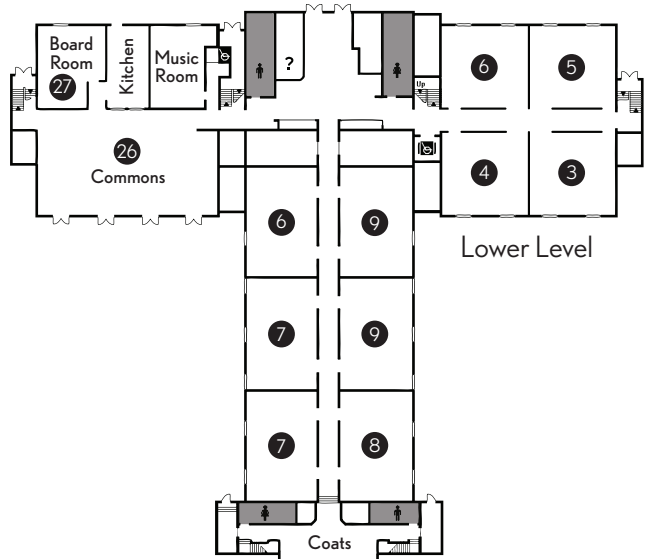

Lower Level

# Andrews University Campus Map

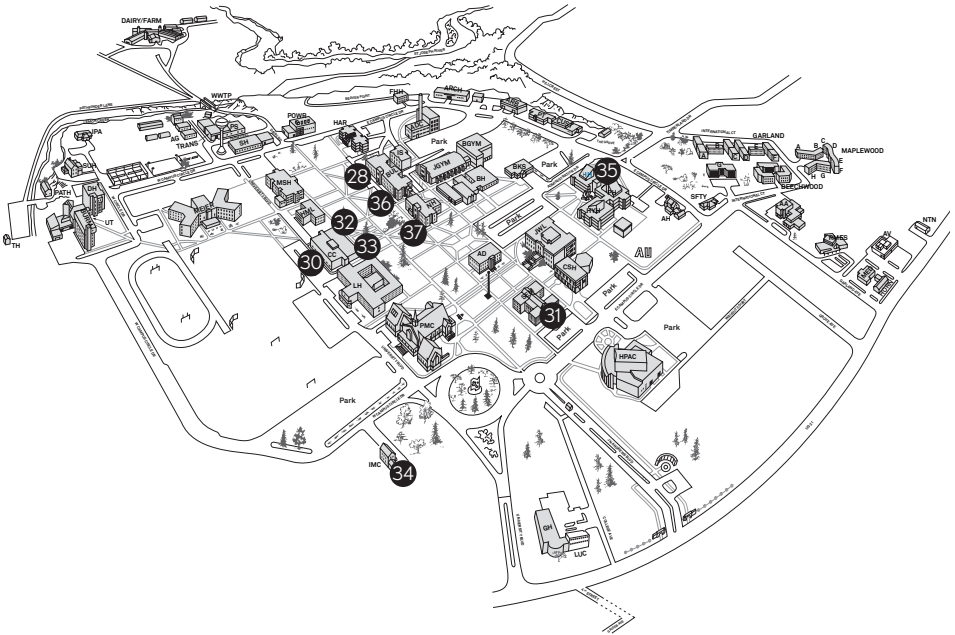

## | COLLEGIATE |

- 28 H&M (Hispanic - Religion Amphitheater)
- 29 People on the Move (PMC)
- 30 University Sabbath School (Dining Services)

## | ADULT @ AU |

## | SEMINARY |

- 31 N108 (Collegiate)
- N110
- N120 (New Life Church Choir)
- N150
- N211 (Small Group)
- N235
- N310 (Russian)
- N335 (Spanish)
- S340 (Upper Room)

- 32 Main Lounge
- 33 Faculty Lounge
- 34 Back to Basics
- 35 Living Word Fellowship
- 36 Current Events (Buller - 135)
- 37 Bible Journey (Nethery - 143)



# ARE YOU READY?

- Backpack
- Water Bottle
- Markers
- Calculator
- Registration at RMES

.....

If you haven't enrolled your student at RMES,  
would like to tour the campus, or just have questions,  
please feel free to contact us.



Ruth Murdoch Elementary School  
8885 Garland Ave., Berrien Springs, MI 49104  
269.471.3225 • [www.myRMES.org](http://www.myRMES.org)



**school begins  
AUGUST 24!**