

PIONEER CONNECT

JULY 18, 2015

ROAD TRIP:



A DAISY JUNGLE

Good morning PMC! It's so good to be back home and worshipping with you this beautiful Sabbath Day! For me, there is indeed no place like home.

While Richard and I were in Texas the past 15 days, there was an unexpected happening at our home. I am not sure why the daisies we planted along our picket fence, which were supposed to be no higher than 36 inches, grew to more than 50 inches. And now we have a virtual daisy jungle rising above and spreading through the fence and out onto the lawn (I have a suspicion it may have something to do with my husband's liberal application of fertilizer).

In today's worship message, Pastor Rodlie will be focusing on parenting. As

we listen to the message, depending on the age of our children, grandchildren, great-grandchildren, or, perhaps, nieces and nephews or just the children of our church family, we may all be thinking about different stages and roles of our "parenting" journeys. And, perhaps, we will be remembering some "daisy jungles"—unexpected happenings along the way. In spite of the curves in the road, in Psalm 127:3 & 5 we are reminded of the blessings that come with parenting, "Behold children are a heritage from the Lord. . . . Happy is the man [or woman] who has a quiver full of them!"

-Sharon Terrell

PMC ORGAN

Brenton Offenback gives an organ demonstration for one of the many tours on their way back home from the General Conference.

(Photo credit: Jonathan LaPointe)



FIND IT HERE

CONNECT • GROW • SERVE • GO



4

EDITORIAL
Filling the GAP

10

SABBATH SCHOOL
The Unlikely Missionary

15

FAMILY FINANCES

6

FEATURE ARTICLE
What We Perceive

11

PIONEER TWO
11:45 AM Worship

16

CONTACTS

8

PIONEER ONE
9:00 AM Worship

12

ANNOUNCEMENTS

18

**SABBATH SCHOOL
DIRECTORY**

14

**MEMBERSHIP
TRANSFERS**

FILLING THE GAP

BY CHUCK PECK

Twenty years before God's Abundant Pantry came into existence, Dr. Tricket, Business Professor at Andrews University, recognized that many International students and their families were struggling financially, some even suffering from hunger and malnutrition.

Dr. Tricket addressed this need by cultivating sources of food that could be distributed to those in need. He used his car to haul the food that he distributed daily from his trunk to waiting students gathered under a tree come rain, shine, or snow.

Over the years Dr. Tricket's ministry grew to the point that a borrowed van was needed to transport the food. The owner of the van, a local business man, eventually dedicated his van to this ministry, even paying the cost of insurance, licensing, maintenance and repairs.

Last year the business man retired and now it is also time to retire the 1996 van which has logged over 210,000 miles. Without a dependable van to transport food, God's Abundant Pantry cannot function.

Over these three-plus decades, PMC members have faithfully donated the funds needed to supply the supplemental food distributed to qualified International/graduate students every Tuesday and Thursday.



Today a special offering of \$15,000 is needed to purchase a dependable van. Two gifts of \$1,000 each have already been received plus several smaller donations from people who recognize and appreciate the role and value that God's Abundant Party plays in these students' lives.

Do you have a desire to see this ministry continue to help students while they com-



3. Login with your user details.
4. Enter the amount of your donation on the last line of "Local Church," where you can find "God's Abundant Pantry-Van."

STUDENT TESTIMONIALS:

"GAP has been a much appreciated help to our family of three. The ministry is a reminder of God's providence and security that is always faithful and can be relied on. Knowing that there are some foods we do not need to purchase helps us financially and is a great blessing that we look forward to each week."

"There have been many occasions when we have needed some specific food item but were without the funds with which to buy it. We did not know how we would be able to obtain the item. On several such occasions we have found the very item we needed at GAP at the very time when it was needed! We thank God for GAP!"

To watch a video about GAP and to read more student testimonials visit GAPantry.org. 100% of your donation will be used to purchase and maintain a dependable, used van needed by God's Abundant Pantry to fulfill its mission: "Serving students today who will serve humanity tomorrow." ■

plete their education, then go into all the world serving where God calls them?

Please make your donation today while this need is fresh in your mind. You may mark your tithe envelope "GAP Van Fund."

TO DONATE ONLINE:

1. Visit www.pmchurch.org.
2. Click on "Giving"

Chuck Peck is part of God's Abundant Pantry Ministry.



*What We
Perceive*

BY CARALIN MCHAN

Last Sabbath afternoon I went hiking with my cousin Lisa. As we plunged into the woods, I glanced in awe at the rays of light filtering through the trees. My sunglasses gave everything a yellow tint, highlighting leaves and sunshine. Enthralled, I stopped looking at where I was going until Lisa whispered, "Psst! Look!"

I turned and followed her pointing finger to the top of an oak tree. There, forty feet above the ground, three fluffy brownish fur balls precariously waddled down the tree trunk. 'Baby bears' was my first thought, since the fur balls confidently ventured into broad daylight. But no, these animals had bushy tails with black and white stripes, and black markings around their eyes. Baby raccoons!

The adolescent raccoons scrambled to keep steady footholds as they slowly descended the tree. But they weren't very good at climbing. They continuously bumped each other, crawled over each other, stopped, and changed directions. Lisa and I alternated between giggling at their antics and trying to capture their cuteness on camera.

After watching the baby raccoons for a while, we continued on our hike, and God's nature continued to surprise and delight us. We saw fossils of shells embedded in a rock, sparkling sunlight reflecting off the surface of the river, a cardinal singing his heart out, pudgy frogs smaller than your pinky fingernail hopping across the trail, a patch of brilliant orange mushrooms, two young buck deer munching tender grass, and vibrant butterflies and flowers.

Each time one of us happened upon one of these natural treasures, one of us would say, "Psst! Look!" Looking and seeing are pivotal to our lives. As Ralph Waldo Emerson said, "Never lose an opportunity of seeing anything beautiful, for beauty is God's handwriting."

Lisa and I would have had a much different experience if we had not noticed what was around us. We might have

thought we were the only living creatures in the woods if we had not seen the animals. We might have thought the forest was monochromatic if we had not seen the mushrooms and the flowers. We might have thought the

forest was young if we had not seen the enormous trees or the fossils. The way we perceived and interacted with the world was shaped by what we saw.

This same principle can be applied to other areas in our lives. We can serve others when we recognize their need. We can love others when we focus on how precious they are to Jesus. We can live in joyful gratitude when we are cognizant of God's blessings. What captures our attention captures our soul. For this reason, Paul wrote, "Let us throw off everything that hinders and the sin that so easily entangles. And let us run with perseverance the race marked out for us, fixing our eyes on Jesus, the pioneer and perfecter of faith" (Hebrews 12:1-2). ■

ENTHRALLED, I STOPPED LOOKING AT WHERE I WAS GOING UNTIL LISA WHISPERED, "PSST! LOOK!"

Caralin McHan is a Communications graduate student.

FAMILY WORSHIP

CONNECT • GROW • SERVE • GO

Opening Voluntary

Cantilena • Josef Rheinberger

Introit

The Gift of Love • Janet Linker

Call to Worship

Katenga Family

Look to God who makes all things new.

Let us set aside resentments. Let old divisions disappear.

We claim God and God's ways as our own.

We will live lovingly, as God's children.

Doxology

Praise God, From Whom All Blessings Flow • 2

Invocation

Rodlie Ortiz

Hymns of Praise and Devotion

Love Divine, All Loves Excelling • st. 1, 3-4 of 191

Jesus Loves Me • st. 1-3 of 190

Jesus Is All the World to Me • st. 1 & 3 of 185

Congregational Prayer

Cheryl Logan

Blest Be the Tie That Binds • st. 1 & 2 of 350

Worship in Music

May This Be the Place • Andrew Culverwell

Baby Dedication

Blake Owen presented by Bryan & Kristy Conklin
with Ronald Vozar

Children's Story

Jonathan Chitaya

Be Thou My Vision • Paul Manz

Scripture

Deuteronomy 6:4-9 NIV • Tapiwaso Chitaya

Hear, O Israel: The LORD our God, the LORD is one.

**Love the LORD your God with all your heart and with all your soul
and with all your strength. These commandments that I give you
today are to be upon your hearts.**

Impress them on your children. Talk about them when you sit at home and when you walk along the road, when you lie down and when you get up.

(continued on next page)

**Tie them as symbols on your hands and bind them on your foreheads.
Write them on the doorframes of your houses and on your gates.**

Hymn of Preparation

Be Thou My Vision • st. 1 & 3 of 547

Sermon

“Backpack (The Essential Gear for Godly Parenting)”
Rodlie Ortiz

Connect Cards, Tithes & Offerings

PMC Operating Expense

Hymn of Commitment

Lead Them, My God, to Thee • st. 1, 3 & 4 of 653

Benediction

Closing Voluntary

The King of Love My Shepherd Is • Sharon Rogers

PRESIDING PASTOR: Sharon Terrell; ORGANIST: Kenneth Logan

WORSHIP IN MUSIC: Girls of Mercy; Josephine Katenga, director

MUSIC ALIVE

FOR VISION

A hill stands in County Meath, Ireland, bearing the name "Slane." This hill is approximately ten miles from the site where the religious leader known as St. Patrick is believed to have challenged King Loegaire by lighting an Easter Eve fire. It is this hill that occasions the unusual hymn tune name SLANE found at hymn no. 547. This melody, in its whole and fragmentarily, was heard

repeatedly at the just-concluded General Conference Session, enjoining attendees to pursue God's vision. The text, originally in Irish, was translated into English at the turn of the twentieth century. It is typically Irish in its very wide vocal range. These words ally themselves with the thought of Proverbs 29:18: "Where there is no vision, the people perish." ■

WE STUDY

CONNECT • GROW • SERVE • GO

Song Service	Ben Shelley
Opening Hymn	<i>Marvelous Grace</i> • 109
Welcome	Tom Baker
Scripture & Prayer	1 Timothy 2:1-7 • Tom Baker
Special Feature	Mission Spotlight
Offertory	<i>He Is Exalted</i> • arr. Mark Hayes
Bible Study	"The Unlikely Missionary" • Classes
Theme Song	<i>Make Me a Blessing</i>

Make me a blessing; make me a blessing.
Out of my life may Jesus shine.
Make me a blessing; O Savior, I pray.
Make me a blessing; to someone today.

"Make Me a Blessing," Ira Bishop Wilson
©1924, Renewed 1952 Word Music, LLC; Used by Permission. CCLI License #392652

Benediction	Ben Shelley
--------------------	-------------

ORGANIST: Kenneth Logan
OFFERTORY: Isaac Munguia, piano

See page 18/19 for Sabbath School directory & map

WE PRAISE

CONNECT • GROW • SERVE • GO

As We Begin

Cantilena • Josef Rheinberger

Praise

Prayer

Baptism

Fatima J. Dorcelan with Sabine Vatel

Children's Story

Be Thou My Vision • Paul Manz

Worship in Music

May This Be the Place • Andrew Culverwell

Sermon

“Backpack (The Essential Gear for Godly Parenting)” • Rodlie Ortiz

Connect Cards, Tithes & Offerings

Closing Song

As We Depart

The King of Love My Shepherd Is • Sharon Rogers

WORSHIP DIRECTOR: José Bourget; ORGANIST: Kenneth Logan

WORSHIP IN MUSIC: Girls of Mercy; Josephine Katenga, director

PIONEER PEOPLE**SUNSET TODAY** • 9:19
SUNSET NEXT FRIDAY • 9:13

SUBMIT announcements by emailing bulletin@pmchurch.tv or by going to www.pmchurch.org and click on “submit a bulletin announcement.” Requests must be received **Monday by 5:00 PM** for consideration.

WEEK AT A GLANCE

| SATURDAY |

FAMILY VESPERS

8:00 PM • PMC YOUTH CHAPEL

PIONEER PULPIT

| 07 • 25 |

SABINE VATEL

"Road Trip: #GodsFamilyPicture"

| 08 • 01 |

CLIFFORD JONES

1st service—Don Dronen

2nd service—AU Baccalaureate

Family VespersTODAY • 8:00 PM
PMC YOUTH CHAPEL

You are welcome to close the Sabbath with us in the study of God's Word.

FLAG Camp Drivers Needed

If you have some extra time on your hands and are looking for a ministry this summer we are in need of volunteer drivers for field trips here at camp. If you are a 21-year-old licensed driver and are willing to drive a mini-bus this summer we'd be so grateful if you would give us a call! Please contact Vanna Giddings at 269.277.9123.

#GodsFamilyPicture

What's your ideal picture of God's Family? How do you see it expressed at PMC, in your home, school or work? As we come to the end of our Road Trip Sermon series, take a snapshot of it and share your picture via Twitter or PMC's Facebook Page with the caption #GodsFamilyPicture (remember to use the hashtag sign #). If you have questions you'd like to ask the pastoral staff about any of the themes addressed in the Road Trip sermons, write them on your Connect Card or fill out a Connect Card online at www.pmchurch.org. There will also be opportunity to ask them live via social media on July 25.

Garden Donations Welcome

During the time the Karen people are here to celebrate the 100th anniversary of Eric B. Hare's arrival in Burma, volunteers will be serving them meals. If God has blessed your garden with abundance, and you would like to give some of it to the cooks, the following are some suggestions for items: cucumbers, lettuces, greens, tomatoes and squash. Please bring your donations to the ASAP Center in town: 105 S. Cass, Berrien Springs, Monday, July 13 through July 24. There will be marked coolers outside in which to place your produce; M-Th 9 AM-4 PM; 9-12 on Friday. Thank you!

6-day Natural Remedies & Hydrotherapy Workshop

AUGUST 2-7

ANDREWS UNIVERSITY

For details visit www.andrews.edu/go/nrhw, email fran@andrews.edu, or call 269.471.3541.

Rowboat Wanted

The Primary 2 Sabbath School room is wanting to borrow a small rowboat. Please contact Cheryl Logan at cjhlogan@gmail.com for more information.

District 9 Family Camp

District 9 Family Camp at Camp Au Sable is just around the corner. Application materials are available from the church office. The deadline is Sunday, August 9. We hope to see you at Family Camp for Labor Day Weekend, September 4-7! For questions, call Ric Streelman at 269.471.7172 or visit <https://districtnine.wix.com/home>.

The Kids Library Needs You!

Volunteers are needed at the Kids Library counter, no later than 11:30 on Sabbath morning to begin checking out quiet activities to families, and to remain at the counter until after the service to check bags back in. If you would like to help, or have questions, please email the Kids Library at pmckidslibrary@gmail.com or call Debbie at 503.580.8003 or Rachelle at 269.930.3972.

PMC Job Opening

PMC is looking for a Facilities Coordinator and Administrative Assistant to Associate Pastor. This person will perform standard and confidential clerical duties requiring Christian discernment and interpersonal skills. This position is at the hub where the life and ministry of PMC converges in terms of organization, communication and management of facilities usage and services relative to the church's location within the community. A resume and cover letter should be mailed to:

Personnel Committee
Pioneer Memorial Church
8655 University Blvd.
Berrien Springs, MI 49103

Fall GROW Group Leaders

Starting July 27, sign up your GROW Group via www.pmchurch.org/grow-group. Have an idea for a group you'd like to lead between September 27 and December 13? "How to Give a Bible Study," "Parenting," "Study on the Beatitudes," or "Learn Golf" are just a few of the suggestions received. Help us build a community where members and visitors grow through meaningful connections with each other and with God. For questions email growgroups@pmchurch.org.

| TRANSFERS IN |

AITKEN, Jay
 AITKEN, Jill
 AVILA, Carmen
 BARBALHO, Therezinha
 BRADFIELD, Craig
 BRADFIELD, Erica
 EVANS, Kathleen
 IZUMI, Yuri
 KESHIPOCO, Olivio F.
 KIM, Hongon
 KIM, Jion
 KIM, Sion
 LEE, Sunam
 LEITE, Rafaella
 LEITE, Zeli (de Oliveira)
 MATACIO, Lauren
 MBWAMBO, Julius

METELLUS, Marc Henry
 RIVAS, Juan
 RIVAS, Samuel
 WAHLEN, Michael

| FROM |

Bellingham, WA
 Bellingham, WA
 Cagua, Venezuela
 Brazilian Comm • Richmond, VA
 Collegedale Comm • Ooltewah, TN
 Collegedale Comm • Ooltewah, TN
 Blue Mt. Valley-Mission • Athena, OR
 Spanish • Chico, CA
 Kuil River • Sarepta, S Africa
 Yuseong • Daejeon, Korea
 Yuseong • Daejeon, Korea
 Yuseong • Daejeon, Korea
 Domadong • Daejeon Metro, Korea
 Brazilian Comm • Richmond, VA
 Brazilian Comm • Richmond, VA
 Village • Berrien Springs, MI
 Tanzania Advent Secondary School
 Arusha, Tanzania
 Mahanaim French • Naples, FL
 Guanare Central • Venezuela
 Puertos de Altigracia • Zulia, Venezuela
 Willowbrook • Boonsboro, MD

| TRANSFERS OUT |

CHUAH, Matthew
 CLARK, Elinor
 CLARK, Jason
 HIATT, Pauline
 HYDE, Aileen
 JACKSON, Ethlyn
 ROWLAND, Bonnie
 ROWLAND, Clark
 SARNO, Amber
 STRZYKOWSKI, Carolyn
 STRZYKOWSKI, Stan
 TCHAMBA, Christian
 URAKPAYEV, Askar
 URAKPAYEV, Liliya
 WILLUMSON, Julie
 WOODS, Delores

| TO |

Mich Fil-Am • Berrien Springs, MI
 Village • Berrien Springs, MI
 Village • Berrien Springs, MI
 Westside • Niles, MI
 Tabernacle • Battle Creek, MI
 Pearl River, NY
 Carmichael • Sacramento, CA
 Carmichael • Sacramento, CA
 Valley View • Bluefield, WV
 Village • Berrien Springs, MI
 Village • Berrien Springs, MI
 University • Loma Linda, CA
 Fairplain • Benton Harbor, MI
 Fairplain • Benton Harbor, MI
 Collegedale Comm • Ooltewah, TN
 Redlands, CA

pioneer memorial church
FAMILY FINANCES

As of June 30, 2015

Includes June online giving

MASTER PLAN OF EVANGELISM



LINE 5 IN YOUR TITHE ENVELOPE

GOAL TO-DATE	69,888
RECEIVED TO-DATE	44,877
RECEIVED TO-DATE 2014	54,065

OPERATING FUND

LINE 2 IN YOUR TITHE ENVELOPE

GOAL TO-DATE	305,006
RECEIVED TO-DATE	278,661
RECEIVED TO-DATE 2014	281,053

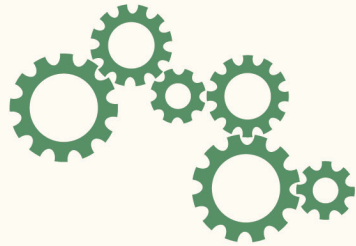

CHRISTIAN EDUCATION



LINE 3 IN YOUR TITHE ENVELOPE

GOAL TO-DATE	105,846
RECEIVED TO-DATE	95,838
RECEIVED TO-DATE 2014	90,839

| PASTORS | | STAFF |

Chaplain / Pioneer

José Bourget • 471.6254
bourget@pmchurch.org

Admin. Assistant

Autumn Roberts
autumn.m@pmchurch.org

Discipleship / GROW Groups

Sabine Vatel • 471.6153
vatel@pmchurch.org

Admin. Assistant

Lailane Legoh • 471.3543
legoh@pmchurch.org

Harbor of Hope

Taurus Montgomery • 269.923.9274
montgomery@pmchurch.org

Interim Media Director

Jonathan LaPointe • 471.3678
lapointe@pmchurch.org

Lead Chaplain

June Price • 471.6282
madrigal@andrews.edu

Assistant Treasurer

JoAnn Siagian • 471.7656
siagian@pmchurch.org

Lead Pastor

Dwight K. Nelson • 471.3134
nelson@pmchurch.org

Bible Work Coordinator

Tabitha Umali • 269.340.2031
tabitha.umali@pmchurch.org

Pastoral Care

Don Dronen • 471.3133
dronen@pmchurch.org

Clerk

Jackie Bikichky • 471.3972
bikichky@pmchurch.org

Stewardship

Sharon Terrell • 471.6151
terrell@pmchurch.org

Communications

Rebecca Coleman
rebecca.coleman@pmchurch.org

This Generation Evangelism

Rodlie Ortiz • 471.6154
ortiz@pmchurch.org

Executive Assistant

Sherrie Davis • 471.3134
davis@pmchurch.org

Youth Ministries

Ben Martin • 471.6176
martin@pmchurch.org

Graphic Designer

Rachelle Offenback • 471.3647
bulletin@pmchurch.org

Media Ministries

471.3246

Maintenance

Larry White • 471.3649
white@pmchurch.org

Music

Kenneth Logan • 471.3231
logan@pmchurch.org

| MINISTRIES | | SABBATH SCHOOL |

Adventurers

Daniel González • 423.432.0780
adventurers@pmchurch.org

Adult

Judy Aitken • 240.7997
adultss@pmchurch.org

Deacons

Milan Vajdic • 471.0328
deacons@pmchurch.org

Birth - Grade 1

Claudia Davisson • 269.208.7081
bg1@pmchurch.org

Deaconesses

Vida Giddings • 473.2175
deconesses@pmchurch.org

Grade 2 - Earliteen

Robert Barnhurst • 473.1613
g2teen@pmchurch.org

Elders

Russell & Cynthia Burrill • 473.3738
elders@pmchurch.org

| OUR SCHOOLS |

Andrews Academy

Jeannie Leiterman • 471.3140
leiterma@andrews.edu

GROW Groups

growgroups@pmchurch.org

Andrews University

471.7771 or 800.253.2874
enroll@andrews.edu

Health

Evelyn Kissinger • 930.0505
health@pmchurch.org

Ruth Murdoch / K-8

Evelyn Savory • 471.3225
esavory@andrews.edu

Pathfinders

Matthew Johnson • 240.755.2661
evergreenpathfinders@gmail.com

Public Address

Joel Kitchen
audio@pmchurch.org



PIONEER MEMORIAL CHURCH

8655 UNIVERSITY BOULEVARD, BERRIEN SPRINGS, MI 49103

OFFICE HOURS

Monday – Thursday (8 to 5) • Friday (8 to 12)

PHONE – 269.471.3133

FAX – 269.471.6152

LIVE STREAMING

www.pmchurch.tv
Sabbath 11:45 AM

ONLINE

www.pmchurch.org
www.pmchurch.tv

RADIO

WAUS – 90.7 FM
Sabbath 11:30 AM

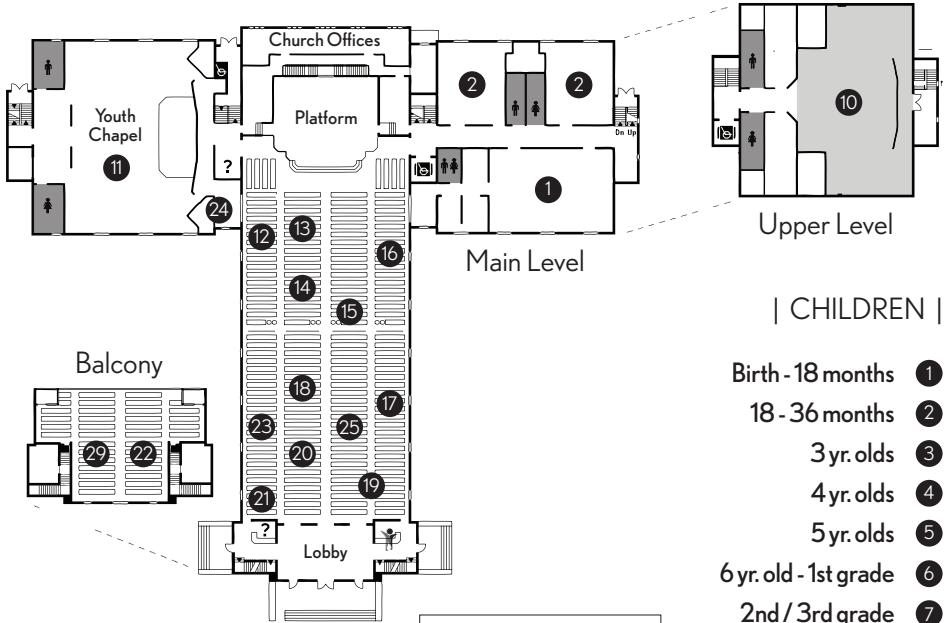

| CHILDREN |

- Birth - 18 months ①
- 18 - 36 months ②
- 3 yr. olds ③
- 4 yr. olds ④
- 5 yr. olds ⑤
- 6 yr. old - 1st grade ⑥
- 2nd / 3rd grade ⑦
- 4th grade ⑧
- 5th / 6th grade ⑨
- Earliteen ⑩
- Youth ⑪

| ADULT |

- ⑫ Group 1
- ⑬ Group 2 (Portuguese/Brazilian)
- ⑭ Group 3
- ⑮ Group 4 (Yugoslavian)
- ⑯ Group 5
- ⑰ Group 6
- ⑱ Group 7
- ⑲ Group 8
- ⑳ Group 9 (Spanish)
- ㉑ Group 10
- ㉒ Group 11 (Balcony)
- ㉓ Group 12 (French)
- ㉔ Conference Room
- ㉕ Indonesian Class
- ㉖ Something In Common
- ㉗ SDA Beliefs

| KEY |

- ? Welcome Centers
- ⬇ Elevators
- ♿ Restrooms
- 👤 Children's Activities & Lending Library

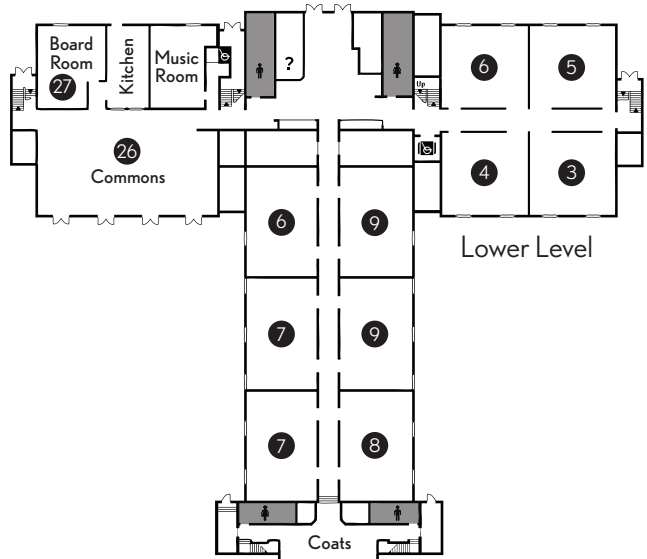

Lower Level

Andrews University Campus Map

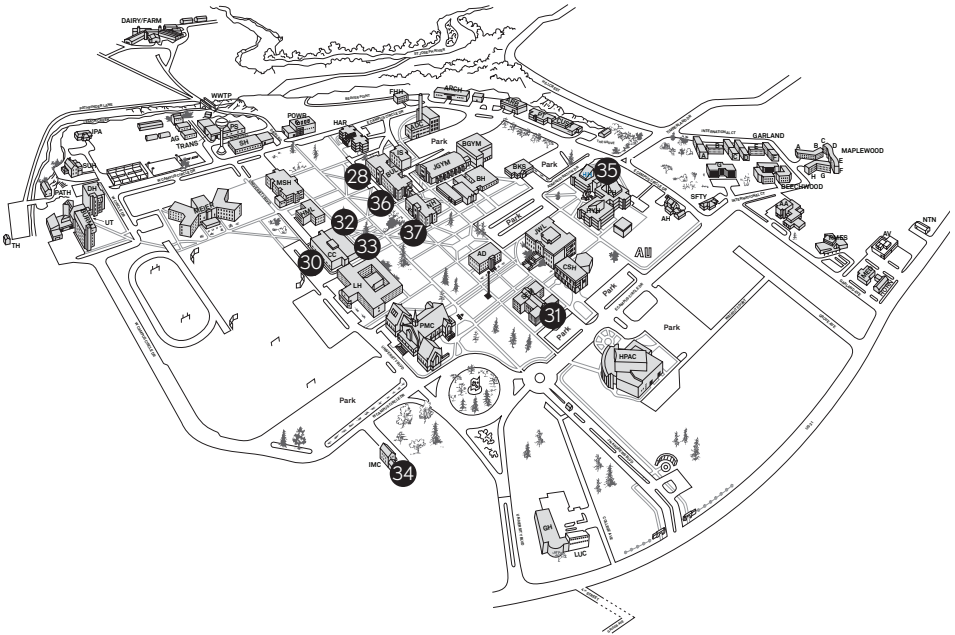

| COLLEGIATE |

- 28 H&M (Hispanic - Religion Amphitheater)
- 29 People on the Move (PMC)
- 30 University Sabbath School (Dining Services)

| ADULT @ AU |

| SEMINARY |

- 31 N108 (Collegiate)
- N110
- N120 (New Life Church Choir)
- N150
- N211 (Small Group)
- N235
- N310 (Russian)
- N335 (Spanish)
- S340 (Upper Room)

- 32 Main Lounge
- 33 Faculty Lounge
- 34 Back to Basics
- 35 Living Word Fellowship
- 36 Current Events (Buller - 135)
- 37 Bible Journey (Nethery - 143)



ARE YOU READY?

- ✓ Backpack
- ✓ Water Bottle
- ✓ Markers
- ✓ Calculator
- ✓ Registration at RMES

.....

If you haven't enrolled your student at RMES, would like to tour the campus, or just have questions, please feel free to contact us.



Ruth Murdoch Elementary School
8885 Garland Ave., Berrien Springs, MI 49104
269.471.3225 • www.myRMES.org



**school begins
AUGUST 24!**