

**PIONEER**

---

# CONNECT

NOVEMBER 8, 2014



## HEAVEN IS GLAD

Hi! We are glad you are here. I am compelled to tell you about babyhood. I promise I won't say anything for a while . . . but indulge me for one more illustration. I have learned . . . now as a seasoned 9-month father, that Cana, my daughter, is a diaper wearer. She has three kinds of diapers: blowouts (in the back), can't-see-them-but-can-smell-them, and those that are not either one of those but are still in need of changing (if you know what I mean). I have learned in grown-up

life, we all wear one of those diapers. Some of us have stuff that we can hide behind us and from the front you can't tell. Some of us have stuff that everyone can smell. Others, still, have stuff but you can't smell and you can't see it . . . even from the back. Here's the point. We all have diapers that need changing. So as we worship, the ground is level at the foot of the cross. I pray we all experience **change** today. Welcome.

—Micheal Goetz

---

### NOVEMBER GO: PROJECT

*Andrews University students helping to rake leaves in the community  
(Photo taken by Rodlie Ortiz).*



# FIND IT HERE

CONNECT • GROW • SERVE • GO



---

**4**

**THE FOURTH  
WATCH BLOG**

The Truth About  
Granddaughters & God

---



---

**10**

**PIONEER ONE**  
9:00 AM Worship

---



---

**18**

**MEMBERSHIP  
TRANSFERS**

---



---

**6**

**FEATURE ARTICLE**  
Me? A Spiritual Mentor?

---



---

**12**

**SABBATH SCHOOL**  
Faith That Works

---



---

**19**

**MPE ARTICLE**  
Soup Kitchen: A Testimony

---



---

**8**

**FINANCIAL  
SPOTLIGHT**  
What Is Life?

---



---

**13**

**PIONEER TWO**  
11:45 AM Worship

---



---

**20**

**CONTACTS**

---



---

**14**

**ANNOUNCEMENTS**

---



---

**22**

**SABBATH SCHOOL  
DIRECTORY**

---



# THE TRUTH ABOUT GRANDDAUGHTERS & GOD

BY DWIGHT K. NELSON

I don't mind admitting that putting our little just-turned-one granddaughter Ella on a plane this past Sunday wasn't just about tears, but also about an ache in the heart that I really hadn't expected. After all, Karen and I knew this day would be coming sometime. Hav-

ing our son Kirk and Chelsea just three miles up the road from us these past few years has been a parents' delightful bonus. But when Ella was born a year ago, we were joyfully ushered into the glorious dimension of grandparenthood. And what's not to like about having a

precious little red-head granddaughter at your home nearly every week, while before your wondering eyes she grows and blossoms! To smother with love and kisses and prayers—isn't that why God invented grandparents?

So a few weeks ago, when Kirk accepted the invitation to head up physician recruiting at the 450 bed Salem Hospital (Oregon), the countdown to the inevitable began. But hey, isn't this what happens to everybody? I mean—life goes on—families can't stay close by forever—so not to worry—there's always Skype. If I had even subconsciously entertained the slightest notion of such thinking, trust me—it all vanished when it came time to say Good-bye Sunday afternoon at O'Hare.

When we pulled back into our driveway that evening and climbed the stairs to the living room, Ella's blanket was still on the floor, covered with her kaleidoscope of toys that were her favorites when she came to visit Papa and Grammie, and her empty high chair nearby—all of it corroborating evidence that the tears and the ache had not been imagined.

---

## WHEN OUR HEARTS ACHE, IT IS CORROBORATING EVIDENCE THAT THE HEART THAT CALLED US INTO EXISTENCE DOES, TOO.

---

So where does it come from, this subterranean welling up of such poignant and too many times painful emotion when we're separated from those we love? If only we didn't become so attached to one another, there wouldn't have to be tears and an ache inside, would there? **"I grieve for you, Jonathan my brother; you were very dear to me" (2 Samuel 1:26).**

The truth is, such deep emotion is both transgenerational and transcultural. It is the human birthright, the embedded DNA of the divine Creator Himself. God is a Being questing for friends, in the words of Clark Rowland. Being fashioned in His image means that our own kaleidoscope of emotions can be traced back (or up) to the Eternal heart. The two-word brush-stroke on the canvass of Lazarus' death and resurrection still tells the truth about God: **"Jesus wept" (John 11:35).** Not only over the separation of death. But over the separation of rejection, loneliness, unrequited love and distance.

When our hearts ache, it is corroborating evidence that the Heart that called us into existence does, too. **"In all our affliction, He is afflicted" (Isaiah 63:9).** And because He is, the very presence of relational pain is itself the union of the divine with the human.

Tears and heartache—no matter their cause—flow from the sacred capacity to love so deeply it can actually hurt. Just like grandparents. Just like God. ■

You can follow Pastor Dwight's blog at  
[www.pmchurch.tv/blog](http://www.pmchurch.tv/blog).

# ME? A SPIRITUAL MENTOR?

BY ANDREA JAKOBSONS

**P**aul is writing to his protégé Timothy. Paul, the spiritual mentor, is taking the time to leave Timothy, a young man, with instructions on how to fulfill the call that God has given him. My Evangelism and Leadership Class and I have been studying the two letters to Timothy for the past couple weeks. Thinking about the guidance that Paul offered Timothy, I can't help but look back at my own experiences with spiritual leaders. Although there were many people who influenced my walk with God, there is only one person I can think of who has ever written me a letter in order to encourage me in ministry and to offer guidance: my dad. I specifically remember the time when I was going on my first "solo" speaking engagement in Poland and my surprise when I opened up my Bible and in it was a hand-written letter from my dad. The letter encouraged me throughout the two-week experience to speak boldly for Christ and to trust God. I think of my dad as the greatest spiritual mentor I've ever had. But when I look at my life, the mentorship I have received from my dad and the mentorship I see in the letters of Paul, I can't help but wonder whether I have neglected "writing letters" to the youth? In fact, have we as an Adventist community neglected choosing protégés and "writing letters"? Sometimes I forget that I am not

a youth anymore and that it is now my turn to mentor someone else. Perhaps it is because I hold the pedestal high and see Paul as someone much higher than I am, that I don't feel worthy of offering guidance to anyone else. So, what can I learn from Paul? What spiritual mentorship lessons are found in the letters to the young man Timothy?

**Paul institutes a father-son relationship.** Paul calls Timothy "son" (1 Timothy 1:2, 18) and treats him as family. He makes Timothy feel special because he loves him.

**Paul encourages.** He points out that Timothy demonstrates "genuine faith" (2 Timothy 1:5) and calls him a "man of God" (1 Timothy 6:11). It is obvious throughout the letter that Paul is proud of this young man and is not afraid to let him know that.

**Paul instills confidence.** He reiterates to Timothy that he has been given a gift and it should not be neglected (1 Timothy 4:14). Paul believed that Timothy was capable of being a leader despite his young age.

**Paul challenges.** He entreats Timothy to be an example in behavior and godliness (1 Timothy 4:12) and to give himself completely to the ministry and the Word of God (1 Timothy 4:15-16).



**Paul gives practical advice.** He instructs him how to handle different situations that may arise in the church by giving Timothy the right tools to use in order to know how to treat others and to solve problems (1 Timothy 2-5).

The points seem simple enough and yet just because something is simple doesn't mean they are put into action. I would like to challenge myself and you as well because if you are reading this you are probably old enough to be a mentor to someone else—to “write a letter” to a young person in your life through the following actions (hint: establish #1 before going to the other 4):

#### **① THINK OF THEM AS FAMILY**

Think of them as your son or daughter who you want to blossom into a powerful leader for Christ. Treat them as someone special to you.

#### **② ENCOURAGE**

“I am so proud of you!” “You are so great at...” “These are the qualities I admire in you...”

#### **③ INSTILL CONFIDENCE**

Demonstrate that you believe in them and reiterate that they have been given gifts from God to do His work.

#### **④ CHALLENGE**

Don't be afraid to encourage them to live godly lives and to spend time in His Word. Ask, “How are you doing with God?”

#### **⑤ GIVE PRACTICAL ADVICE**

Tell them how to handle situations and life from the Word of God. ■

*Andrea Jakobsons is the Religion Instructor at Andrews Academy.*

# WHAT IS LIFE?

*“A man’s life does not consist in the abundance of his possessions” (Luke 12:15).*

BY SHARON TERRELL

**T**here’s a book in my library that provides some really good counsel about life. Written by Rick Rusaw and Eric Swanson, *Living a Life on Loan: Finding Grace at the Intersections* makes you think, and brings stewardship to a new level: my life is not mine; it’s God’s life on loan to me.

Have you thought of your life as on loan rather than as a life you own? I just celebrated another birthday; they seem to be coming more quickly these days! Another birthday brings a good opportunity to think about your life—or rather God’s life on loan to you. Rusaw and Swanson remind us that, “If you own something, you are free to give it away, sell it, or exchange it with whomever you choose. But if your life belongs to someone else and is on loan to you, that changes everything. Before you give your life (or even portions of it) away, you have to check with the Owner first.”

The Bible puts it this way, “The earth is the Lord’s, and everything in it, the world, and all who live in it” (Psalm 24:1). We belong to God. The life we live comes from

Him alone. Paul reminds us, “You are not your own; you were bought at a price” (1 Corinthians 6:19, 20).

All of us have resources that come to us in the form of a loan from God. Whether we begin with more or less, we have some amount of “fortune” and can invest our fortune to accomplish God’s purposes both in our lives and in the lives of others. God can accomplish much with people who may have only meager resources but who have big hearts. The poor widow who gave her two small copper coins is commended for what she did with her “fortune”—loaned to her by God (Luke 21:1-4).

May God bless you as you check with the Owner of your life for His guidance in using your talents, your resources, your opportunities—all from God—to extend His grace to others.

(Rick Rusaw and Eric Swanson, *Living a Life on Loan; Finding Grace at the Intersections*; Cincinnati: Standard Publishing, 2006, page 12-13). ■

**IF YOU OWN SOMETHING, YOU ARE FREE TO GIVE IT AWAY, SELL IT, OR EXCHANGE IT WITH WHOMEVER YOU CHOOSE. BUT IF YOUR LIFE BELONGS TO SOMEONE ELSE AND IS ON LOAN TO YOU, THAT CHANGES EVERYTHING.**



pioneer memorial church  
**FAMILY FINANCES**

As of October 31, 2014

Includes October online giving

MASTER PLAN OF EVANGELISM



LINE 5 IN YOUR TITHE ENVELOPE

GOAL TO-DATE	105,006
RECEIVED TO-DATE	87,150
RECEIVED TO-DATE 2013	84,262

OPERATING FUND

LINE 2 IN YOUR TITHE ENVELOPE

GOAL TO-DATE	504,433
RECEIVED TO-DATE	452,394
RECEIVED TO-DATE 2013	473,626

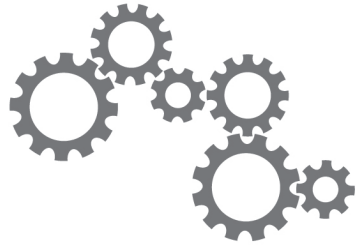

CHRISTIAN EDUCATION



LINE 3 IN YOUR TITHE ENVELOPE

GOAL TO-DATE	184,341
RECEIVED TO-DATE	153,715
RECEIVED TO-DATE 2013	164,258

# WE WORSHIP

CONNECT • GROW • SERVE • GO

**Opening Voluntary** *The Coming King Is at the Door • Charles Hall*

**Introit** *Turn Your Eyes Upon Jesus • Helen Lemmel*

**Call to Worship** Micheal Goetz

As one hundred or two hundred.  
**We gather to forgive as God forgives,**  
To love as God loves.  
**We covenant together to be the church**

**Doxology** *Praise God, From Whom All Blessings Flow • 2*

**Invocation** Dwight K. Nelson

**Hymn of Praise** *God of Our Fathers • 645*

**Congregational Prayer** Micheal Goetz  
*As We Come to You in Prayer • 671*

**Worship in Music** *Charity Unfailing • Kenneth Logan*

**Farewell to Micheal, Melanie and Cana Goetz**

**Children's Story** *Holy, Holy, Holy • David Winkler*

**Scripture** 1 John 1:6-9 NKJV • Russell & Trevor Furst

If we say that we have fellowship with Him, and walk in darkness,  
we lie and do not practice the truth.

**But if we walk in the light as He is in the light,  
we have fellowship with one another, and the blood  
of Jesus Christ His Son cleanses us from all sin.**

If we say that we have no sin, we deceive ourselves,  
and the truth is not in us.

**If we confess our sins, He is faithful and just to forgive  
us our sins and to cleanse us from all unrighteousness.**

**Hymn of Preparation**

*Whiter Than Snow* • st. 1 of 318

**Sermon**

“Galaxy Three: Galaxy 3’s Third Cleansing” • Dwight K. Nelson

**Connect Cards, Tithes, & Offerings**

World Budget / Annual Sacrifice

**Hymn of Commitment**

*There Is a Fountain* • st. 1-3 of 336

**Benediction**

**Closing Voluntary**

*Choral Song* • Samuel Sebastian Wesley

PRESIDING PASTOR: Micheal Goetz; ORGANIST: Kenneth Logan  
WORSHIP IN MUSIC: Andrews University Symphony Orchestra; Claudio González, director  
Jonathan Sharley, undergraduate student director

---

# MUSIC ALIVE

## CHARITY UNFAILING

**T**oday’s Worship in Music explores “charity,” using the term in the context of the rendering in the *KJV* in First Corinthians 13. This is the middle one of three movements of a prospective Church Concerto for organ and orchestra, the others to be on Faith and Hope respectively. “Charity Unfailing” seeks to express something of the beauty, breadth, and dependability of God’s love. The music is at times lyrical, passionate, or serene.

The first melody returns in the passionate middle section as a primary basis for elaboration in the upper strings, then returns again in abbreviated form starting with the flute solo that begins the final section. Elsewhere in worship, today’s opening voluntary, composed by Charles “C. J.” Hall, is a fantasia on a nineteenth-century hymn by Franklin Belden. Dr. Hall was a faculty member in the AU Music Department from 1970-1991. ■

# WE STUDY

CONNECT • GROW • SERVE • GO

**Song Service**

Ben Shelley

**Welcome & Prayer**

Mordekai Ongo

**Special Feature**

People Centered • Mission Spotlight

**Offertory**

*Adonai • Stephanie Lewis, Lorraine Ferro & Don Koch*

**Bible Study**

“Faith That Works” • Classes

**Theme Song**

*Make Me a Blessing*

Make me a blessing; make me a blessing.  
Out of my life may Jesus shine.  
Make me a blessing; O Savior, I pray.  
Make me a blessing; to someone today.

“Make Me a Blessing,” Ira Bishop Wilson

©1924, Renewed 1952 Word Music, LLC; Used by Permission. CCLI License #392652

**Benediction**

Ben Shelley

ORGANIST: Kenneth Logan

OFFERTORY: Cristy Doria, soprano; Edgar Perez, piano

**See page 18/19 for Sabbath School directory & map**

# WE PRAISE

CONNECT • GROW • SERVE • GO

## As We Begin

*The Coming King Is at the Door • Charles Hall*

## Hello

## Celebrate & Praise

Lonnie A. Kittleson *with Don Dronen*  
Nathan Michael Edison Drysdale, Noah Raleak Drysdale  
*with Micheal Goetz*

## Prayer

Micheal Goetz

## Farewell to Micheal, Melanie and Cana Goetz

## Children's Story

*Holy, Holy, Holy • David Winkler*

## Worship in Music

*Charity Unfailing • Kenneth Logan*

## Sermon

"Galaxy Three: Galaxy 3's Third Cleansing" • Dwight K. Nelson

## Connect Card, Tithes, & Offerings

## Closing Hymn

*There Is a Fountain • st. 1-3 of 336*

## As We Depart

*Fest-Hymn: Now Thank We All Our God • Carl Piutti*

WORSHIP DIRECTOR: José Bourget; ORGANIST: Kenneth Logan  
PLATFORM MANAGER: Debbie Weithers; MUSIC DIRECTOR/PIANO: Ilana Cady  
VOCAL DIRECTOR: Jonathan Dominique  
WORSHIP IN MUSIC: Andrews University Symphony Orchestra; Claudio González, director  
Jonathan Sharley, undergraduate student director

**PIONEER PEOPLE****SUNSET TODAY** • 5:33  
**SUNSET NEXT FRIDAY** • 5:26

**SUBMIT** announcements by emailing [bulletin@pmchurch.tv](mailto:bulletin@pmchurch.tv) or by going to [www.pmchurch.org](http://www.pmchurch.org) and click on “submit a bulletin announcement.” Requests must be received Monday by 5 PM for consideration.

**WEEK AT A GLANCE**

| SATURDAY |

**GOETZ FAREWELL POTLUCK**

1:00 PM • PMC Commons

| SUNDAY |

**RMES FOOD FAIR**

12 to 2:30 PM • RMES Gymnasium

| WEDNESDAY |

**HOUSE OF PRAYER**

7:00 PM • Youth Chapel

| FRIDAY |

**UNIVERSITY VESPERS**

7:30 PM • PMC Sanctuary

**PIONEER PULPIT**

| 11 • 15 |

**DWIGHT K. NELSON**

“Galaxy Three: From Flower Girl to Bride”

| 11 • 22 |

**DWIGHT K. NELSON**

“Galaxy Three: Intergalactic Rescue”

**PMC Family Vespers**

TODAY • 6:30 PM

YOUTH CHAPEL

Join us this evening as we close the Sabbath together in the Youth Chapel.

**Multicultural Food Fair**

TOMORROW • 12:00 - 2:30 PM

RMES GYMNASIUM

Students, faculty, and volunteers will be selling delicious foods with different tastes from around the world.

**Adventist Retirees  
of Michiana**

TOMORROW • 1:00 PM

VILLAGE CHURCH

Bring a dish to feed 10-12 and enjoy another potluck. Our guest speaker is Robert C Myers, curator of the History Center, Courthouse Square. His presentation includes recent research on the Titanic. Questions? call Mike and Shirley Gammon (989.565.0027), or Rhoda Wills (471.7466).

**2nd Annual Apple  
Pie Fundraiser**

Pathfinders are selling apple pies again this year. If you would like to order some pies please email [evergreenfundraisers@gmail.com](mailto:evergreenfundraisers@gmail.com) or call 269.340.0366 and leave a message.

## **AFM-ISIS Refugee Fund**

Please send donations for the AFM-ISIS Refugee Fund directly to Adventist Frontier Missions (AFM). Pioneer Memorial Church is not able to receipt contributions made to AFM because AFM is not a PMC ministry. Send your contribution to Adventist Frontier Missions, PO Box 286, Berrien Springs MI 49103 or donate through their website [www.afmonline.org](http://www.afmonline.org). Sending your donations directly to AFM will ensure faster processing of your donation.

## **Thanksgiving Food Drive**

The PMC Evergreen Pathfinders are gearing up for our annual Thanksgiving Food Drive. As we plan for this event, we want to let you know, so you can plan to add a little to your shopping if you choose to participate. Pathfinders will be passing out bags to the community on November 8, and then picking up filled bags the afternoon of November 16. Food collected will be used in preparing Thanksgiving boxes on November 22. You will also have an opportunity to bring food donations to church as part of the Thanksgiving service on Sabbath, November 22. We will also need help distributing the Thanksgiving boxes on the afternoon of November 22. Watch for future announcements for details.

## **Knitting Hearts Together**

NOVEMBER 11 • 7:00 TO 8:30 PM  
MACCARTY HOME

The Knitting Hearts Together (shawl ministry) group will meet again on Tuesday. Contact Alice Williams ([alicew@andrews.edu](mailto:alicew@andrews.edu) or 471.3373) or Lyn MacCarty (471.9060 or 208.3377) for more info.

## **Free Health and Fitness Lifestyle Seminar**

NOVEMBER 11 • 7:00 TO 8:15 PM  
NEIGHBOR TO NEIGHBOR

You are invited to join Wes Youngberg by video in this series relating to optimal health & family wellness on *Nutrition: Your Fate Is on Your Plate*. We will meet in the conference room (in the front of the building).

## **Youth Church & Sabbath School**

NOVEMBER 15 • 10:20 AM  
PMC YOUTH CHAPEL

Please join us next Sabbath for a special Youth Church and Sabbath School. We will begin with breakfast and move into the program by 10:45 AM.

## **Reception for Rowena**

NOVEMBER 15 • 4:00 TO 6:00 PM  
CHAN SHUN HALL, WHIRLPOOL RM

Please plan to join us for a reception in honor of Rowena Fatcher. After living in our community for many years, Rowena will be moving to Texas to be near her daughter, Beverly. Thank you for planning to stop by to wish Rowena blessings in her new home.

## **A Revelation of Worship**

NOVEMBER 15 • 5:00 PM  
THE SEMINARY CHAPEL

A musical and dramatic reenactment of Revelation 4-5 directed by Chloe Lewis and sponsored by Dr. Paul B. Petersen, AU Religion Dept.

## **Walking in Johnson Gym**

Enjoy free walking in the Johnson gym Monday through Friday from 7:30 to 9:00 AM for all age groups.

**Charles & Julie Reid Concert**

NOVEMBER 15 • 7:00 PM

HOWARD PERFORMING ARTS CENTER

Love is a most notorious subject matter for poets and musicians. Join Charles Reid, Director of Vocal Studies at AU, as he shares a fun evening with the love of his life, Julie Reid. Come journey with them as they explore the wonderful complexities of love. Recognized as one of his generation's leading lyric tenors, Charles has sung on many of the world's most famous stages, including nine seasons with New York's Metropolitan Opera, San Francisco Opera, Theater an der Wien, Frankfurt Opera, Deutsche Oper am Rhein, and the festivals of Bayreuth, Salzburg, Spoleto USA, Glimmerglass, and Central City. A graduate of Westminster Choir College, mezzo-soprano Julie has concertized around the world with her husband. Since moving to Berrien Springs, she has become a regular in the concert scene of Southwest Michigan. Call the box office at 888.467.6442 for tickets and more information.

**A Holiday Gift Market**

NOVEMBER 16

CHAN SHUN HALL

We are seeking hand-crafters and local artists to be vendors for a gift market. For more info or to register, contact Rebecca Turk at [unendingwonder@gmail.com](mailto:unendingwonder@gmail.com).

**Scrapbooking Together**

NOVEMBER 16 • 1:30 TO 7 PM

Join us as we create cards and scrapbook pages. Bring your projects and come for the whole time or just an hour. Bring your favorite snack. We provide chocolate and prizes. Questions, call Sherrie at 471.3134.

**Nominating Committee**

SECOND READING

**Director, Traffic Ministry:**

Ross Pfeifle

**Host/Hostess for Sanctuary Doors:**

Jean Patterson

Rhoda Wills

Joshua Schmeling

Rushani Abbadasari

**Welcome Center Host/Hostess:**

Megan Channer

**Family Life Committee:**

Zelda Felix-Mottley

**Finance Committee:**

Tari Popp

Lauren Bitterman

Robert Moon IV

**Sabbath School Materials****Distribution & Offering Assistant:**

Deb Montcalm

**Stewardship Committee:**

Tiago Arrais

Dana Connell

**Deacons & Deaconesses—****Facilities & Offering****Baptism, Coordinator:**

Alice Williams

**Baptism, Assistants:**

Deb Montcalm

Anita Jones

Marcia Kilsby

**Landmarks of Prophecy**

Doug Bachelor is presenting a series called *Landmarks of Prophecy*, now through November 22, which will be broadcast live from Albuquerque, New Mexico. Visit [www.landmarksofprophecy.com](http://www.landmarksofprophecy.com) to watch live at 7:00 PM (Mountain Time) and for free online resources. His presentations will bring insights to big prophetic events that lay just ahead, and also practical tools to help you thrive here and now.



## **PMC Running Club**

SUNDAYS • 8:30 AM  
PMC PARKING LOT

Join Ryan & Christine Wallace on Sunday mornings for a run on Andrews University's trails. E-mail [boeck@andrews.edu](mailto:boeck@andrews.edu) for more information.

## **PMC Walking Club**

SUNDAYS • 8:30 AM  
PMC PARKING LOT

Join Clyde & Melissa Morgan on Sunday mornings for a walk around the AU campus. E-mail [morganclyde@gmail.com](mailto:morganclyde@gmail.com) for more information.

## **Exercise Class**

MONDAYS & THURSDAYS • 6:00 PM  
PMC COMMONS

Join us to improve your strength, flexibility, and balance.

## **Mommy & Me**

Mommy and Me is a play group for children ages 0-5 and their moms (or other female guardians). We meet in the Nursery Sabbath school room at 10 AM on Tuesdays. We do NOT meet on the second Tuesday of each month. If you have any questions e-mail [mommyandme@pmchurch.org](mailto:mommyandme@pmchurch.org).

## **Adopt A Family for Christmas**

It is time again to pay special attention to our families who may need help with meeting the needs (and some pleasures) of their children at Christmas time. You have been so generous in the past. Please choose to get involved and bring cheer and gladness again this Christmas. To choose a family, or to gather more info, call Katherine Smith at 269.471.1502.

## **Box Tops for Education**

Want to get "Free Money" for our schools? Look for box tops on Progresso soups, Pillsbury products, Old El Paso products, Ziploc products, Green Giant frozen foods, Cottonelle, Kleenex, Nature Valley Granola, kid-oriented Yoplait products and more. Our schools get a dime for every box top that we turn in. No need to clip them out perfectly, they can just be ripped off the boxes and sent with your child to school. Don't have a child in school? No worries, bring them to the church collection box at the front desk. The box tops turned in to the church will be divided equally among Ruth Murdoch and Andrews Academy.

## **God's Hands 4 Kids**

'Tis the season to give and show love. A foster child may never have experienced the love, joy, or traditions that make Christmas a childhood delight. Want to make a difference in a life? Here are some ways you can do that—donate stockings and or stocking stuffers or fill a stocking(s), indicate age and gender planned for (don't forget teens) and place in top of stocking. Put in the donation bins in the PMC lower lobby or office reception area or in the nursery through three-year-old Sabbath School rooms by December 6. If you would like information on buying presents for a specific foster child email [godshands4kids@gmail.com](mailto:godshands4kids@gmail.com). Sponsored by God's Hands 4 Kids.

## **Pathfinders to the Rescue**

Leaves? Walnuts? Dirty garage? Need help? PMC Evergreen Pathfinders to the rescue! We would be glad to make your life easier with these fall tasks. Please call or text Sarah Burt at 269.861.4770 to set up a time for this service.

## | TRANSFERS IN |

BEAGLES, Kathleen  
 BRANDT, Maria  
 CORDIS, Rachel  
 COUNCELL, Gary  
 COUNCELL, Joyce  
 DOS SANTOS, Wendy J.  
 EVERETT, Regina  
 GITTENS, Dionne  
 RAZMADZE, Marina  
 SAHLY, Cameron  
 SAHLY, Melanie  
 SAHLY, Quentin  
 SOARES, Ademir  
 SOARES, Hebe Abby  
 WINTERS, Sandra

## | TRANSFERS OUT |

BENSON, Douglas  
 CHUUMPU, Chipo  
 CHUUMPU, Keith  
 CHUUMPU, Lister  
 FLORES, Hector D. Jr  
 LEWIS, Chloe  
 LIZARDO, Andres  
 LUYEHO, Elisha  
 MCDONOUGH, Catherine  
 MOSIMBWA, Charles  
 NGONDA, Enala  
 NGONDA, Linda  
 NGONDA, Lubasi  
 NGONDA, Lubasi Jr  
 SHERWIN, Birgit  
 WITHERS, Joshua  
 WITHERS, Sara

## | FROM |

Village • Berrien Springs, MI  
 Keene, TX  
 Pacific Union College • Angwin, CA  
 NAD Military • Silver Spring, MD  
 NAD Military • Silver Spring, MD  
 Village • Berrien Springs, MI  
 Kalamazoo, MI  
 Macedonia • Hempstead, NY  
 Tbilisi, Georgia  
 M.V. Hill • Mount Vernon, OH  
 M.V. Hill • Mount Vernon, OH  
 M.V. Hill • Mount Vernon, OH  
 Hinsdale, IL  
 Hinsdale, IL  
 Camelback • Phoenix, AZ

## | TO |

Village • Berrien Springs, MI  
 Brentwood Dr • Lusaka, Zambia  
 Brentwood Dr • Lusaka, Zambia  
 Brentwood Dr • Lusaka, Zambia  
 Minnetonka, MN  
 Glenwood • Dowagiac, MI  
 Hispanic • Mishawaka, IN  
 Northbrook, IL  
 Minnetonka, MN  
 Jackson, MI  
 Forest Lake • Apopka, FL  
 Forest Lake • Apopka, FL  
 Forest Lake • Apopka, FL  
 Forest Lake • Apopka, FL  
 University • Loma Linda, CA  
 Beaverton, OR  
 Beaverton, OR



## SOUP KITCHEN: A TESTIMONY

BY DANIEL J. DRAZEN

It is not the easiest thing to write a testimony article about working at the Benton Harbor Soup Kitchen.

It isn't that nothing happens there. On the contrary, we have more opportunity than we know how to handle. Where we once saw an average of 80 to 90 meals served, that number has crept upward to an average of 110 to 120 meals. We do our best to meet that need, sometimes pulling together leftovers from other groups when we run out of our own dishes.

---

**WE SERVE THE PEOPLE WHO COME AND SOME OF THEM HAVE BECOME FAMILIAR FACES, BUT WE DON'T KNOW WHAT BROUGHT THEM TO THE SOUP KITCHEN IN THE FIRST PLACE...**

---

No, the hard part is our inability to see clearly what is going on there. We

can express it mathematically, breaking down the total into children and adult portions served; but that doesn't give us the whole picture.

That is not really a problem; after all, we were warned it would be that way. In the parable of the sheep and goats in Matthew 25, it is interesting to note that neither the saved nor the lost ever knew when it was that they did (or didn't) render service to Jesus as they were dealing with the people around them. We serve the people who come and some of them have become familiar faces, but we don't know what brought them to the Soup Kitchen in the first place, nor do we know what happens to them when they leave and we clean up the kitchen for the next group of volunteers. But God knows, and that should be sufficient. ■

FOR MORE INFORMATION:  
Daniel Drazen  
[drazen@andrews.edu](mailto:drazen@andrews.edu)

| PASTORS | | MINISTERS |

**Chaplain / Pioneer** • José Bourget  
bourget@pmchurch.org  
471.6254

**Media Ministries** • Nick Wolfer  
wolfer@pmchurch.org  
471.3246

**Harbor of Hope** • Taurus Montgomery  
montgomery@pmchurch.org  
269.923.9274

**Music** • Kenneth Logan  
logan@pmchurch.org  
471.3231

**Lead Chaplain** • June Price  
madrigal@andrews.edu  
471.6282

| STAFF |

**Admin. Assistant** • Genaida Benson  
benson@pmchurch.org  
471.6565

**Lead Pastor** • Dwight K. Nelson  
nelson@pmchurch.org  
471.3134

**Admin. Assistant** • Lailane Legoh  
legoh@pmchurch.org  
471.3543

**Pastoral Care** • Don Dronen  
dronen@pmchurch.org  
471.3133

**Asst. Media Dir.** • Jonathan LaPointe  
lapointe@pmchurch.org  
471.3678

**Stewardship** • Sharon Terrell  
terrell@pmchurch.org  
471.6151

**Assistant Treasurer** • JoAnn Siagian  
siagian@pmchurch.org  
471.7656

**This Gen. Evangelism** • Rodlie Ortiz  
ortiz@pmchurch.org  
471.6154

**Clerk** • Jackie Bikichky  
bikichky@pmchurch.org  
471.3972

**Youth Ministries** • Micheal Goetz  
goetz@pmchurch.org  
471.6176

**Executive Assistant** • Sherrie Davis  
davis@pmchurch.org  
471.3134

**Graphic Designer** • Rachele Offenback  
bulletin@pmchurch.tv  
471.3647

**Maintenance** • Larry White  
white@pmchurch.org  
471.3649

| MINISTRIES | | SABBATH SCHOOL |

**Adventurers** • Daniel González  
 adventurers@pmchurch.org  
 423.432.0780

**Adult** • Judy Aitken  
 adultss@pmchurch.org  
 240.7997

**Deacons** • Milan Vajdic  
 deacons@pmchurch.org  
 471.0328

**Birth - Grade 1** • Claudia Davisson  
 bg1@pmchurch.org  
 269.208.7081

**Deaconesses** • Vida Giddings  
 deaconesses@pmchurch.org  
 473.2175

**Grade 2 - Earliteen** • Robert Barnhurst  
 g2teen@pmchurch.org  
 473.1613

**Elders** • Russell & Cynthia Burrill  
 elders@pmchurch.org  
 473.3738

| OUR SCHOOLS |

**GROW Groups**

growgroups@pmchurch.org

**Andrews Academy** • Robert Overstreet  
 overstrr@andrews.edu  
 471.3148

**Health** • Evelyn Kissinger  
 health@pmchurch.org  
 930.0505

**Andrews University**  
 enroll@andrews.edu  
 471.7771 or 800.253.2874

**Pathfinders** • Kaylene Chadwick  
 evergreenpathfinders@gmail.com  
 530.863.3797

**Ruth Murdoch / K-8** • David Waller  
 waller@andrews.edu  
 471.3225

**Public Address** • Joel Kitchen  
 audio@pmchurch.org



**PIONEER MEMORIAL CHURCH**

8655 UNIVERSITY BOULEVARD, BERRIEN SPRINGS, MI 49103

**OFFICE HOURS**

Monday – Thursday (8 to 5) • Friday (8 to 12)

**PHONE** – 269.471.3133

**FAX** – 269.471.6152

**LIVE STREAMING**

www.pmchurch.tv  
 Sabbath 11:45 AM

**ONLINE**

www.pmchurch.org  
 www.pmchurch.tv

**RADIO**

WAUS – 90.7 FM  
 Sabbath 11:30 AM

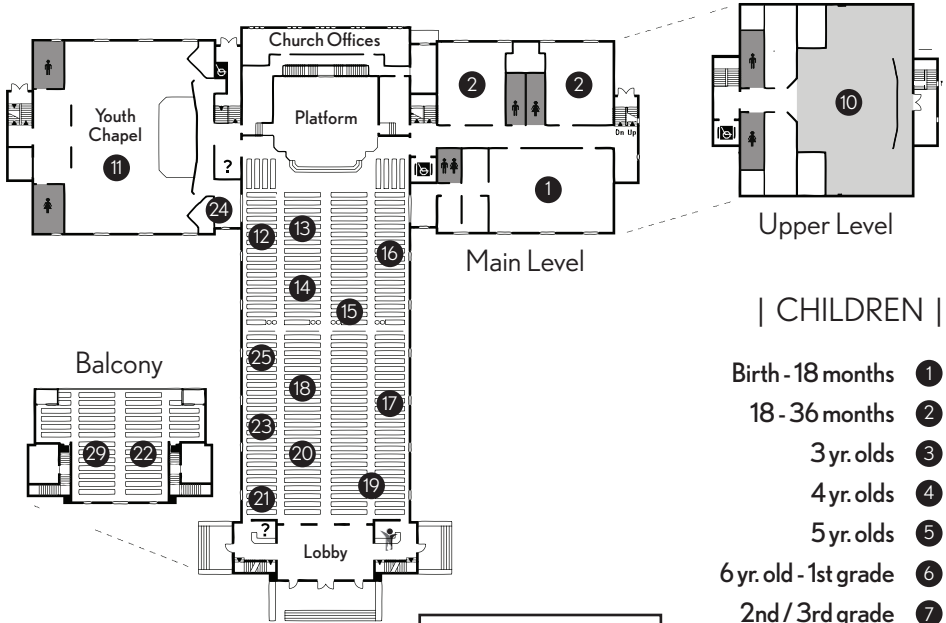

| CHILDREN |

- Birth - 18 months ①
- 18 - 36 months ②
- 3 yr. olds ③
- 4 yr. olds ④
- 5 yr. olds ⑤
- 6 yr. old - 1st grade ⑥
- 2nd / 3rd grade ⑦
- 4th grade ⑧
- 5th / 6th grade ⑨
- Earliteen ⑩
- Youth ⑪

| ADULT |

- ⑫ Group 1
- ⑬ Group 2 (Portuguese/Brazilian)
- ⑭ Group 3
- ⑮ Group 4 (Yugoslavian)
- ⑯ Group 5
- ⑰ Group 6
- ⑱ Group 7
- ⑲ Group 8
- ⑳ Group 9 (Spanish)
- ㉑ Group 10
- ㉒ Group 11 (Balcony)
- ㉓ Group 12 (French)
- ㉔ Conference Room
- ㉕ Indonesian Class
- ㉖ Something In Common
- ㉗ SDA Beliefs

| KEY |

- ? Welcome Centers
- ⬇ Elevators
- ♿ Restrooms
- 👤 Children's Activities & Lending Library

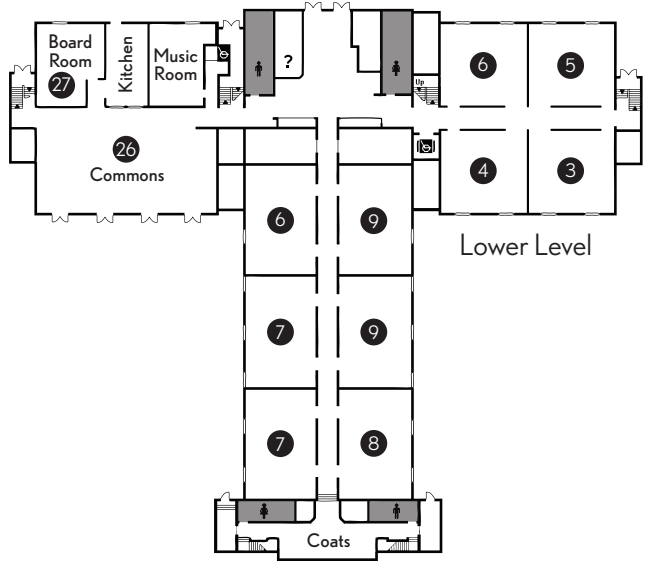

Lower Level

# Andrews University Campus Map

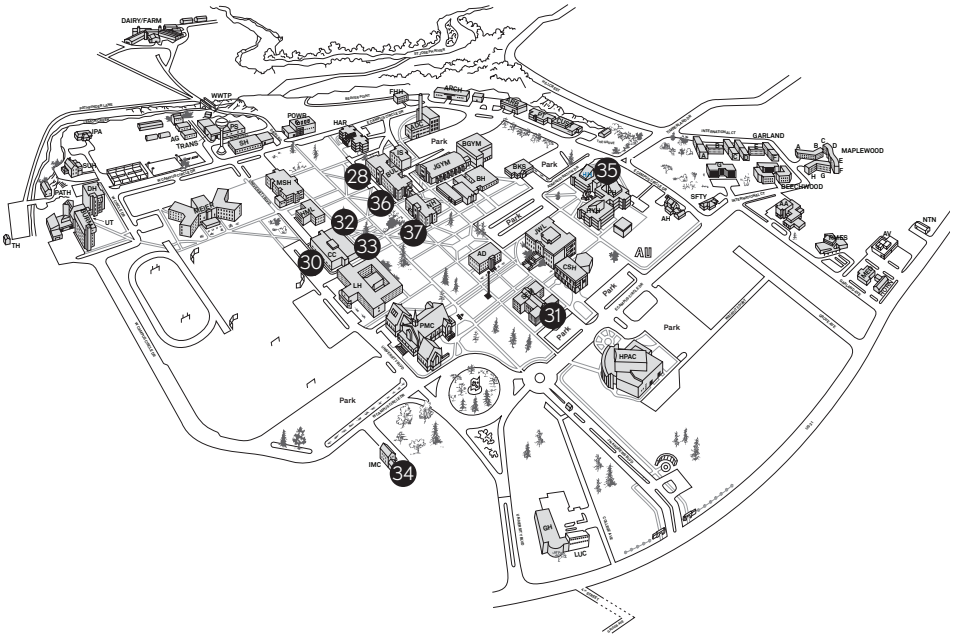

## | COLLEGIATE |

- 28 H&M (Hispanic - Religion Amphitheater)
- 29 People on the Move (PMC)
- 30 University Sabbath School (Dining Services)

## | SEMINARY |

- 31 N108 (Collegiate)
- N110
- N120 (New Life Church Choir)
- N150
- N211 (Small Group)
- N235
- N310 (Russian)
- N335 (Spanish)
- S340 (Upper Room)

## | ADULT @ AU |

- 32 Main Lounge
- 33 Faculty Lounge
- 34 Back to Basics
- 35 Living Word Fellowship
- 36 Current Events (Buller - 135)
- 37 Bible Journey (Nethery - 143)

RUTH MURDOCH  
ELEMENTARY SCHOOL



multicultural  
**FOOD  
FAIR**



**NOVEMBER 9  
NOON – 2:30 PM  
RMES GYM**

**Vibrant World Market  
Delicious International food  
Tickets available at the door**

Ruth Murdoch Elementary School  
8885 Garland Avenue  
Berrien Springs, MI 49104-0570